

SERIES PPA ATTENUATORS

High Power – DC-4 GHz

**RoHS
Compliant**



The Aeroflex/Inmet PPA Series of attenuators utilize a Beryllium Oxide chip and thin film technology to provide devices which can dissipate up to 100 Watts of RF power. The PPA series must be thermally bonded to a heat sink, using the mounting holes provided, in order to operate within the temperature rating indicated. The flange temperatures must not exceed 100°C under rated power conditions.

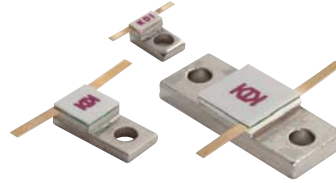

ORDERING INFORMATION

The Power Attenuators listed are available in 1 dB increments from 1 thru 20 dB. Specify by selecting any of the series listed and add the attenuation value desired to the basic series designation. (See Note 3)

EXAMPLE:



GENERAL SPECIFICATIONS

Impedance	50 Ohms
Operating Temp.	-55°C to +150°C
Attenuation Stability	0.0001 dB/dB/°C
Substrate	Beryllium Oxide Ceramic
Resistive Element	Proprietary Thin Film
Flange	Copper, Nickel Plated per QQ-N-290
Tabs	Beryllium Copper, Gold Plated per MIL-G-45204
Cover	Alumina Ceramic

PERFORMANCE SPECIFICATIONS

Model	Attenuation ⁽¹⁾ 1 dB Increments (dB)	Frequency ⁽¹⁾ Range	Input Power (Watts)	Attenuation Accuracy (1) (dB)			VSWR (Typical) ²	
				dB	DC-1 GHz	1-2.5 GHz		2.5-4 GHz
PPA 10 11-20	1-20	DC-4 GHz	10	1-10	±0.5 ±1.0	±0.5 ±2.0	±1.0 ±3.0	1.3:1
PPA 20 6-9 10-15 16-20	1-20	DC-4 GHz	20	1-5	±0.5 ±0.5 ±0.75 ±1.0	±0.5 ±0.5 ±1.0 ±2.0	±0.5 ±1.0 ±1.5 ±3.0	1.15:1 – DC-1.0 GHz 1.35:1 – 1.0-2.5 GHz 1.50:1 – 2.5-4.0 GHz
PPA 50	1-20	DC-1 GHz	50		±0.3 DC-500 MHz ±0.5 500 MHz-1 GHz		1.25:1 – DC-500 MHz 1.50:1 – 500 MHz-1 GHz	
PPA 100	1-20	DC-500 MHz	100		±0.5		1.25:1 – DC-200 MHz 1.50:1 – 200-500 MHz	

PHYSICAL DIMENSIONS

NOTES

- Custom products are available at higher frequencies with optimized VSWR and attenuation accuracy over narrow frequency bandwidths.
- VSWR as measured in a 0.125" ground plane stripline circuit.
- Standard values 1, 2, 3, 4, 5, 6, 10, 20 dB.
Non-std values available as special order.

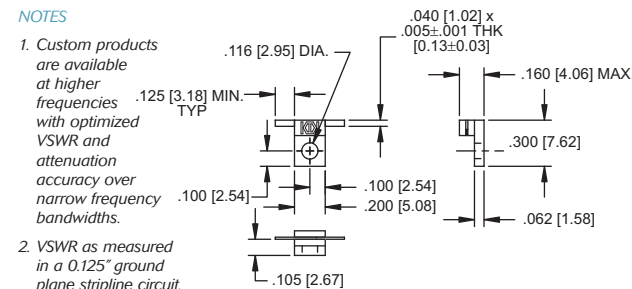

PPA10 OUTLINE

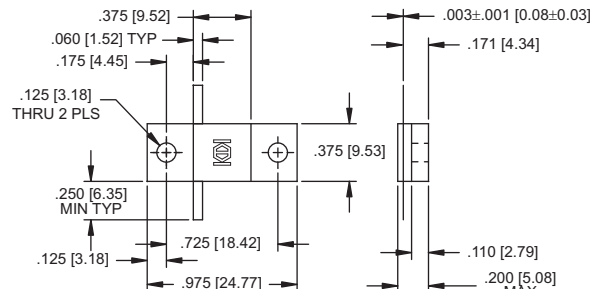

PPA50 OUTLINE

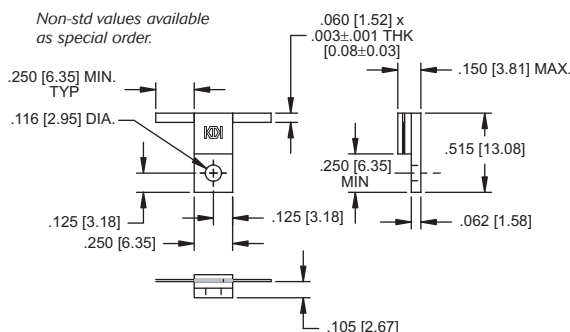

PPA20 OUTLINE

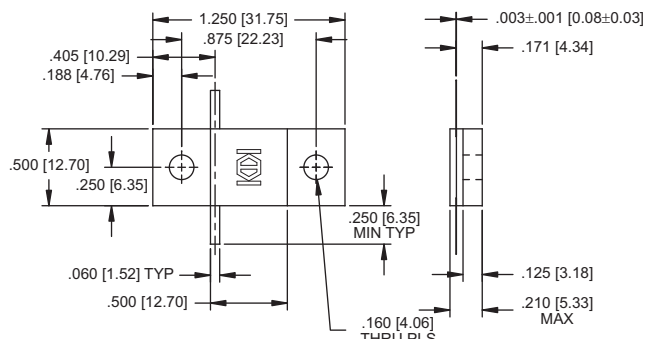

PPA100 OUTLINE

KEY: Inches [Millimeters] .XX ±.03 .XXX ±.010 LX ±0.8 .XX ±0.25]



300 Dino Drive, Ann Arbor, MI 48103
Tel: 888-244-6638 or 734-426-5553 • Fax: 734-426-5557
www.aeroflex.com/inmet • inmet-sales@eroflex.com

X-ON Electronics

Largest Supplier of Electrical and Electronic Components

Click to view similar products for [Attenuators](#) category:

Click to view products by [Aeroflex](#) manufacturer:

Other Similar products are found below :

[MAATCC0010](#) [HMC305SLP4ETR](#) [MAAD-009195-000100](#) [MAADSS0012TR](#) [TGL4201-02](#) [ATN3590-15](#) [20-50TPC](#) [D10AA5Z4](#)
[HMC346LP3TR](#) [18AH-01](#) [18AH-03](#) [18AH-08](#) [ATN3590-09](#) [20-50RP](#) [MASW-008322-000000](#) [MAAVSS0004](#) [PCAF-10](#) [EXB-](#)
[24AT9AR5X](#) [ATN3580-06](#) [HMC539ALP3ETR](#) [HMC291SETR](#) [HMC941A-SX](#) [HMC1119LP4METR](#) [F1977NBGI8](#) [HMC802ALP3ETR](#)
[HMC-VVD106-SX](#) [WA04P006XCTL](#) [SKY12408-321LF](#) [TGL2226](#) [WA04P005XBTL](#) [EXB-14AT3AR3X](#) [HMC-VVD104-SX](#) [SKY12236-](#)
[11](#) [MAATSS0018TR-3000](#) [HMC656-SX](#) [WA04P001XBTL](#) [MAAV-007941-TR3000](#) [WA04P004XBTL](#) [HMC425ALP3ETR](#)
[WA04P002XBTL](#) [MAT10010](#) [MAT10040](#) [EXB-24N182JX](#) [EXB-24N181JX](#) [EXB-24N183JX](#) [20-50TPR](#) [HMC941A](#) [PAT0816-C-0DB-T5](#)
[PAT0816-C-8DB-T5](#) [PAT0816-C-3DB-T5](#)