

N-Channel Enhancement Mode MOSFET

- **Features**

PNP Transistor

VCE	VBE	Vcesat max	Ic
-40v	-6v	-200mv	-3.0A

- **Applications**

- Li Battery Charging

- **Pin configuration**

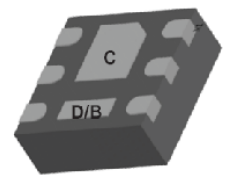
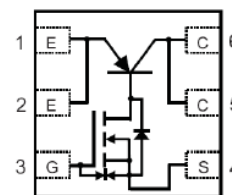

General Description

SSC8P22CN2 combines an N-Channel enhancement mode MOSFET and a Media Power PNP Transistor. The tiny and thin outline saves PCB consumption.

Pin configuration(Top view)

- **Package Information**

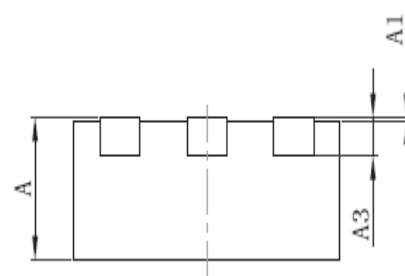
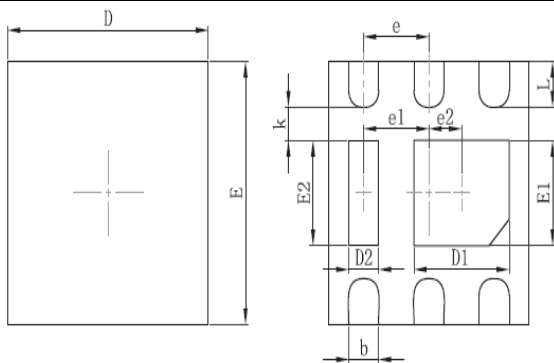

Symbol	Dimensions In Millimeters		
	Min.	Typ.	Max.
A	0.700		0.800
A1	0.000		0.050
A3	0.203 Ref.		
D	1.924	2.000	2.076
E	1.924	2.000	2.076
D1	0.850	0.950	1.050
E1	0.700	0.800	0.900
D2	0.200	0.300	0.400
E2	0.700	0.800	0.900
e1	0.650 Typ.		
e2	0.325 Typ.		
k	0.200 Min.		
b	0.250	0.300	0.350
e	0.650 Typ.		
L	0.300	0.350	0.400



SSC8P22CN2

● **Absolute Maximum Ratings @ TA = 25°C unless otherwise specified**

Parameter		Symbol	Ratings	Unit
Drain-Source Voltage		V_{DS}	20	V
Gate-Source Voltage		V_{GS}	± 12	
Drain Current (Note 1)	Continuous	I_D	0.3	A
	Pulsed	I_{DM}	0.8	
Collector-Emitter Voltage		V_{CEO}	-30	V
Emitter-Base Voltage		V_{EBO}	-6	V
Collector Current (Note 1)	Continuous	I_C	-3	A
	Pulsed	I_{CM}	-12	
Power Dissipation Derating above $T_A = 25^\circ\text{C}$ (Note 1)		P_d	1350	mW
Junction and Storage Temperature Range		T_J, T_{STG}	-55 to +150	$^\circ\text{C}$

Note1. Device mounted on FR-4 PCB, 1 inch x 0.85 inch x 0.062 inches. The rating is for each chip in the package.

● **Electrical Characteristics @ TA = 25°C unless otherwise specified**

Parameter (Note 2)	Symbol	Test Conditions	Min	Typ	Max	Unit
N-Channel mosfet						
Drain-Source Breakdown Voltage	$V_{(BR)DSS}$	$V_{GS} = 0\text{V}, I_D = 250\mu\text{A}$	20	--	--	V
Zero Gate Voltage Drain Current	I_{DSS}	$V_{DS} = 16\text{V}, V_{GS} = 0\text{V}$	--	--	1	μA
Gate-Body Leakage	I_{GSS}	$V_{GS} = \pm 12\text{V}, V_{DS} = 0\text{V}$	--	--	± 10	μA
Gate Threshold Voltage	$V_{GS(TH)}$	$V_{DS} = V_{GS}, I_D = 250\mu\text{A}$	0.35	0.6	1	V
Static Drain-Source On-Resistance	$R_{DS(ON)}$	$I_D = 0.5\text{A}, V_{GS} = 4.5\text{V}$	--	255	450	mR
		$I_D = 0.5\text{A}, V_{GS} = 2.5\text{V}$	--	390	765	
		$I_D = 0.35\text{A}, V_{GS} = 1.8\text{V}$	--	520	850	
Turn-On Delay Time	$t_{d(on)}$	$V_{DD} = -6\text{V}, R_L = 6\text{R}, I_D = -1\text{A},$ $V_{GEN} = -4.5\text{V}, R_G = 6\text{R}$	--	6	--	Ns
Turn-Off Delay Time	$t_{d(off)}$		--	28	--	
Input Capacitance	C_{ISS}	$V_{DS} = -16\text{V}, V_{GS} = 0\text{V},$ $f = 200\text{KHz}$	--	130	--	pF
Output Capacitance	C_{OSS}		--	20	--	
Reverse Transfer Capacitance	C_{RSS}		--	16	--	
Diode Forward Voltage ⁽¹⁾	V_{SD}	$V_{GS} = 0\text{V}, I_S = 150\text{mA}$	--	0.68	1.2	V
PNP Transistor						
Collector-Base Breakdown Voltage	BV_{CBO}	$I_C = -50\mu\text{A}, I_E = 0\text{mA}$	-40			V
Collector-Emitter Breakdown Voltage	BV_{CEO}	$I_C = -1\text{mA}, I_E = 0\text{mA}$	-40			V
Emitter-Base Breakdown Voltage	BV_{EBO}	$I_E = -50\mu\text{A}, I_C = 0\text{mA}$	-6			V
Collector cut off current	I_{CBO}	$V_{CB} = -30\text{V}, I_E = 0\text{mA}$			100	nA
Emitter cut off current	I_{EBO}	$V_{EB} = -5\text{V}, I_C = 0\text{mA}$			100	nA
DC Current Gain	HFE	$V_{CE} = -2\text{V}, I_C = -500\text{mA}$	100		350	
Collector-Emitter Saturation Voltage	V_{CESAT}	$I_C = -1.5\text{A}, I_B = -80\text{mA}$		0.15	-0.2	V

Note 2. Short duration test pulse used to minimize self-heating effect.

- Thermal resistance ratings

Parameter	Symbol	Value	Unit
Junction-to-Ambient Thermal Resistance ^a	R θ JA	105	°C/W
Junction-to-Ambient Thermal Resistance ^b	R θ JA	155	°C/W

- Typical Performance Characteristics

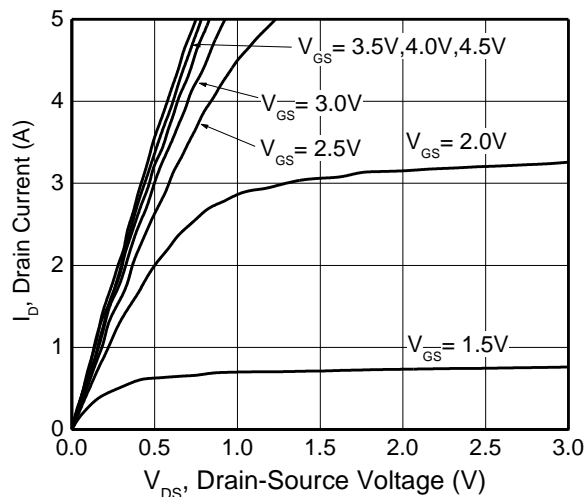

Figure 1. Output Characteristics

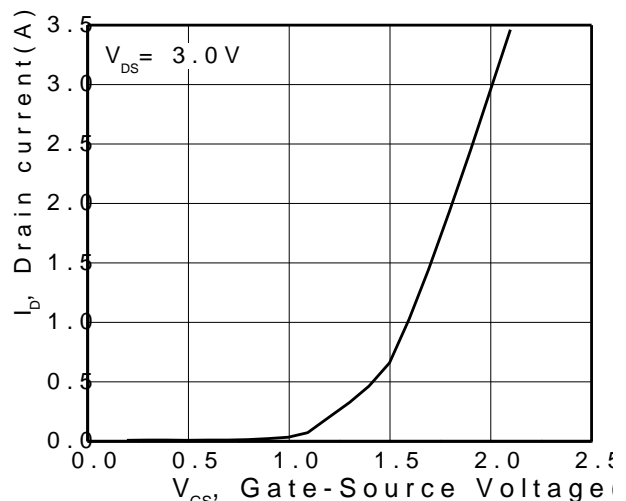

Figure 2. Transfer Characteristic

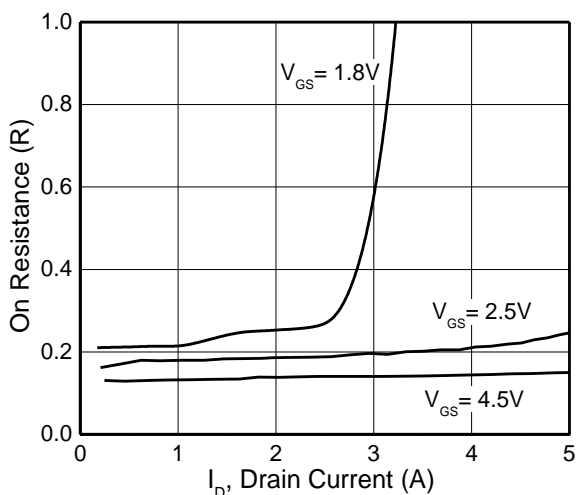

Figure 3. On Resistance vs. Drain Current

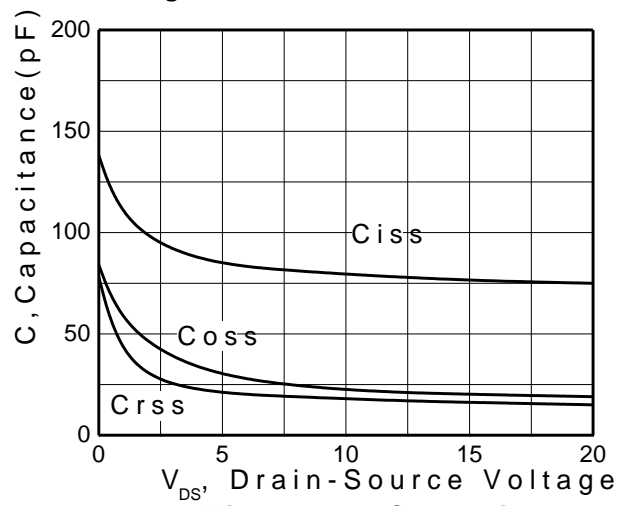

Figure 4. Capacitance

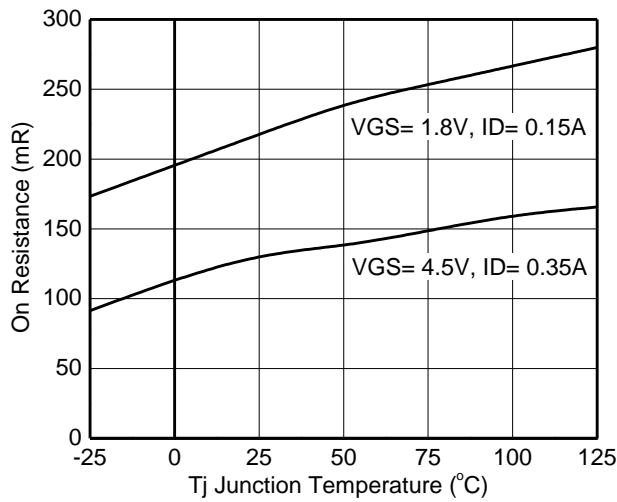

Figure 5 . On resistance vs. Temperature

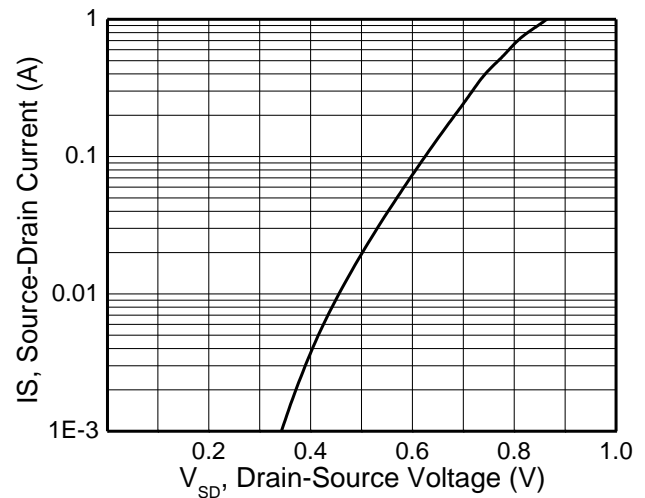

Figure 6. Diode Forward Characteristics

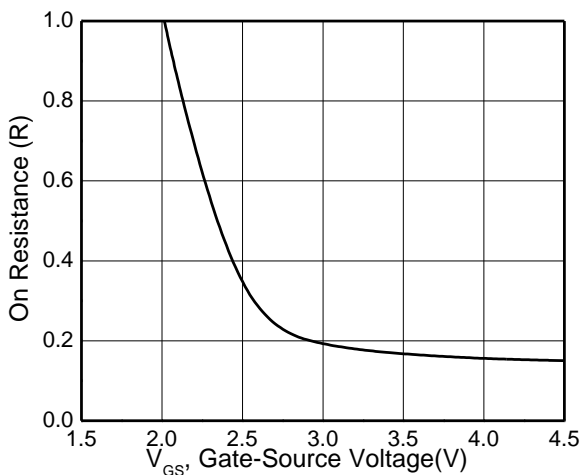

Figure 7. On Resistance vs. Gate-Source Voltage

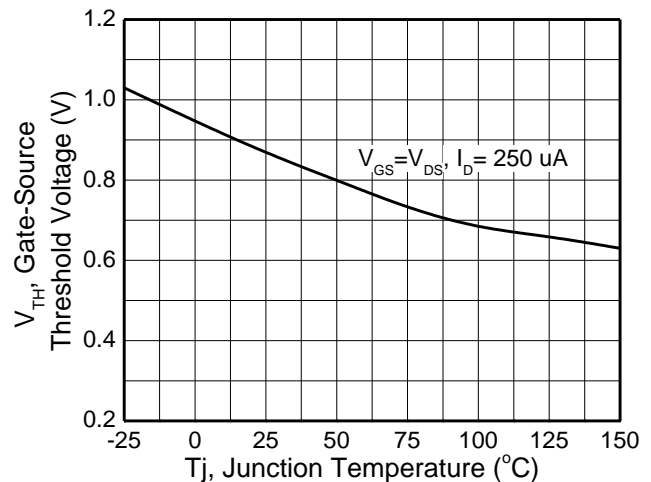
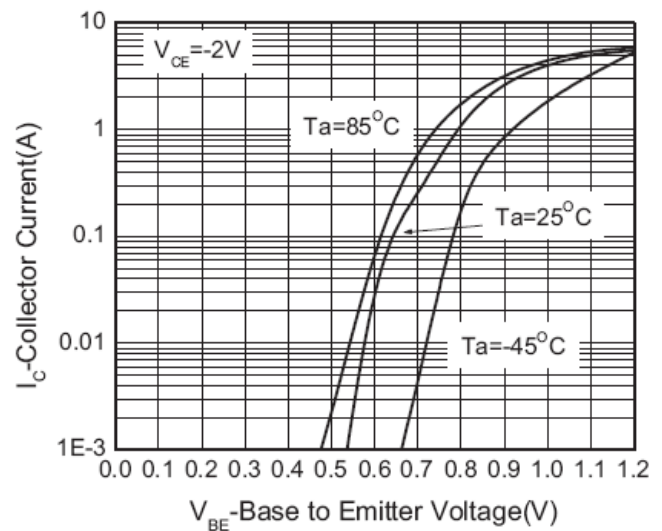
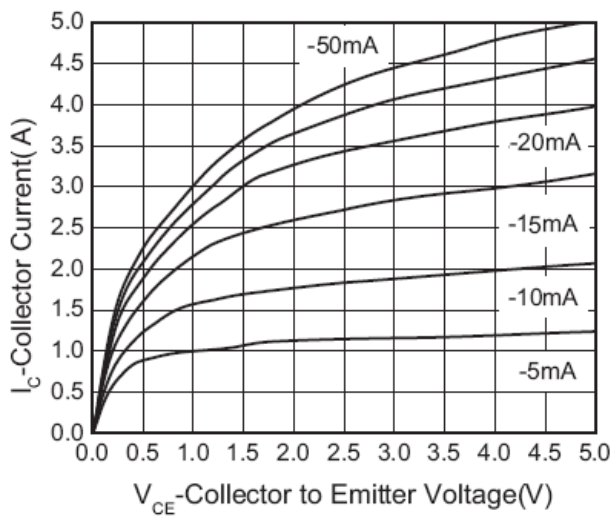
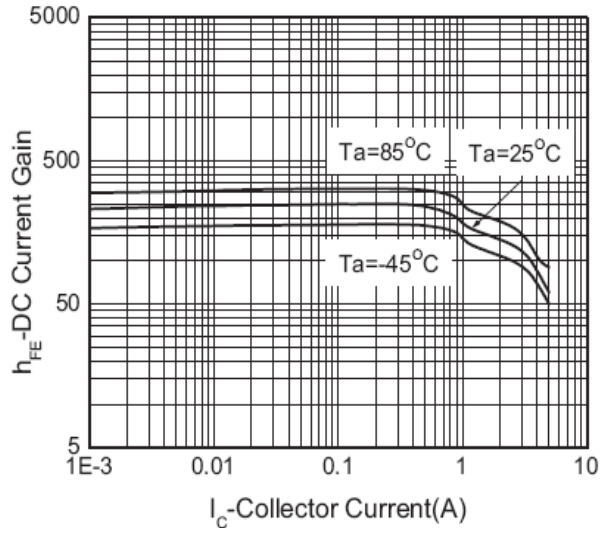

Figure 8. Gate Threshold vs. Temperature

PNP Transistor



Output characteristics



Transfer characteristics

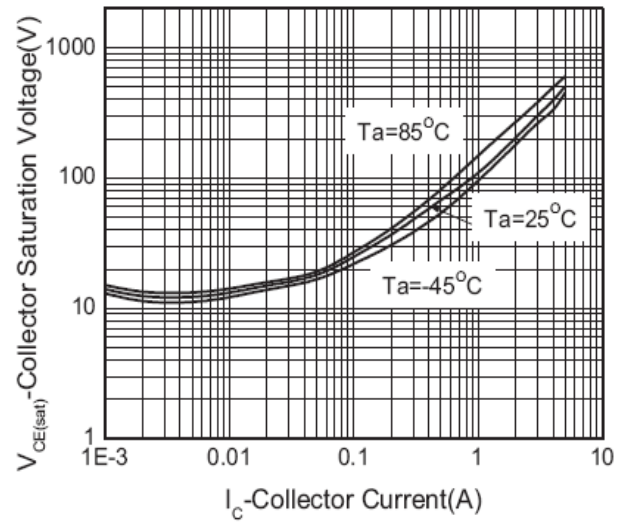



SSC8P22CN2

DISCLAIMER

AFSEMI RESERVES THE RIGHT TO MAKE CHANGES WITHOUT FURTHER NOTICE TO ANY PRODUCTS HEREIN TO IMPROVE RELIABILITY, FUNCTION OR DESIGN. AFSEMI DOES NOT ASSUME ANY LIABILITY ARISING OUT OF THE APPLICATION OR USE OF ANY PRODUCT OR CIRCUIT DESCRIBED HEREIN; NEITHER DOES IT CONVEY ANY LICENCE UNDER ITS PATENT RIGHTS, NOR THE RIGHTS OF OTHERS.

THE GRAPHS PROVIDED IN THIS DOCUMENT ARE STATISTICAL SUMMARIES BASED ON A LIMITED NUMBER OF SAMPLES AND ARE PROVIDED FOR INFORMATIONAL PURPOSE ONLY. THE PERFORMANCE CHARACTERISTICS LISTED IN THEM ARE NOT TESTED OR GUARANTEED. IN SOME GRAPHS, THE DATA PRESENTED MAY BE OUTSIDE THE SPECIFIED OPERATING RANGE (E.G., OUTSIDE SPECIFIED POWER SUPPLY RANGE) AND THEREFORE OUTSIDE THE WARRANTED RANGE.

X-ON Electronics

Largest Supplier of Electrical and Electronic Components

Click to view similar products for [Bipolar Transistors - BJT category](#):

Click to view products by [AF manufacturer](#):

Other Similar products are found below :

[619691C](#) [MCH4017-TL-H](#) [MMBT-2369-TR](#) [BC546/116](#) [BC557/116](#) [BSW67A](#) [NJVMJD148T4G](#) [NTE123AP-10](#) [NTE153MCP](#) [NTE16](#)
[NTE195A](#) [NTE92](#) [C4460](#) [2N4401-A](#) [2N6728](#) [2SA1419T-TD-H](#) [2SA2126-E](#) [2SB1204S-TL-E](#) [2SC2712S-GR,LF](#) [2SC4731T-AY](#)
[2SC5488A-TL-H](#) [2SD2150T100R](#) [SP000011176](#) [2N2907A](#) [2N3904-NS](#) [2N5769](#) [2SC2412KT146S](#) [2SD1816S-TL-E](#) [CPH6501-TL-E](#)
[MCH4021-TL-E](#) [MJE340](#) [US6T6TR](#) [NJL0281DG](#) [732314D](#) [CPH3121-TL-E](#) [CPH6021-TL-H](#) [SZT1010T1G](#) [873787E](#) [IMZ2AT108](#)
[UMX21NTR](#) [MCH6102-TL-E](#) [NJL0302DG](#) [2N3583](#) [30A02MH-TL-E](#) [NSV40301MZ4T1G](#) [NTE13](#) [NTE26](#) [NTE282](#) [NTE323](#) [NTE350](#)