

TO-92 Plastic-Encapsulate Transistors

D1616AGC929

NPN Transistors

Features

- Power dissipation

Marking: D1616AGC929

Maximum Ratings (T_a=25°C unless otherwise noted)

Symbol	Parameter	Value	Unit
V _{CB0}	Collector Base Voltage	120	V
V _{CEO}	Collector Emitter Voltage	60	V
V _{EBO}	Emitter Base Voltage	6	V
I _c	Collector Current	1	A
P _c	Collector Power Dissipation	750	mW
T _j	Junction Temperature	150	°C
T _{stg}	Storage Temperature	-55 ~ +150	°C
R _{θJA}	Thermal Resistance from Junction to Ambient	167	°C/W

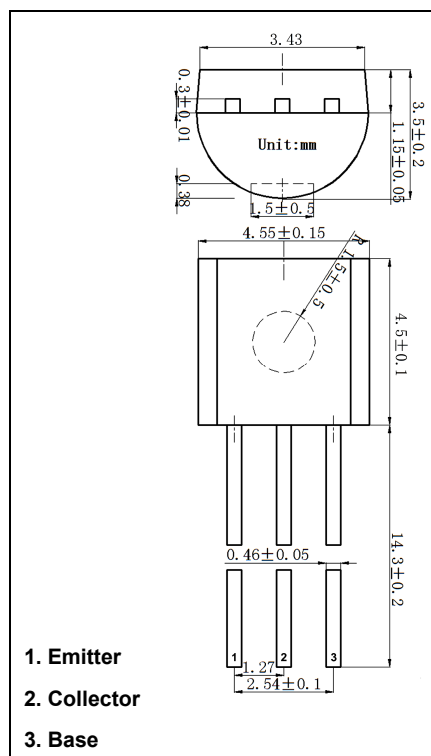

Electrical Characteristics (T_a=25°C unless otherwise specified)

Symbol	Parameter	Test Conditions	Min	Typ	Max	Unit
V _{(BR)CBO}	Collector-base breakdown voltage	I _c = 10μA, I _E = 0	120			V
V _{(BR)CEO}	Collector-emitter breakdown voltage	I _c = 2mA, I _B = 0	60			V
V _{(BR)EBO}	Emitter-base breakdown voltage	I _E = 10μA, I _C = 0	6			V
I _{CBO}	Collector cut-off current	V _{CB} = 60V, I _E = 0			100	nA
I _{EBO}	Emitter cut-off current	V _{EB} = 6V, I _C = 0			100	nA
h _{FE(1)}	DC current gain	V _{CE} = 2V, I _C = 100mA	135		600	
h _{FE(3)}		V _{CE} = 2V, I _C = 1A	81			
V _{CE(sat)}	Collector-emitter saturation voltage*	I _C = 1A, I _B = 50mA			0.3	V
V _{BE(sat)}	Base-emitter saturation voltage*	I _C = 1A, I _B = 50mA			1.2	V
V _{BE}	Base-emitter voltage*	V _{CE} = 2V, I _C = 50mA	0.6		0.7	V
f _T	Transition frequency	V _{CE} = 2V, I _C = 100mA	100			MHz
C _{ob}	Output capacitance	V _{CB} = 10V, I _E = 0, f = 1MHz			19	pF
t _{on}	Turn time	V _{CC} = 10V, I _C = 100mA, I _{B1} = -I _{B2} = 10mA		0.07		μs
t _s	Storage time			0.95		μs
t _f	Fall time			0.07		μs

*pulse test: PW≤350μS, δ≤2%.

Classification OF h_{FE(1)}

Rank	L	K	U
Range	135-270	200-400	300-600

Typical Characteristics

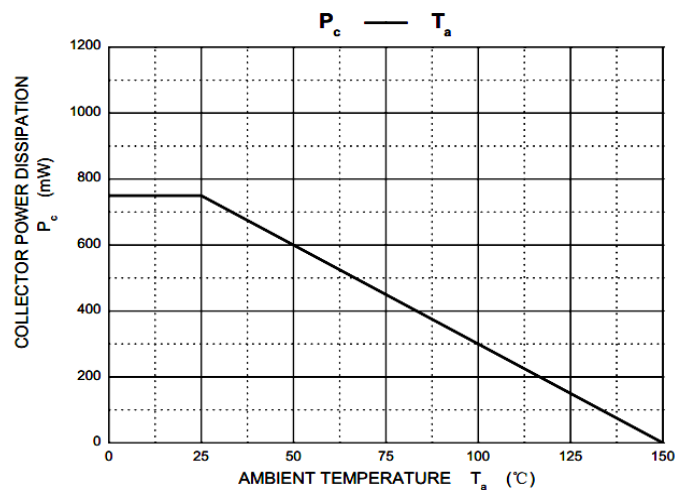
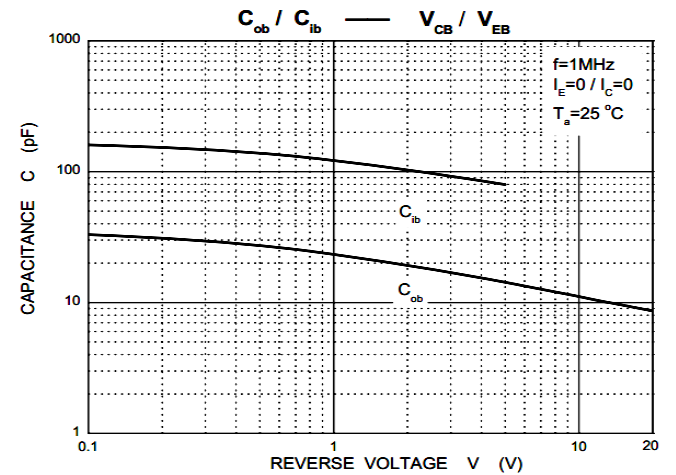
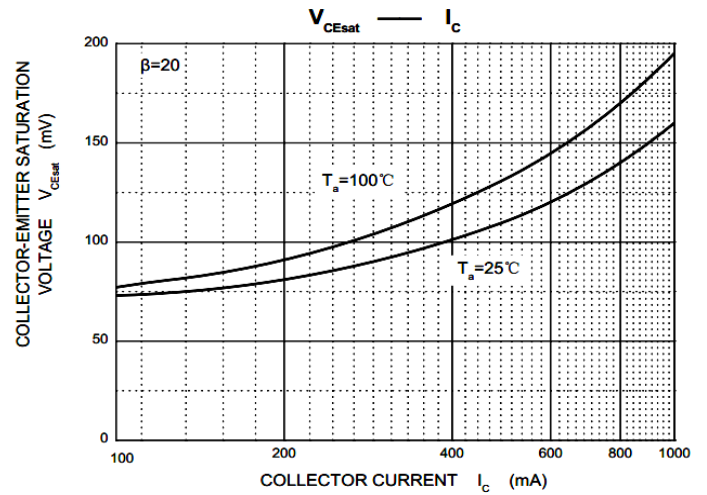
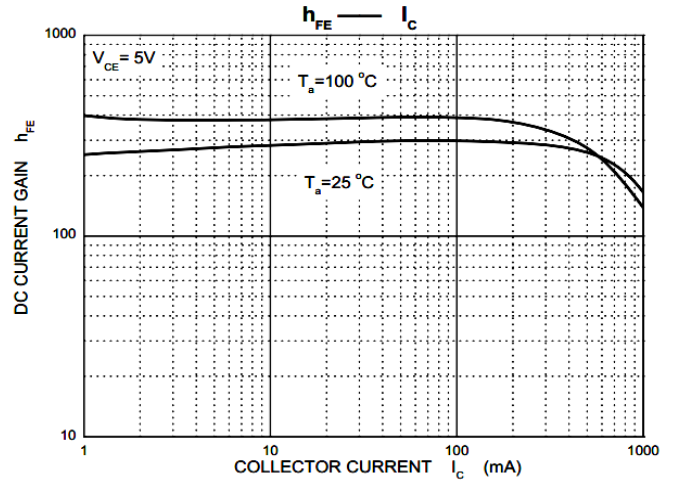
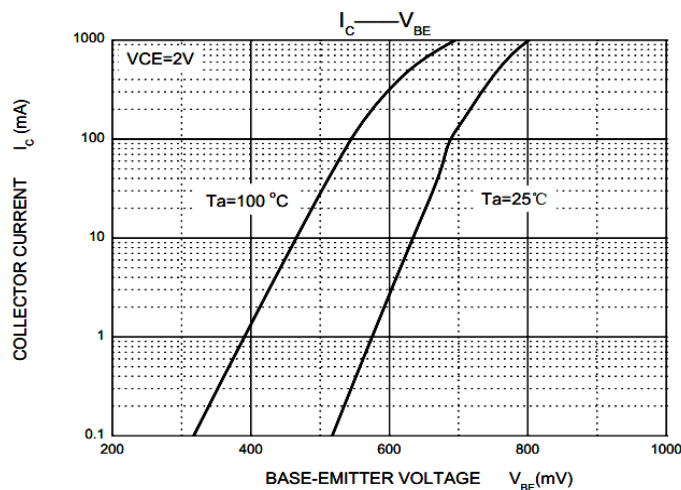
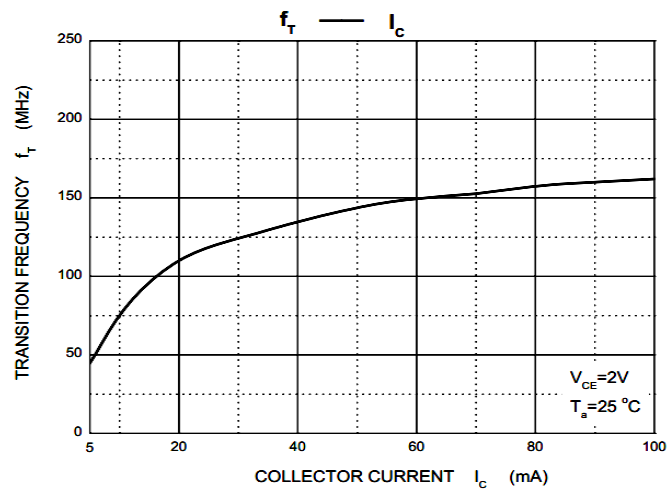
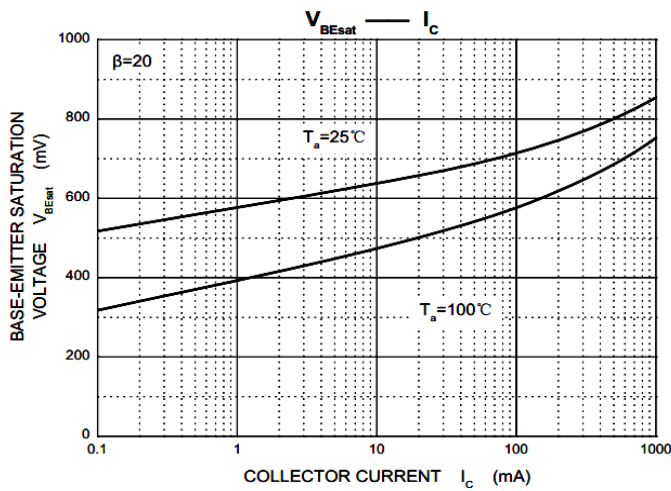
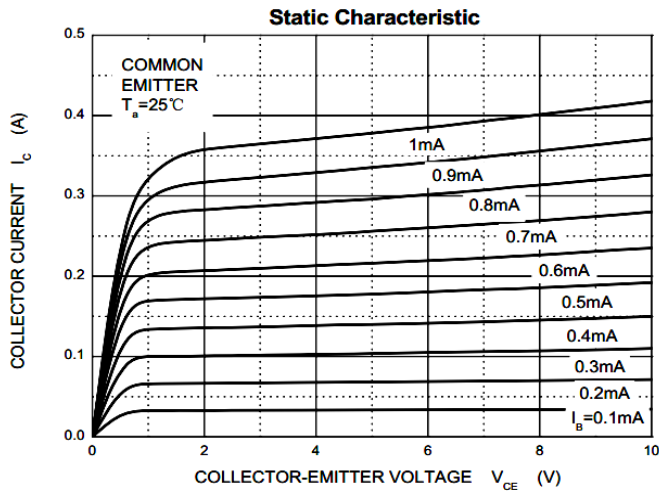

X-ON Electronics

Largest Supplier of Electrical and Electronic Components

Click to view similar products for [Bipolar Transistors - BJT category](#):

Click to view products by [ALJ manufacturer](#):

Other Similar products are found below :

[BC559C](#) [MCH4017-TL-H](#) [MMBT-2369-TR](#) [BC546/116](#) [NJVMJD148T4G](#) [NTE16](#) [NTE195A](#) [IMX9T110](#) [2N4401-A](#) [2N6728](#) [2SA1419T-TD-H](#) [2SB1204S-TL-E](#) [2SC5488A-TL-H](#) [FMC5AT148](#) [2N2369ADCSM](#) [2N2907A](#) [2N3904-NS](#) [2N5769](#) [2SC4618TLN](#) [CPH6501-TL-E](#) [BC856BW-13-F](#) [US6T6TR](#) [BAX18/A52R](#) [BC556/112](#) [IMZ2AT108](#) [MMST8098T146](#) [MCH6102-TL-E](#) [2N3879](#) [30A02MH-TL-E](#) [NTE13](#) [NTE282](#) [NTE323](#) [NTE350](#) [NTE81](#) [JANTX2N2920L](#) [JANSR2N2907AUB](#) [CMLT3946EG TR](#) [SNSS40600CF8T1G](#) [CMLT3906EG TR](#) [GRP-DATA-JANS2N2907AUB](#) [GRP-DATA-JANS2N2222AUA](#) [MMDT3946FL3-7](#) [2N4240](#) [JANS2N3019](#) [MSB30KH-13](#) [2N2221AUB](#) [2SD1815T-TL-E](#) [2N6678](#) [2N2907Ae4](#) [JAN2N3507](#)