

# Magnetic Sensors Switching Output Type

HGDE□/HGDF□ Series

Various product lineup contributes set design flexibility . High precision, compact and low profile product based on magnetic sensing devices technologies.

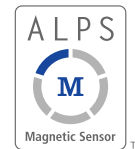
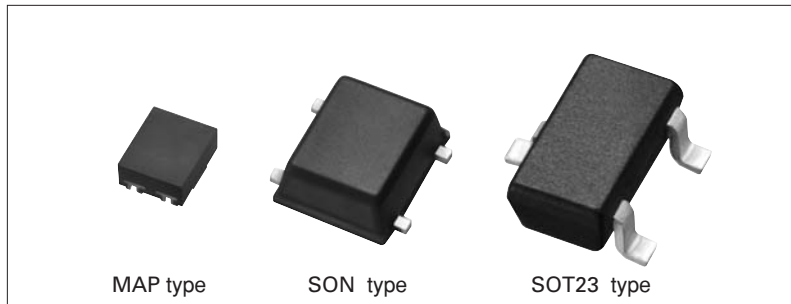

Magnetic Sensor

Piezo Sensor

Resistive Sensor

### Features

- Compact and low-profile (1.3×0.9×0.55mm for the MAP Type).
- Low current consumption (3.0μA at VDD=1.8V.).
- Various lineups (drive voltage, functions, operating magnetic field and package specifications).

### Applications

- Detects Open and Close of lids and doors of any industrial equipments and amusement equipments.

### Typical Specifications

Items	Specifications	
	HGDE□	HGDF□
Drive voltage	Typ. 1.8V (1.6V min. to 3.6V max.)	Typ. 5V (4.5V min. to 5.5V max.)
Current consumption	3μA Ave. (at VDD=1.8V)	Typ. 1.65mA (at VDD=5V)

### Product list

Drive voltage	Package specifications/Size	Function	Model No.	Operating magnetic field(Hon)	
Typ.1.8V	MAP type 1.3×0.9×0.55mm	Single polarity/ Single output	HGDESM022A	2.0mT	
			HGDESM032A	3.0mT	
		Dual polarity/ Single output	HGDEPM022A	2.0mT	
			HGDEPM032A	3.0mT	
		Dual polarity/ Dual output	HGDEDM022A	2.0mT	
			HGDEDM032A	3.0mT	
	SON type 2.1×2.1×0.75mm	Single polarity/ Single output	HGDESN021A	2.0mT	
			HGDESN031A	3.0mT	
		Dual polarity/ Single output	HGDEPN021A	2.0mT	
			HGDEPN031A	3.0mT	
		Dual polarity/ Dual output	HGDEDN021A	2.0mT	
			HGDEDN031A	3.0mT	
SOT23 type 2.9×2.8×1.1mm	Single polarity/ Single output	HGDEST021A	2.0mT		
		HGDEST031A	3.0mT		
	Dual polarity/ Single output	HGDEPT021A	2.0mT		
		HGDEPT031A	3.0mT		
	Typ.5V	SON type 2.1×2.1×0.75mm	Single polarity/ Single output	HGDFSN021A	2.0mT
				HGDFSN031A	3.0mT
Dual polarity/ Single output			HGDFPN021A	2.0mT	
			HGDFPN031A	3.0mT	
Dual polarity/ Dual output		HGDFDN021A	2.0mT		
		HGDFDN031A	3.0mT		
SOT23 type 2.9×2.8×1.1mm	Single polarity/ Single output	HGDFST021A	2.0mT		
		HGDFST031A	3.0mT		
Dual polarity/ Single output	HGDFPT021A	2.0mT			
	HGDFPT031A	3.0mT			

Dimensions

Unit:mm

Magnetic  
Sensor

Piezo  
Sensor

Resistive  
Sensor

Style

MAP type

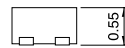
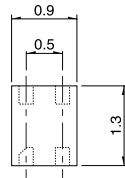

SON type

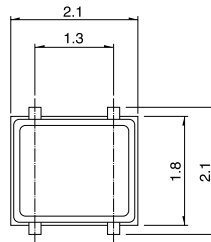

SOT23 type

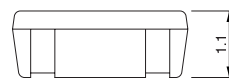
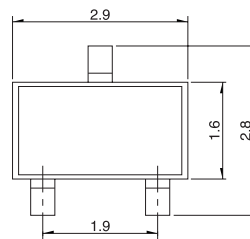

## X-ON Electronics

Largest Supplier of Electrical and Electronic Components

*Click to view similar products for [Board Mount Hall Effect/Magnetic Sensors](#) category:*

*Click to view products by [ALPS](#) manufacturer:*

Other Similar products are found below :

[HGPRDT005A](#) [AH1808-P-A](#) [AH277AZ4-AG1](#) [AV-10379](#) [AV-10448](#) [SS41C](#) [AH1894-Z-7](#) [ATS601LSGTN-HT-WU4-T](#) [ATS601LSGTN-LT-WU4-T](#) [TLE4917](#) [50017859-003](#) [TY-13101](#) [SS85CA](#) [AH277AZ4-BG1](#) [TLE49614MXTSA1](#) [AH3382-P-B](#) [AH3377-P-B](#) [AH9250-W-7](#) [AH211Z4-AG1](#) [AH3360-FT4-7](#) [SS460S-100SAMPLE](#) [50065820-03](#) [TLE4941PLUSCB](#) [AH374-P-A](#) [AH1806-P-A](#) [AH374-W-7](#) [SS460P-T2](#) [AH1912-FA-7](#) [SS413F](#) [TLE5046ICAKLRHALA1](#) [TLE49421CHAMA2](#) [TLE4941PLUSCXAMA1](#) [AH1912-W-EVM](#) [AH1903-FA-EVM](#) [AH3774-W-EVM](#) [AH49FNTR-EVM](#) [MMC5633NJL](#) [AH3360-FA-EVM](#) [AH8502-FDC-EVM](#) [AH3366Q-SA-EVM](#) [AH3774-P-EVM](#) [KTH1601SU-ST3](#) [MG910](#) [MG910M](#) [MG911](#) [MG610](#) [MW921](#) [MW922](#) [TLE4998S3XALA1](#) [TLE5011FUMA1](#)