

SRBQ

9-position Low-profile Vertical Type

Single-unit and dual-unit types suit a variety of controls

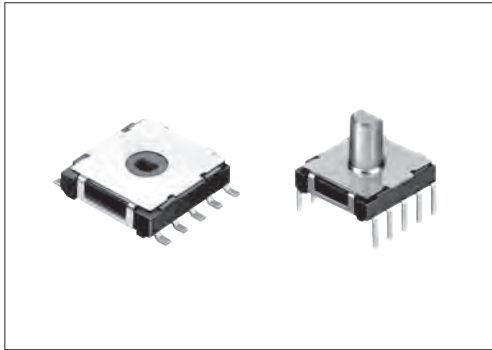

Typical Specifications

Items		Specifications
Rating (max.)/(min.) (Resistive load)		0.1A 16V DC / 50μA 3V DC
Contact resistance (Initial / After operating life)		50mΩ max. / 100mΩ max.
Rotational torque		6±3mN·m / 13±5mN·m
Total rotational angle	Without load	10,000 cycles
	With load	10,000 cycles (0.1A 16V DC)

Product Line

Poles	Positions	Changeover angle	Changeover timing	Rotational torque	Actuator configuration	Soldering	Actuator length (mm)	Minimum order unit (pcs.)		Product No.	Drawing No.
								Japan	Export		
1	9	40±3°	Non shorting	6±3mN·m	Flat	Insertion	5.8	1,215	4,860	SRBQ090200	1
				13±5mN·m						SRBQ490100	2
				6±3mN·m	Non shaft	Reflow	—	1,200	4,800	SRBQ290301	3

Packing Specifications

Taping

Series	Number of packages (pcs.)			Tape width (mm)	Export package measurements (mm)
	1 reel	1 case /Japan	1 case /export packing		
SRBQ290301	1,200	2,400	4,800	24	406×406×190

Tray

Series	Number of packages (pcs.)		Export package measurements (mm)
	1 case /Japan	1 case /export packing	
SRBQ090200 SRBQ490100	1,215	4,860	540×360×290

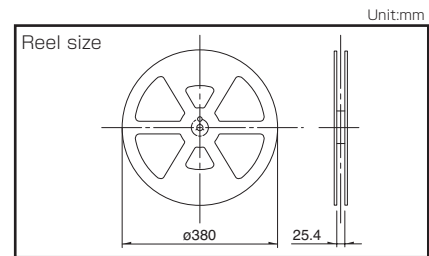

Detector

Slide

Push

Rotary

Power

Dual-in-line
Package type

SRBQ

9-position Low-profile Vertical Type

Detector

Slide

Push

Rotary

Power

Dual-in-line
Package Type

■ Dimensions

Insertion Type

Unit:mm

No.	Style	PC board mounting hole dimensions (Viewed from direction A)
1	Standard torque 	
2	Heavy torque 	

Reflow Type

Unit:mm

No.	Style	PC board mounting hole and land dimensions (Viewed from direction A)
3		



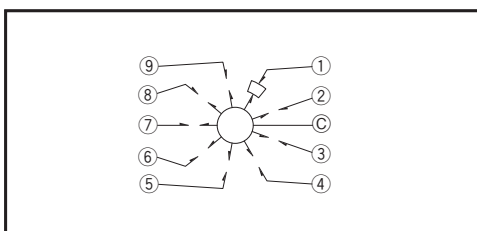







■ Circuit Diagram (Viewed from Direction A)



Rotary Switches

List of Varieties

- Detector
- Slide
- Push
- Rotary
- Power
- Push-line Package Type

Series		SRBD	SRBQ		SRBM		SRBV	SRRM	
			Insertion	Reflow type	Rotary	Pulse			
Photo									
Angle of throw		36°	40±3°		30±3°	18±3°	30±3°		
Number of poles		1		1, 2		1	1, 2, 3, 4		
Rotational torque		13±5mN·m	6±3mN·m 13±5mN·m		40±20mN·m 15±7mN·m		30±15mN·m	80±30mN·m (Shorting) 70±30mN·m (Non shorting)	
Dimensions (mm)	W	10	11.4		10		16.2		
	D		12.4		12.5		18.5		
	H		3.5		11		7.5		
Operating temperature range		-25°C to +85°C	-10°C to +60°C		-30°C to +85°C		-10°C to +85°C	-10°C to +60°C	
Automotive use		—	—		—		—	—	
Life cycle									
Rating (max.)/(min.) (Resistive load)		1mA 5V DC 50µA 3V DC	0.1A 16V DC 50µA 3V DC				0.3A 16V DC 50µA 3V DC	0.25A 30V DC 50µA 3V DC	
Durability	Operating life without load	10,000 cycles 250mΩ max.	10,000 cycles 100mΩ max.			30,000 cycles 100mΩ max.	10,000 cycles 100mΩ max.	10,000 cycles 40mΩ max.	
	Operating life with load Load: as rating	10,000 cycles 250mΩ max.	10,000 cycles 100mΩ max.		10,000 cycles 150mΩ max.		10,000 cycles 60mΩ max.		
Electrical performance	Initial contact resistance	200mΩ max.	50mΩ max.					20mΩ max.	
	Insulation resistance	100MΩ min. 100V DC						100MΩ min. 500V DC	
	Voltage proof	100V AC for 1minute						500V AC for 1minute	
Mechanical performance	Terminal strength	3N for 1minute	5N for 1minute				10N for 1minute		
	Actuator strength	Operating direction	—	—	0.5N·m	—	0.6N·m	1N·m	
		Pulling direction	50N	20N		100N			
	Wobble of actuator	Load at the tip of shaft SRRM, SRBM, SRBQ, SRBV: 1N The below table shows for SRRM, SRBM The below table shows for SRBQ The below table shows for SRBV							
Measuring position from mounting surface		Shaft wobble (max. value)	Applicable mounting dimension	Distance from mounting surface to the tip of shaft	Shaft wobble (max. value)	Measuring position from mounting surface	Shaft wobble (max. value)	Applicable mounting dimension	
10		0.17	15	below 5	0.5	10	0.2	15	
15		0.25	20	above 5 and below 10	0.9	15	0.3	20	
20		0.35	25	above 10 and below 15	1.2	20	0.4	25	
25	0.42	30	Unit:mm						
30	0.5	above 35							
Environmental performance	Cold	-40°C 500h	-20°C 96h		-40°C 96h		-20°C 96h		
	Dry heat	85°C 500h	85°C 96h						
	Damp heat	60°C, 90 to 95%RH 500h	40°C, 90 to 95%RH 96h						
Page		133	135		137		140	142	

Rotary Switches Soldering Conditions 145
 Rotary Switches Cautions 146

Rotary Switches / Soldering Conditions

Example of Reflow Soldering Condition

1. Heating method: Double heating method with infrared heater.
2. Temperature measurement: Thermocouple $\phi 0.1$ to 0.2 CA (K) or CC (T) at soldering portion (copper foil surface).
A heat resisting tape should be used for fixed measurement.
3. Temperature profile

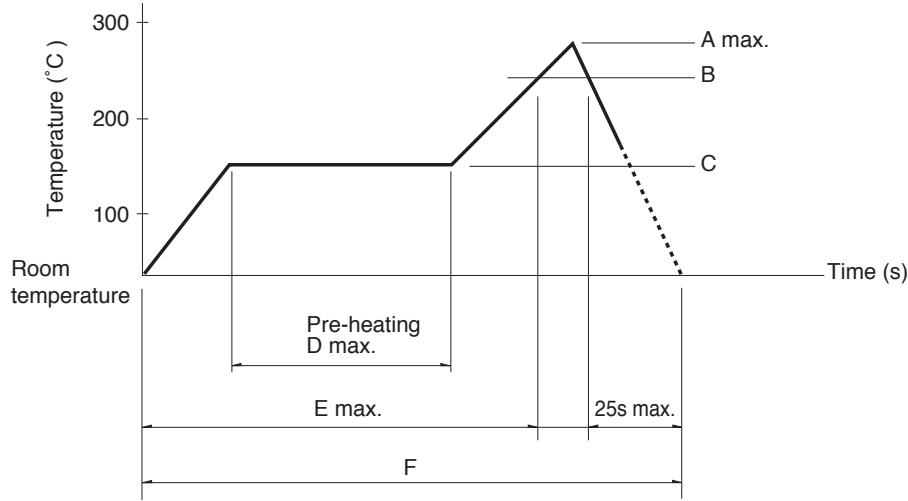

Series (Reflow type)	A (°C) 3s max.	B (°C)	C (°C)	D (s)	E (s)	F (s)
SRBQ	250	200	150±5	80 to 100	—	—

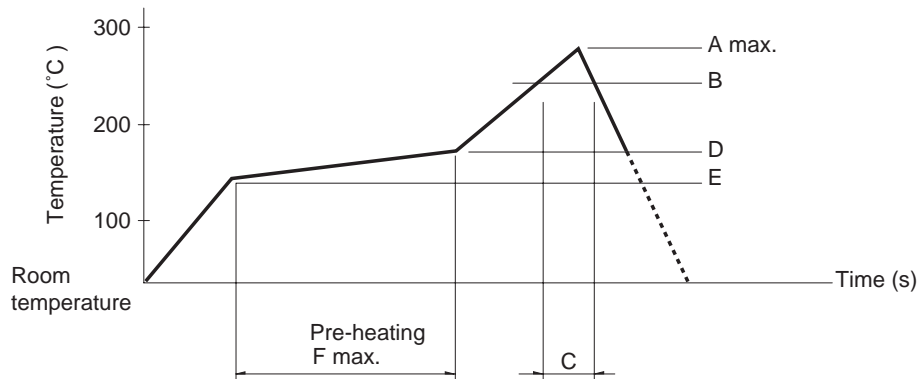

Series (Reflow type)	A (°C) 3s max.	B (°C)	C (s)	D (°C)	E (°C)	F (s)
SRBD	260	230	40	180	150	120

- Notes**
1. The condition mentioned above is the temperature on the mounting surface of a PC board. There are cases where the PC board's temperature greatly differs from that of the switch, depending on the PC board's material, size, thickness, etc. The above-stated conditions shall also apply to switch surface temperatures.
 2. Soldering conditions differ depending on reflow soldering machines. Prior verification of soldering condition is highly recommended.

Reference for Hand Soldering

Series	Soldering temperature	Soldering time
SRBQ, SRBM, SRBV, SRRM	350±10°C	3+1/0s
SRBQ (Reflow type)	350±5°C	3s max.

Reference for Dip Soldering

(For PC board terminal types)

Series	Items		Dip soldering	
	Preheating temperature	Preheating time	Soldering temperature	Duration of immersion
SRBM	100°C max.	60s max.	260±5°C	5s max.
SRBV, SRRM	—	—	260±5°C	10±1s
SRBQ	—	—	260±5°C	5±1s

X-ON Electronics

Largest Supplier of Electrical and Electronic Components

Click to view similar products for [Rotary Switches](#) category:

Click to view products by [ALPS](#) manufacturer:

Other Similar products are found below :

[57HS22-02-2-06N](#) [57M22-02B16N](#) [57M22-09A16N](#) [M3786/4-0881](#) [M3786/4-3267](#) [M3786/4-5568](#) [M3786/4-6029](#) [71ESF30-05204N](#)
[MC06L1NCGF](#) [84986-26](#) [9003K2C003GA](#) [PLR3251](#) [PLR3262](#) [PS3](#) [A0142M2SP](#) [A029303](#) [R2AA4455NNNN](#) [R2BB4455NNNN](#) [DR75-](#)
[AMSF-10R-B](#) [1703.3201](#) [HW1MS-0202-101](#) [24002-03S](#) [A029101](#) [ACSNO-129-YB-C1014](#) [ACSNO-134-RR-YB-C1005](#) [ACSNO-353-SB-](#)
[C3016](#) [1825537-4](#) [T505](#) [T505E](#) [24005-03N](#) [H10207RR01Q](#) [M3786/39-4ZC](#) [M3786/4-0002](#) [M3786/4-0630](#) [M3786/4-1028L](#) [M3786/4-](#)
[1233L](#) [M3786/4-3044](#) [M3786/4-3129](#) [M3786/4-5008L](#) [M3786/4-5256](#) [MC6CX1A502X009](#) [42HS36-01-1-06N](#) [42P36-03B10S](#) [44MBS60-](#)
[04-2-03N](#) [44MG90-02-1-02N](#) [50KMT90-01-2-02N](#) [51A22-01-1-16S](#) [51CDP30-01PAJN](#) [51KSP30-01D04N](#) [51P30-01B12N](#)