

## UR-Series - UL1077 Recognized Supplementary Protector - 1 pole C-Trip



One Pole



Standard Pack: 12

Weight:

0.3A - 32A

1.75kg (3.86 lb.)

40A - 63A

2.07kg (4.56 lb.)

| Rated Current | Type/ Cat. No. | Rated Voltage |
|---------------|----------------|---------------|
| 0.5A          | 1C05UR         | 277V AC       |
| 1.0A          | 1C1UR          | 277V AC       |
| 2.0A          | 1C2UR          | 277V AC       |
| 3.0A          | 1C3UR          | 277V AC       |
| 4.0A          | 1C4UR          | 277V AC       |
| 5.0A          | 1C5UR          | 277V AC       |
| 6.0A          | 1C6UR          | 277V AC       |
| 8.0A          | 1C8UR          | 277V AC       |
| 10A           | 1C10UR         | 277V AC       |
| 12A           | 1C12UR         | 277V AC       |
| 13A           | 1C13UR         | 277V AC       |
| 15A           | 1C15UR         | 277V AC       |
| 16A           | 1C16UR         | 277V AC       |
| 20A           | 1C20UR         | 277V AC       |
| 25A           | 1C25UR         | 277V AC       |
| 30A           | 1C30UR         | 277V AC       |
| 32A           | 1C32UR         | 277V AC       |
| 40A           | 1C40UR         | 277V AC       |
| 50A           | 1C50UR         | 277V AC       |
| 60A           | 1C60UR         | 277V AC       |
| 63A*          | 1C63UR         | 277V AC       |

\*63A is not UL Recognized.

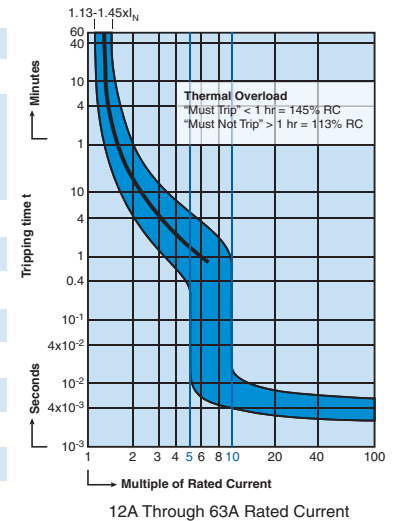
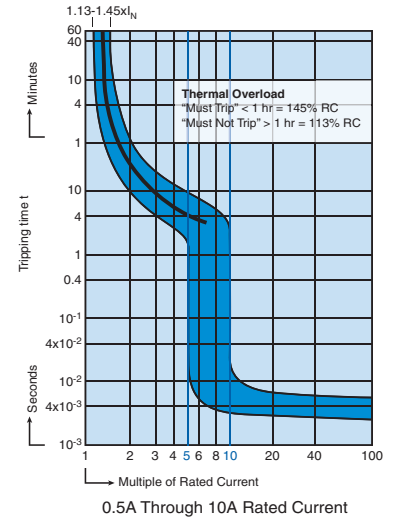

### UR - Series

|  |   |
|--|---|
| <b>Voltage Rating</b>                  | 0.5-60A / 277V AC   |
| <b>Short Circuit Withstand Rating</b>  | 0.5 - 10A (RC): 10 kA with no back-up fuse<br>8 - 63A (RC): 10 kA with UL-listed Class J back-up fuse;<br>5 kA with no back-up fuse |
| <b>Calibration Temperature</b>         | 30°C (86°F)   |
| <b>Ambient Temperature</b>             | -25°C to +55°C (-13°F to 131°F)   |
| <b>Storage Temperature</b>             | -40°C to +70°C (-40°F to 158°F)   |
| <b>Terminal Torque (min/max)</b>       | 2 Nm (17.7 lb.in.) / 2.5Nm (22.2 lb.in.)  |
| <b>Electrical Life</b>                 | 6000 switching cycles ON/ OFF   |
| <b>Mechanical Life</b>                 | 10000 switching cycles ON/ OFF  |
| <b>Vibration Resistance</b>            | > 15g according to DIN EN 60069-2-59 during a load with 1.05 x I <sub>N</sub>   |
| <b>Resistance to mechanical shocks</b> | 25g @ 11ms  |

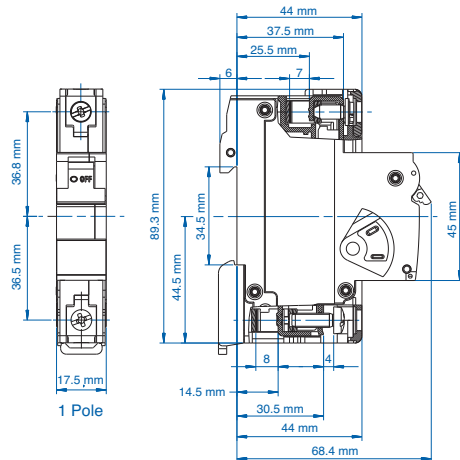

### "C" Magnetic Trip Parameters

Rated current 0.5A to 63A.

1. Hold for a minimum of 100ms at surge of 5 times rated current.
2. Trip in under 100ms at 10 times rated current.

### Short Circuit Withstand Ratings for R-Series Supplementary Protector

| Trip Curve | Amp Range | Backup Protection                 |                                |
|------------|-----------|-----------------------------------|--------------------------------|
|            |           | UL-Listed Class J Fuse up to 10kA | No Backup Fuse Required up to: |
| All        | 0.5 - 10A | 70A                               | 10kA                           |
| All        | 12 - 60A  | 4xRC*                             | 5kA                            |

\*up to nearest rated current

## X-ON Electronics

Largest Supplier of Electrical and Electronic Components

*Click to view similar products for [Circuit Breakers](#) category:*

*Click to view products by [Altech](#) manufacturer:*

Other Similar products are found below :

[LUGZX66-1-61-20.0-44](#) [M39019/01-221](#) [M39019/01-323](#) [M39019/01-336](#) [M39019/02-248](#) [M39019/02-311](#) [M39019/02-316](#) [M39019/04-249S](#) [M39019/05-246S](#) [M39019/06-254S](#) [M55629/1-016](#) [M55629/1-018](#) [M55629/1-021](#) [M55629/1-033](#) [M55629/1-036](#) [M55629/1-046](#) [M55629/1-048](#) [M55629/1-058](#) [M55629/1-067](#) [M55629/1-070](#) [M55629/1-079](#) [M55629/1-084](#) [M55629/1-085](#) [M55629/1-101](#) [M55629/1-109](#) [M55629/11-102](#) [M55629/1-120](#) [M55629/12-045](#) [M55629/12-046](#) [M55629/1-330](#) [M55629/1-366](#) [M55629/1-387](#) [M55629/1-401](#) [M55629/2-022](#) [M55629/2-030](#) [M55629/2-072](#) [M55629/2-082](#) [M55629/2-099](#) [M55629/2-101](#) [M55629/2-102](#) [M55629/21-BM-BM](#) [M55629/21-HM-HM](#) [M55629/21-NS-NS](#) [M55629/22-NR-NR-NR](#) [M55629/22-RS-RS-RS](#) [M55629/2-347](#) [M55629/2-401](#) [M55629/2-413](#) [M55629/3-030](#) [M55629/3-050](#)