

Cable Pull Switch Accessories

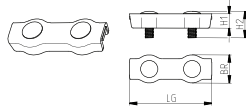

Cable Clamps, Cable, Springs, Turnbuckles & Pulleys

4 Cable grip, duplex



Size	LG	BR	H1	H2	Art. No.
2	35 mm	12 mm	5 mm	11 mm	269.0000.010
3	35 mm	14 mm	6 mm	14 mm	269.0000.011
4	40 mm	17 mm	7 mm	16 mm	269.0000.012

Material: Steel strip
Coating: Blue passivated, RoHS-compliant

5 Cable



Cable Ø / Sheath Ø	Design	Minimum breaking strength	Art. No.
D 1,8 / D 5	Similar to DIN 3055	275 kp	369.9100.008
D 2 / D 2.5	to DIN 3055	239 kp	369.9100.024
D 3 / D 4	to DIN 3055	538 kp	369.9100.025
D 4 / D 5	to DIN 3055	957 kp	369.9100.026

Material: Fiber-core galvanized, strength 1770 N/mm²
Coating: Blue passivated, RoHS-compliant

6 Compression spring, eye shape to DIN 1479

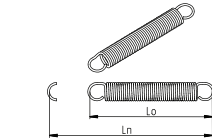

Fo	Fn	R	Lo	Ln	Art. No.
18 N	296 N	1.269 N/mm	188 mm	408 mm	365.2100.331
24 N	354 N	2.466 N/mm	180 mm	314 mm	365.2100.332
13.3 N	153 N	0.694 N/mm	185 mm	387 mm	365.2100.211
35.2 N	450 N	3.490 N/mm	201 mm	319 mm	365.2100.198

Material: Wire to DIN 2076 - 1.4310

7 Pull cable spring

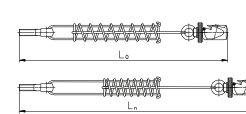

Fn	R	Lo	Ln	Art. No.
218 N	2.1 N/mm	383 mm	487 mm	391.1042.153
335 N	1.9 N/mm	483 mm	653 mm	391.1042.154

Material: Wire to DIN 2076 - 1.4310, cable grip - zinc pressure die-cast alloy, eye bolt to DIN 444 - 4.6
Coating: Thick-layer passivated (except spring), RoHS-compliant

7 Turnbuckle sleeve

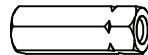

Size	Art. No.
M 6	2601479188
M 8	2601479189

Material: Steel, min. tensile strength 330 N/mm²
Coating: Blue passivated, RoHS-compliant

7 Turnbuckle similar to DIN 1480 with two eyes



Open	Art. No.
M 5 x 50	260.1480.016
M 6 x 60	260.1480.017

Material: Steel, forged
Coating: Blue passivated, RoHS-compliant

8 Pulley block, swivel version

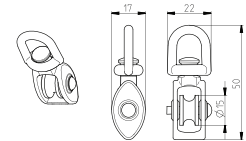

Art. No.
2690000023

Material: Zinc pressure die-cast alloy (pulley polyamide)
Coating: Blue passivated, RoHS-compliant

8 Pulley block, fixed version

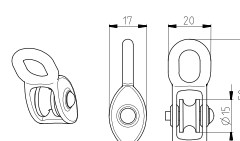

Art. No.
260.0000.022

Material: Zinc pressure die-cast alloy (pulley polyamide)
Coating: Blue passivated, RoHS-compliant

9 Mounting bracket for pulley to DIN 1142



Art. No.
3911751437

Material: Steel
Coating: Blue passivated, RoHS-compliant

Deflection pulley ø 75 mm for cable diameter up to 8 mm

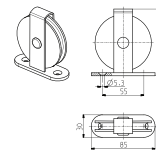

Art. No.
269.0000.051

Material: Steel/polyamide
Coating: Blue passivated, RoHS-compliant

X-ON Electronics

Largest Supplier of Electrical and Electronic Components

Click to view similar products for [Switch Fixings](#) category:

Click to view products by [Altech](#) manufacturer:

Other Similar products are found below :

[T92](#) [1302030523](#) [798204000](#) [843187-000](#) [843487-000](#) [MOR05](#) [GOUPILLE15X3G06](#) [A22L01AT1](#) [HG9Z-2K1](#) [12C1055-1](#) [12Q1452-2](#)
[1301260038](#) [1437612-7](#) [1530AABB](#) [B1440204](#) [NALDENG-B-SPL](#) [PAPHC22](#) [PAPLCONN](#) [PARR3](#) [PAWP9](#) [PAYPR6](#) [K16-VP-NUT](#) [K18](#)
[K35](#) [29Z2036-2](#) [A2268](#) [A3CT7122](#) [SP12](#) [2S09-09.0](#) [2SS09-08.0](#) [3-1437627-5](#) [39C1008-2](#) [MHU27](#) [BP1440804](#) [HWNP-SPL](#) [C0312.5](#)
[C0620](#) [C0810](#) [U10313](#) [U1676](#) [U369](#) [U916](#) [K36](#) [K39](#) [46W1133-1](#) [03-0023](#) [108565](#) [U3402](#) [W46](#) [VVA9CMD-100](#)