

# Test Plugs 4 mm System

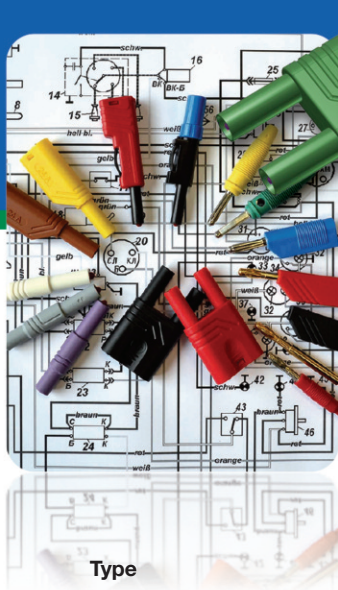

Type



## VQ 20

4mm spring loaded plug with 4mm cross hole, flexible insulation sleeve, nickel plated brass, screw terminal max. 1.5mm<sup>2</sup>.

Pin diameter 4 mm (0.157")

- PART NO. / Housing color
- 930058100
  - 930058101
  - 930058102
  - 930058103
  - 930058104
  - 930058107



## VQ 30

4mm spring loaded plug with 4mm cross hole, flexible insulation sleeve, nickel plated brass, solder terminal max. 2.5mm<sup>2</sup>.

Pin diameter 4 mm (0.157")

- PART NO. / Housing color
- 930061100
  - 930061101
  - 930061102
  - 930061103
  - 930061104
  - 930061107

### Technical Data

Contact Type	spring loaded pin
Connection Type	screw terminal max. 1.5mm <sup>2</sup>
Voltage Rating	30 VAC / 60 VDC
Measurement Category (IEC61010)	CAT I
Current Rating*	16A
Contact Resistance	3 mOhm

### Material Specifications

Plug	nickel plated brass
Contact Spring	-
Housing	PVC-P

### Environmental Conditions

Temperature range	-25°C to +70°C (-13 to 158°F)
-------------------	-------------------------------

### Flamability Rating

Housing	-
---------	---

spring loaded pin	solder terminal max. 2.5mm <sup>2</sup>
30 VAC / 60 VDC	CAT I
30A	30A
3 mOhm	3 mOhm

nickel plated brass	-
PP	-

-25°C to +70 °C (-13 to 158°F)	-
--------------------------------	---

### Drawing

Measurements are shown in millimeters.  
Multiply by 0.03937 to convert to inches.

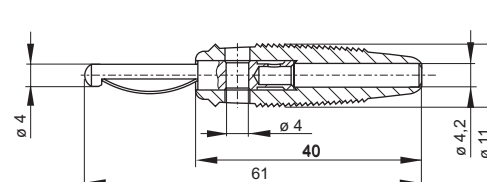
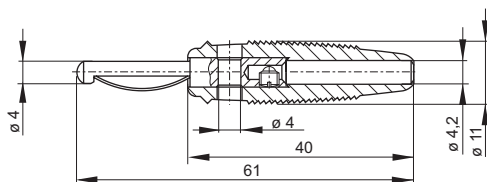

\* Please consider derating graph on page 80.

## X-ON Electronics

Largest Supplier of Electrical and Electronic Components

*Click to view similar products for [Test Plugs & Test Jacks](#) category:*

*Click to view products by [Altech](#) manufacturer:*

Other Similar products are found below :

[01-2601-4-0210](#) [01-2601-4-0212](#) [01-2604-4-0212](#) [01-2604-5-0210](#) [01-2150-1-0312](#) [01-2350-1-02](#) [01-2352-1-02](#) [01-2368-1-02](#) [01-2604-4-0210](#) [01-2604-5-0212](#) [01-2606-4-0210](#) [01-2606-4-0212](#) [01-2606-5-0212](#) [M39024/10-01G](#) [M39024/10-17G](#) [M39024/11-09G](#) [M39024/11-42](#) [M39024/11-43](#) [M39024/12-08](#) [707-5311](#) [707-5402-01-19](#) [707-5410](#) [923739-40-I](#) [R644543000](#) [R948161000](#) [R999351000](#) [1408-4](#) [1499-101](#) [1533-1](#) [1659559](#) [1659567](#) [1663921](#) [1663939](#) [1696-102](#) [174-R825B-EX](#) [NYS508-BU](#) [NYS508-O](#) [211-101](#) [RS100GBL](#) [RS250GBL](#) [251-102](#) [25-2251-2-03](#) [25-2259-2-03](#) [923743-16-I](#) [923743-24-I](#) [923743-28-I](#) [2854-BLU](#) [2970-BLK](#) [30-443G](#) [1680](#)