

Test Plugs 4 mm System

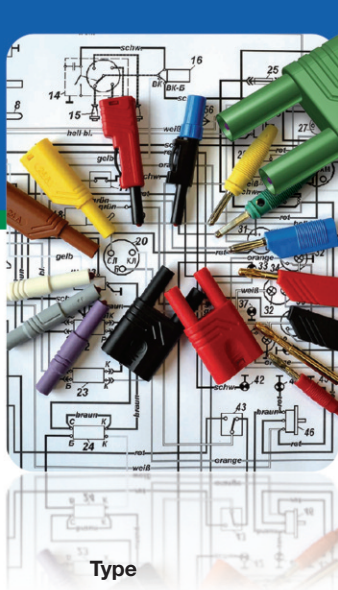

Type



VQ 20

4mm spring loaded plug with 4mm cross hole, flexible insulation sleeve, nickel plated brass, screw terminal max. 1.5mm².



VQ 30

4mm spring loaded plug with 4mm cross hole, flexible insulation sleeve, nickel plated brass, solder terminal max. 2.5mm².



Pin diameter

4 mm (0.157")

PART NO. / Housing color

- 930058100
- 930058101
- 930058102
- 930058103
- 930058104
- 930058107

4 mm (0.157")

- 930061100
- 930061101
- 930061102
- 930061103
- 930061104
- 930061107

Technical Data

Contact Type	spring loaded pin
Connection Type	screw terminal max. 1.5mm ²
Voltage Rating	30 VAC / 60 VDC
Measurement Category (IEC61010)	CAT I
Current Rating*	16A
Contact Resistance	3 mOhm

Material Specifications

Plug	nickel plated brass
Contact Spring	-
Housing	PVC-P

Environmental Conditions

Temperature range	-25°C to +70°C (-13 to 158°F)
-------------------	-------------------------------

Flamability Rating

Housing	-
---------	---

spring loaded pin	solder terminal max. 2.5mm ²
30 VAC / 60 VDC	CAT I
30A	30A
3 mOhm	3 mOhm

nickel plated brass	-
PP	-

-25°C to +70 °C (-13 to 158°F)	-
--------------------------------	---

Drawing

Measurements are shown in millimeters.
Multiply by 0.03937 to convert to inches.

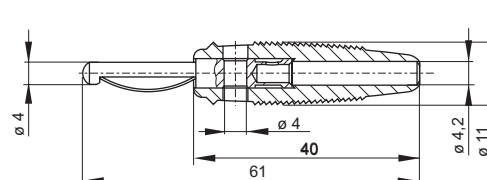
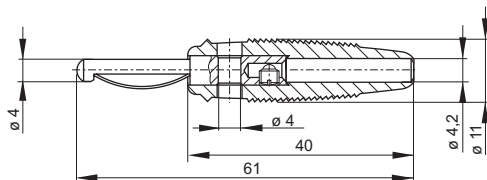

* Please consider derating graph on page 80.

X-ON Electronics

Largest Supplier of Electrical and Electronic Components

Click to view similar products for [Test Plugs & Test Jacks](#) category:

Click to view products by [Altech](#) manufacturer:

Other Similar products are found below :

[579-0400](#) [66000-7](#) [R644543000](#) [R921923000](#) [R921930000](#) [R941344000](#) [R948161000](#) [R999351000](#) [1408-4](#) [1533-1](#) [174-R825B-EX](#)
[NYS508-BU](#) [1680](#) [174-R819B-EX](#) [R644543003](#) [R644543004](#) [R644543020](#) [R644543021](#) [R921926000](#) [R921931000](#) [R921932000](#)
[R921934000](#) [R929991000](#) [R941460000](#) [R941461000](#) [R941463600](#) [R941920600](#) [R948160000](#) [31B-2-RED](#) [032-0016-023](#) [105-1106-001](#)
[108-1000-106](#) [108-2301-621](#) [66001-9](#) [7013](#) [1395080-1](#) [930166100](#) [NYS508-GR](#) [NYS508-W](#) [NYS508-Y](#) [NYS511-R](#) [BP30-2BR10-B PKG](#)
[BP30-10-WT](#) [BP30-2BR-B PKG](#) [BP30Y-1 PKG](#) [R941049000](#) [R941340000](#) [R948141029](#) [R921922000](#) [R644543022](#)