

Test Plugs 4 mm System

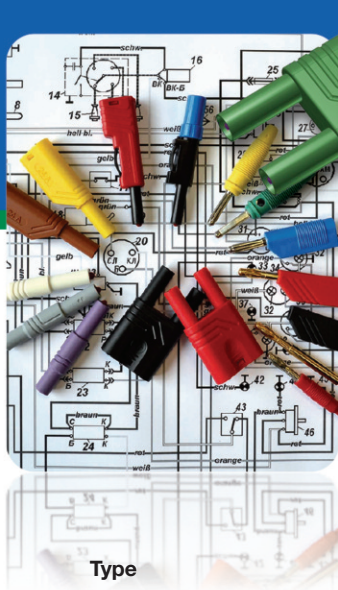

Type



VQ 20

4mm spring loaded plug with 4mm cross hole, flexible insulation sleeve, nickel plated brass, screw terminal max. 1.5mm².



VQ 30

4mm spring loaded plug with 4mm cross hole, flexible insulation sleeve, nickel plated brass, solder terminal max. 2.5mm².



Pin diameter

4 mm (0.157")

PART NO. / Housing color

- 930058100
- 930058101
- 930058102
- 930058103
- 930058104
- 930058107

4 mm (0.157")

- 930061100
- 930061101
- 930061102
- 930061103
- 930061104
- 930061107

Technical Data

Contact Type	spring loaded pin
Connection Type	screw terminal max. 1.5mm ²
Voltage Rating	30 VAC / 60 VDC
Measurement Category (IEC61010)	CAT I
Current Rating*	16A
Contact Resistance	3 mOhm

Material Specifications

Plug	nickel plated brass
Contact Spring	-
Housing	PVC-P

Environmental Conditions

Temperature range	-25°C to +70°C (-13 to 158°F)
-------------------	-------------------------------

Flamability Rating

Housing	-
---------	---

spring loaded pin	solder terminal max. 2.5mm ²
30 VAC / 60 VDC	CAT I
30A	30A
3 mOhm	3 mOhm

nickel plated brass	-
PP	-

-25°C to +70 °C (-13 to 158°F)	-
--------------------------------	---

Drawing

Measurements are shown in millimeters.
Multiply by 0.03937 to convert to inches.

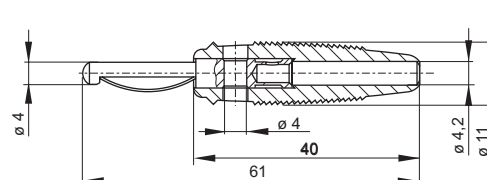
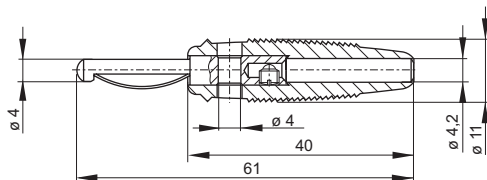

* Please consider derating graph on page 80.

X-ON Electronics

Largest Supplier of Electrical and Electronic Components

Click to view similar products for [Circuit Breaker Accessories](#) category:

Click to view products by [Altech](#) manufacturer:

Other Similar products are found below :

[CSC-403PS](#) [8T1-D-11A](#) [B151-7184-L](#) [NEB10](#) [8C1-C-721](#) [8T1-E-115](#) [8T1-E-275](#) [8T1-E-278](#) [4-1393247-8](#) [4-1393247-9](#) [506-11315-001](#)
[3803221](#) [3803231](#) [NEB6](#) [X10506BF](#) [NES](#) [9-1393249-0](#) [802-ESB50UL489](#) [3RV2011-1CA15](#) [607.5689.127](#) [30.329](#) [CA707/TS/01](#)
[11-32-2733](#) [X10508BF](#) [X22261102](#) [975090700](#) [CX2.5/4/O](#) [975090701](#) [PS-2P](#) [Y30019003](#) [C-TEC1225 P](#) [PS-1006](#) [618.6335.069](#)
[975455700](#) [BAC03](#) [930727103](#) [934097101](#) [ZG20-1](#) [934097100](#) [JX2.5/4](#) [KEM380CUL](#) [CC848756916](#) [JX2.5/6](#) [JX2.5/5](#) [HSP6/10U](#)
[DMRBU BLACK BOX](#) [DB16/BU](#) [DB16/BL](#) [CM2.5S2](#) [973604100](#)