



Test Jacks 4 mm System

Type

PK 10 A

4mm insulated panel mount binding post with 2mm cross hole, nickel plated brass, M4 thread terminal

PKN 10 B

4mm insulated panel mount binding post with 2.6mm cross hole, nickel plated brass, M6 thread terminal

Pin Diameter

4 mm

4 mm

PART NO. / Housing color

- 930099100
- 930099101
- 930099102
- 930099103
- 930099104
- 930099188

- 930117100
- 930117101

Technical Data

Contact Type	jack Ø 4 mm, cross hole Ø 2 mm
Connection Type	M 4 thread terminal
Voltage Rating	30 VAC / 60 VDC
Measurement Category (IEC61010)	CAT I
Current Rating*	16 A
Contact Resistance	2 mOhm
Mounting Type	screw thread M4

Material Specifications

Jack Body	nickel plated brass
Contact Spring	nickel
Housing	PF

Environmental Conditions

Temperature Range	-25°C to +100 °C (-13 to 212°F)
-------------------	---------------------------------

Flamability Rating

Housing	-
---------	---

jack Ø 4 mm, cross hole Ø 2,6 mm

Connection Type	M6 thread, solder terminal
Voltage Rating	30 VAC / 60 VDC
Measurement Category (IEC61010)	CAT I
Current Rating*	63 A
Contact Resistance	2 mOhm
Mounting Type	screw thread M6

brass

Contact Spring	nickel plated nickel
Housing	PF

-25°C to +100 °C (-13 to 212°F)

UL 94 HB

Drawing

Measurements are shown in millimeters.
Multiply by 0.03937 to convert to inches.

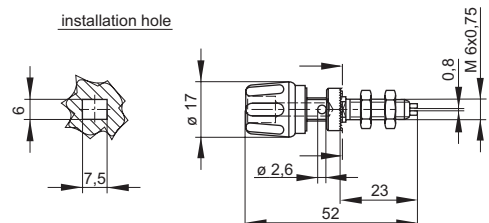
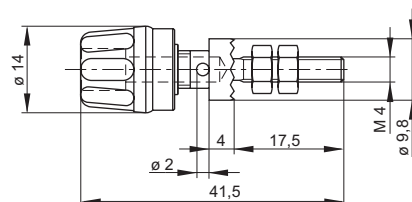

* Please consider derating graph on page 80.

X-ON Electronics

Largest Supplier of Electrical and Electronic Components

Click to view similar products for [Test Plugs & Test Jacks](#) category:

Click to view products by [Altech](#) manufacturer:

Other Similar products are found below :

[579-0400](#) [66000-7](#) [R644543000](#) [R921923000](#) [R921930000](#) [R941344000](#) [R948161000](#) [R999351000](#) [1408-4](#) [1533-1](#) [174-R825B-EX](#)
[NYS508-BU](#) [NYS508-O](#) [1680](#) [174-R819B-EX](#) [R644543003](#) [R644543004](#) [R644543020](#) [R644543021](#) [R921926000](#) [R921931000](#)
[R921932000](#) [R921934000](#) [R929991000](#) [R941460000](#) [R941461000](#) [R941463600](#) [R941920600](#) [R948160000](#) [31B-2-RED](#) [032-0016-023](#) [105-](#)
[1106-001](#) [108-1000-106](#) [108-2301-621](#) [66001-9](#) [7013](#) [1395080-1](#) [930166100](#) [NYS508-GR](#) [NYS508-V](#) [NYS508-W](#) [NYS508-Y](#) [NYS511-R](#)
[BP30-2BR10-B PKG](#) [BP30-10-WT](#) [BP30-2BR-B PKG](#) [BP30Y-1 PKG](#) [R941049000](#) [R941340000](#) [R948141029](#)