



Test Jacks 4 mm System

Type

PK 10 A

4mm insulated panel mount binding post with 2mm cross hole, nickel plated brass, M4 thread terminal

PKN 10 B

4mm insulated panel mount binding post with 2.6mm cross hole, nickel plated brass, M6 thread terminal

Pin Diameter

4 mm

4 mm

PART NO. / Housing color

- 930099100
- 930099101
- 930099102
- 930099103
- 930099104
- 930099188

- 930117100
- 930117101

Technical Data

Contact Type jack Ø 4 mm, cross hole Ø 2 mm
 Connection Type M 4 thread terminal
 Voltage Rating 30 VAC / 60 VDC
 Measurement Category (IEC61010) CAT I
 Current Rating* 16 A
 Contact Resistance 2 mOhm
 Mounting Type screw thread M4

Material Specifications

Jack Body nickel plated brass
 Contact Spring nickel
 Housing PF

Environmental Conditions

Temperature Range -25°C to +100 °C (-13 to 212°F)

Flamability Rating

Housing -

jack Ø 4 mm, cross hole Ø 2,6 mm
 M6 thread, solder terminal
 30 VAC / 60 VDC
 CAT I
 63 A
 2 mOhm
 screw thread M6

brass
 nickel plated nickel
 PF

-25°C to +100 °C (-13 to 212°F)

UL 94 HB

Drawing

Measurements are shown in millimeters.
 Multiply by 0.03937 to convert to inches.

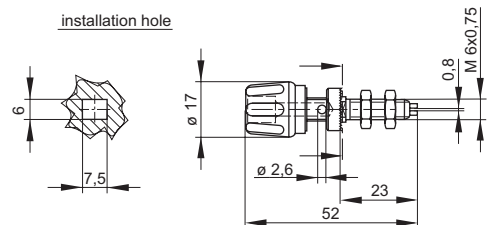
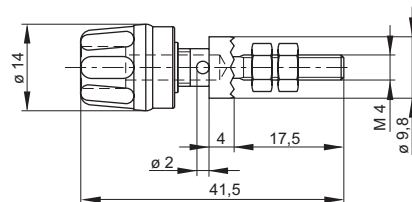

* Please consider derating graph on page 80.

X-ON Electronics

Largest Supplier of Electrical and Electronic Components

Click to view similar products for [Test Plugs & Test Jacks](#) category:

Click to view products by [Altech](#) manufacturer:

Other Similar products are found below :

[01-2601-4-0210](#) [01-2601-4-0212](#) [01-2604-4-0212](#) [01-2604-5-0210](#) [01-2150-1-0312](#) [01-2350-1-02](#) [01-2352-1-02](#) [01-2368-1-02](#) [01-2604-4-0210](#) [01-2604-5-0212](#) [01-2606-4-0210](#) [01-2606-4-0212](#) [01-2606-5-0212](#) [M39024/10-01G](#) [M39024/10-17G](#) [M39024/11-09G](#) [M39024/11-42](#) [M39024/11-43](#) [M39024/12-08](#) [707-5311](#) [707-5402-01-19](#) [707-5410](#) [923739-40-I](#) [R644543000](#) [R948161000](#) [R999351000](#) [1408-4](#) [1499-101](#) [1533-1](#) [1659559](#) [1659567](#) [1663921](#) [1663939](#) [1696-102](#) [174-R825B-EX](#) [NYS508-BU](#) [NYS508-O](#) [211-101](#) [RS100GBL](#) [RS250GBL](#) [251-102](#) [25-2251-2-03](#) [25-2259-2-03](#) [923743-16-I](#) [923743-24-I](#) [923743-28-I](#) [2854-BLU](#) [2970-BLK](#) [30-443G](#) [1680](#)