



Test Jacks 4 mm System

Type

BU 20

4mm panel mount test jack, nickel plated brass, M6 thread screw/ solder terminal. max. panel thickness 13.5mm

Pin Diameter

4 mm

PART NO. / Housing color

930177000



BIL 20 / BIL 20 Au

4mm panel mount test jack, tin/ gold plated brass, M6 thread screw/ solder terminal, max. panel thickness 2mm

4 mm

Nickel Plated

- 930176100
- 930176101
- 930176102
- 930176103
- 930176104
- 930176105
- 930176106
- 930176107
- 930176109

Gold Plated

- 930176700
- 930176701
- 930176702
- 930176703
- 930176704
- 930176705
- 930176706
- 930176707
- 930176709

Technical Data

Contact Type	jack Ø 4 mm
Connection Type	M6 thread, solder terminal
Voltage Rating	30 VAC / 60 VDC
Measurement Category (IEC61010)	CAT I
Current Rating*	16 A
Contact Resistance	5 mOhm
Mounting Type	screw thread M6
Material Specifications	
Jack Body	nickel plated brass
Contact Spring	nickel
Housing	-
Environmental Conditions	
Temperature Range	-25°C to +70 °C (-13 to 158°F)
Flamability Rating	
Housing	-

Contact Type	jack Ø 4 mm
Connection Type	M6 thread, solder terminal
Voltage Rating	30 VAC / 60 VDC
Measurement Category (IEC61010)	CAT I
Current Rating*	32 A
Contact Resistance	5 mOhm
Mounting Type	screw thread M6
Material Specifications	
Jack Body	tin / gold plated brass
Contact Spring	-
Housing	Polyamide
Environmental Conditions	
Temperature Range	-25°C to +70 °C (-13 to 158°F)
Flamability Rating	
Housing	UL 94 V-2

Drawing

Measurements are shown in millimeters. Multiply by 0.03937 to convert to inches.

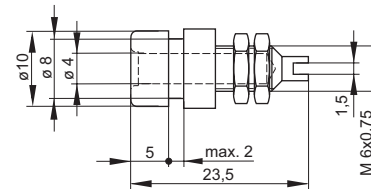
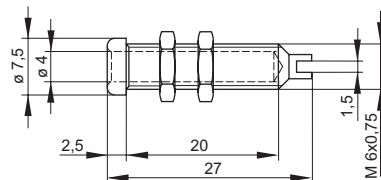

* Please consider derating graph on page 80.

X-ON Electronics

Largest Supplier of Electrical and Electronic Components

Click to view similar products for [Test Plugs & Test Jacks](#) category:

Click to view products by [Altech](#) manufacturer:

Other Similar products are found below :

[579-0400](#) [66000-7](#) [R644543000](#) [R921923000](#) [R921930000](#) [R941344000](#) [R948161000](#) [R999351000](#) [1408-4](#) [1533-1](#) [174-R825B-EX](#)
[NYS508-BU](#) [NYS508-O](#) [1680](#) [174-R819B-EX](#) [R644543003](#) [R644543004](#) [R644543020](#) [R644543021](#) [R921926000](#) [R921931000](#)
[R921932000](#) [R921934000](#) [R929991000](#) [R941460000](#) [R941461000](#) [R941463600](#) [R941920600](#) [R948160000](#) [31B-2-RED](#) [032-0016-023](#) [105-](#)
[1106-001](#) [108-1000-106](#) [108-2301-621](#) [66001-9](#) [7013](#) [1395080-1](#) [930166100](#) [NYS508-GR](#) [NYS508-V](#) [NYS508-W](#) [NYS508-Y](#) [NYS511-R](#)
[BP30-2BR10-B PKG](#) [BP30-10-WT](#) [BP30-2BR-B PKG](#) [BP30Y-1 PKG](#) [R941049000](#) [R941340000](#) [R948141029](#)