



Test Jacks 4 mm System

Type

BU 20

4mm panel mount test jack, nickel plated brass, M6 thread screw/ solder terminal. max. panel thickness 13.5mm

Pin Diameter

4 mm

PART NO. / Housing color

930177000



BIL 20 / BIL 20 Au

4mm panel mount test jack, tin/ gold plated brass, M6 thread screw/ solder terminal, max. panel thickness 2mm

4 mm

Nickel Plated

- 930176100
- 930176101
- 930176102
- 930176103
- 930176104
- 930176105
- 930176106
- 930176107
- 930176109

Gold Plated

- 930176700
- 930176701
- 930176702
- 930176703
- 930176704
- 930176705
- 930176706
- 930176707
- 930176709

Technical Data

Contact Type	jack Ø 4 mm
Connection Type	M6 thread, solder terminal
Voltage Rating	30 VAC / 60 VDC
Measurement Category (IEC61010)	CAT I
Current Rating*	16 A
Contact Resistance	5 mOhm
Mounting Type	screw thread M6
Material Specifications	
Jack Body	nickel plated brass
Contact Spring	nickel
Housing	-
Environmental Conditions	
Temperature Range	-25°C to +70 °C (-13 to 158°F)
Flamability Rating	
Housing	-

Contact Type	jack Ø 4 mm
Connection Type	M6 thread, solder terminal
Voltage Rating	30 VAC / 60 VDC
Measurement Category (IEC61010)	CAT I
Current Rating*	32 A
Contact Resistance	5 mOhm
Mounting Type	screw thread M6
Material Specifications	
Jack Body	tin / gold plated brass
Contact Spring	-
Housing	Polyamide
Environmental Conditions	
Temperature Range	-25°C to +70 °C (-13 to 158°F)
Flamability Rating	
Housing	UL 94 V-2

Drawing

Measurements are shown in millimeters. Multiply by 0.03937 to convert to inches.

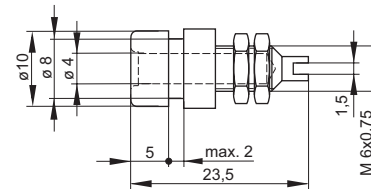
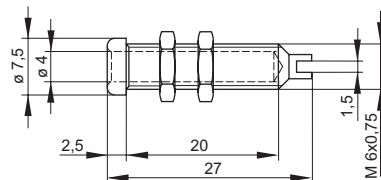

* Please consider derating graph on page 80.

X-ON Electronics

Largest Supplier of Electrical and Electronic Components

Click to view similar products for [Test Plugs & Test Jacks](#) category:

Click to view products by [Altech](#) manufacturer:

Other Similar products are found below :

[01-2601-4-0210](#) [01-2601-4-0212](#) [01-2604-4-0212](#) [01-2604-5-0210](#) [01-2150-1-0312](#) [01-2350-1-02](#) [01-2352-1-02](#) [01-2368-1-02](#) [01-2604-4-0210](#) [01-2604-5-0212](#) [01-2606-4-0210](#) [01-2606-4-0212](#) [01-2606-5-0212](#) [M39024/10-01G](#) [M39024/10-17G](#) [M39024/11-09G](#) [M39024/11-42](#) [M39024/11-43](#) [M39024/12-08](#) [707-5311](#) [707-5402-01-19](#) [707-5410](#) [923739-40-I](#) [R644543000](#) [R948161000](#) [R999351000](#) [1408-4](#) [1499-101](#) [1533-1](#) [1659559](#) [1659567](#) [1663921](#) [1663939](#) [1696-102](#) [174-R825B-EX](#) [NYS508-BU](#) [NYS508-O](#) [211-101](#) [RS100GBL](#) [RS250GBL](#) [251-102](#) [25-2251-2-03](#) [25-2259-2-03](#) [923743-16-I](#) [923743-24-I](#) [923743-28-I](#) [2854-BLU](#) [2970-BLK](#) [30-443G](#) [1680](#)