

# Test Jacks 2 mm System



**Type** **MKU 1**  
2mm mini Adapter, tin plated Copper-Beryllium contact spring with solder terminal. Flexible, shatter-proof insulation sleeve, max. connecting lead diameter 2mm.

Pin Diameter 2 mm

- PART NO. / Housing color**
- 930320100
  - 930320101
  - 930320102
  - 930320103
  - 930320104
  - 930320107



**MBI 1 / MBI 1 Au**  
2mm panel mount mini test jack, tin/ gold plated Copper-Beryllium contact spring with solder terminal. Installation in equipment chassis and switch panels, max. wall thickness 5mm.

- 2 mm
- |                      |                    |
|----------------------|--------------------|
| <b>Nickel Plated</b> | <b>Gold Plated</b> |
| ● 930308100          | ● 930308700        |
| ● 930308101          | ● 930308701        |
| ● 930308102          | ● 930308702        |
| ● 930308103          | ● 930308703        |
| ● 930308104          | ● 930308704        |
| ● 930308106          | ● 930308706        |

### Technical Data

Contact Type spring-loaded jack Ø 2 mm  
 Connection Type solder terminal max Ø 2 mm  
 Voltage Rating 30 VAC / 60 VDC  
 Measurement Category (IEC61010) CAT I  
 Current Rating\* 6 A  
 Contact Resistance 6 mOhm  
 Mounting Type -

### Material Specifications

Jack Body -  
 Contact Spring tin plated copper-beryllium  
 Housing PVC-P

### Environmental Conditions

Temperature Range -20°C to +60 °C (-4 to 140°F)

### Flamability Rating

Housing -

spring-loaded jack Ø 2 mm

solder terminal  
 30 VAC / 60 VDC  
 CAT I  
 6 A  
 6 mOhm  
 screw thread M5

-  
 tin plated copper-beryllium | gold plated copper-beryllium  
 Polyamide

-20°C to +60 °C (-4 to 140°F)

UL 94 HB

### Drawing

Measurements are shown in millimeters.  
 Multiply by 0.03937 to convert to inches.

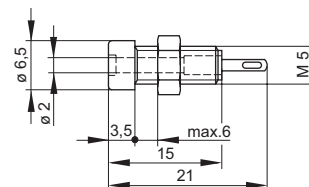
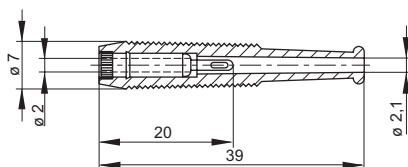

\* Please consider derating graph on page 80.

## X-ON Electronics

Largest Supplier of Electrical and Electronic Components

*Click to view similar products for [Test Sockets](#) category:*

*Click to view products by [Altech](#) manufacturer:*

Other Similar products are found below :

[AXS-5032-04-02](#) [AXS-3225-04-06](#) [AXS-7050-04-12](#) [5662](#) [BP30-10-B](#) [BP30GNN-1 PKG](#) [BP30-10Y-1 PKG](#) [AXS-7050-04-01](#) [AXS-5032-04-06](#) [AXS-2520-04-01](#) [AXS-5032-04-04](#) [930308101](#) [931714101](#) [15.0084-21](#) [563-0500](#) [20.1020-21](#) [20-313137](#) [20-313139](#) [20-313144](#) [20-313140](#) [20-313143](#) [22.1042](#) [+ 22.2370-22](#) [23.1010-23, 24, 25, 26, 27](#) [24.0160-1+25.0035](#) [24.0160-4+25.0035](#) [24.116-22](#) [5281](#) [5279](#) [450-3704-01-06-00](#) [AXS-3225-04-04](#) [AXS-3225-04-10](#) [AXS-7550-06-03](#) [AXS-7550-06-05](#) [269RB](#) [2713BB](#) [BP30BN-1 PKG](#) [BP30RN-1 PKG](#) [571-0200](#) [450-3422-01-06-00](#) [450-3888-01-04-00](#) [BP30GP10](#) [571-0400](#) [571-0600](#) [66.9131-23](#) [66.9427-22](#) [BP21-2BRN-B PKG](#) [930058104](#) [930103102](#) [930103188](#) [930103700](#)