

Test Jacks 2 mm System



Type **MKU 1**
2mm mini Adapter, tin plated Copper-Beryllium contact spring with solder terminal. Flexible, shatter-proof insulation sleeve, max. connecting lead diameter 2mm.

Pin Diameter 2 mm

PART NO. / Housing color

- 930320100
- 930320101
- 930320102
- 930320103
- 930320104
- 930320107



MBI 1 / MBI 1 Au
2mm panel mount mini test jack, tin/ gold plated Copper-Beryllium contact spring with solder terminal. Installation in equipment chassis and switch panels, max. wall thickness 5mm.

2 mm

Nickel Plated

- 930308100
- 930308101
- 930308102
- 930308103
- 930308104
- 930308106

Gold Plated

- 930308700
- 930308701
- 930308702
- 930308703
- 930308704
- 930308706

Technical Data

Contact Type spring-loaded jack Ø 2 mm
Connection Type solder terminal max Ø 2 mm
Voltage Rating 30 VAC / 60 VDC
Measurement Category (IEC61010) CAT I
Current Rating* 6 A
Contact Resistance 6 mOhm
Mounting Type -

Material Specifications

Jack Body -
Contact Spring tin plated copper-beryllium
Housing PVC-P

Environmental Conditions

Temperature Range -20°C to +60 °C (-4 to 140°F)

Flamability Rating

Housing -

spring-loaded jack Ø 2 mm

solder terminal
30 VAC / 60 VDC
CAT I
6 A
6 mOhm
screw thread M5

-
tin plated copper-beryllium | gold plated copper-beryllium
Polyamide

-20°C to +60 °C (-4 to 140°F)

UL 94 HB

Drawing

Measurements are shown in millimeters.
Multiply by 0.03937 to convert to inches.

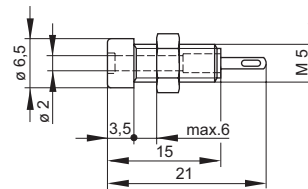
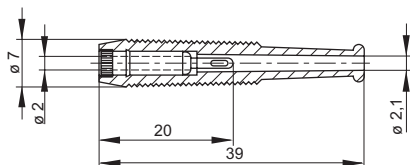

* Please consider derating graph on page 80.

X-ON Electronics

Largest Supplier of Electrical and Electronic Components

Click to view similar products for [Circuit Breaker Accessories](#) category:

Click to view products by [Altech](#) manufacturer:

Other Similar products are found below :

[CSC-403PS](#) [8T1-D-11A](#) [B151-7184-L](#) [NEB10](#) [8C1-C-721](#) [8T1-E-115](#) [8T1-E-275](#) [8T1-E-278](#) [4-1393247-8](#) [4-1393247-9](#) [506-11315-001](#)
[3803221](#) [3803231](#) [NEB6](#) [X10506BF](#) [NES](#) [9-1393249-0](#) [802-ESB50UL489](#) [3RV2011-1CA15](#) [607.5689.127](#) [30.329](#) [CA707/TS/01](#)
[11-32-2733](#) [X10508BF](#) [X22261102](#) [975090700](#) [CX2.5/4/O](#) [975090701](#) [PS-2P](#) [Y30019003](#) [C-TEC1225 P](#) [PS-1006](#) [618.6335.069](#)
[975455700](#) [BAC03](#) [930727103](#) [934097101](#) [ZG20-1](#) [934097100](#) [JX2.5/4](#) [KEM380CUL](#) [CC848756916](#) [JX2.5/6](#) [JX2.5/5](#) [HSP6/10U](#)
[DMRBU BLACK BOX](#) [DB16/BU](#) [DB16/BL](#) [CM2.5S2](#) [973604100](#)