

Test Jacks 2 mm System



Type

MKU 1

2mm mini Adapter, tin plated Copper-Beryllium contact spring with solder terminal. Flexible, shatter-proof insulation sleeve, max. connecting lead diameter 2mm.

Pin Diameter

2 mm

PART NO. / Housing color

- 930320100
- 930320101
- 930320102
- 930320103
- 930320104
- 930320107



MBI 1 / MBI 1 Au

2mm panel mount mini test jack, tin/ gold plated Copper-Beryllium contact spring with solder terminal. Installation in equipment chassis and switch panels, max. wall thickness 5mm.

2 mm

Nickel Plated

- 930308100
- 930308101
- 930308102
- 930308103
- 930308104
- 930308106

Gold Plated

- 930308700
- 930308701
- 930308702
- 930308703
- 930308704
- 930308706

Technical Data

Contact Type	spring-loaded jack Ø 2 mm
Connection Type	solder terminal max Ø 2 mm
Voltage Rating	30 VAC / 60 VDC
Measurement Category (IEC61010)	CAT I
Current Rating*	6 A
Contact Resistance	6 mOhm
Mounting Type	-

Material Specifications

Jack Body	-
Contact Spring	tin plated copper-beryllium
Housing	PVC-P

Environmental Conditions

Temperature Range	-20°C to +60 °C (-4 to 140°F)
-------------------	-------------------------------

Flamability Rating

Housing	-
---------	---

spring-loaded jack Ø 2 mm

solder terminal	30 VAC / 60 VDC
Measurement Category (IEC61010)	CAT I
Current Rating*	6 A
Contact Resistance	6 mOhm
Mounting Type	screw thread M5

Jack Body	-
Contact Spring	tin plated copper-beryllium gold plated copper-beryllium
Housing	Polyamide

-20°C to +60 °C (-4 to 140°F)

UL 94 HB

Drawing

Measurements are shown in millimeters.
Multiply by 0.03937 to convert to inches.

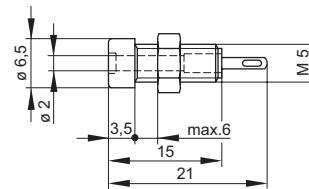
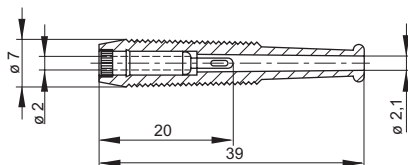

* Please consider derating graph on page 80.

X-ON Electronics

Largest Supplier of Electrical and Electronic Components

Click to view similar products for [Test Sockets](#) category:

Click to view products by [Altech](#) manufacturer:

Other Similar products are found below :

[AXS-5032-04-02](#) [AXS-3225-04-06](#) [AXS-7050-04-12](#) [5662](#) [BP30-10-B](#) [BP30GNN-1 PKG](#) [BP30-10Y-1 PKG](#) [AXS-7050-04-01](#) [AXS-5032-04-06](#) [AXS-2520-04-01](#) [AXS-5032-04-04](#) [972361101](#) [972361100](#) [930308100](#) [931714100](#) [931714101](#) [930308104](#) [66.9328-25](#) [563-0100](#) [563-0500](#) [551-0700](#) [563-0300](#) [563-0600](#) [563-0700](#) [5281](#) [5279](#) [571-0300](#) [572-0200](#) [572-0400](#) [AXS-7550-06-03](#) [2713BB](#) [295-103](#) [571-0200](#) [571-0400](#) [571-0600](#) [934097102](#) [1458-103](#) [AXS-1147-02-02](#) [AXS-2520-04-08](#) [AXS-3030-06-03](#) [AXS-3215-02-01](#) [AXS-3215-02-05](#) [AXS-3838-08-01](#) [AXS-5032-04-12](#) [930320100](#) [CL159701](#) [551-0100](#) [551-0200](#) [551-0400](#) [551-0500](#)