



Test Jacks 4 mm System

Type

PK 110

4mm insulated panel mount binding post with 2mm cross hole, nickel plated brass M4 thread terminal.

Pin Diameter 4 mm

Pin Diameter

PART NO. / Housing color

- 931713100
- 931713101



PKI 110

4mm insulated panel mount binding post with 2mm cross hole, nickel plated brass, M4 thread terminal, max. panel thickness 3.5mm.

Pin Diameter 4 mm

- 931714100
- 931714101
- 931714102
- 931714103
- 931714104
- 931714188



Technical Data

Contact Type	jack Ø 4 mm, cross hole Ø 2 mm
Connection Type	M4 thread terminal
Voltage Rating	30 VAC / 60 VDC
Measurement Category (IEC61010)	CAT I
Current Rating*	35 A
Contact Resistance	2 mOhm
Mounting Type	screw thread M4

Material Specifications

Jack Body	nickel plated brass
Contact Spring	-
Housing	Polyamide

Environmental Conditions

Temperature Range	-25°C to +100 °C (-13 to 212°F)
-------------------	---------------------------------

Flamability Rating

Housing	UL 94 V-2
---------	-----------

jack Ø 4 mm, cross hole Ø 2 mm

Connection Type	M4 thread terminal
Voltage Rating	30 VAC / 60 VDC
Measurement Category (IEC61010)	CAT I
Current Rating*	35 A
Contact Resistance	2 mOhm
Mounting Type	screw thread M4

nickel plated brass

Contact Spring	-
Housing	Polyamide

-25°C to +100 °C (-13 to 212°F)

UL 94 V-2

Drawing

Measurements are shown in millimeters. Multiply by 0.03937 to convert to inches.

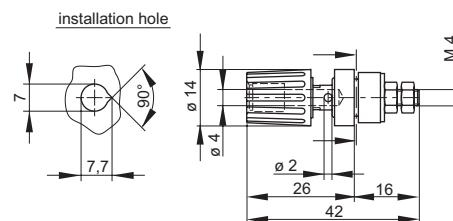
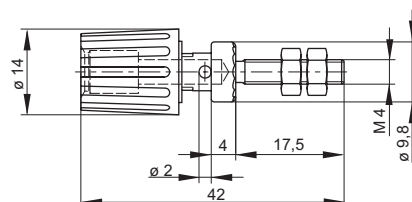

* Please consider derating graph on page 80.

X-ON Electronics

Largest Supplier of Electrical and Electronic Components

Click to view similar products for [Test Sockets](#) category:

Click to view products by [Altech](#) manufacturer:

Other Similar products are found below :

[AXS-5032-04-02](#) [AXS-3225-04-06](#) [AXS-7050-04-12](#) [5662](#) [BP30-10-B](#) [BP30GNN-1 PKG](#) [BP30-10Y-1 PKG](#) [AXS-7050-04-01](#) [AXS-5032-04-06](#) [AXS-2520-04-01](#) [AXS-5032-04-04](#) [972361101](#) [972361100](#) [930308100](#) [931714100](#) [931714101](#) [930308104](#) [66.9328-25](#) [563-0100](#) [563-0500](#) [551-0700](#) [563-0300](#) [563-0600](#) [563-0700](#) [5281](#) [5279](#) [571-0300](#) [572-0200](#) [572-0400](#) [AXS-7550-06-03](#) [2713BB](#) [295-103](#) [571-0200](#) [571-0400](#) [571-0600](#) [934097102](#) [1458-103](#) [AXS-1147-02-02](#) [AXS-2520-04-08](#) [AXS-3030-06-03](#) [AXS-3215-02-01](#) [AXS-3215-02-05](#) [AXS-3838-08-01](#) [AXS-5032-04-12](#) [930320100](#) [CL159701](#) [551-0100](#) [551-0200](#) [551-0400](#) [551-0500](#)