

Test Plugs 4 mm System



Type

LAS S WS
4mm safety banana plug,
stackable, 1000V system,
screw terminal 0.5-1.5mm²
leads.

Pin diameter

4 mm (0.157")

PART NO. / Housing color

- 934099100
- 934099101
- 934099102
- 934099103
- 934099104
- 934099105
- 934099106
- 934099107
- 934099109



LAS S G
4mm safety banana plug,
stackable, 1000V system,
screw terminal 0.5-1.5mm²
leads.

4 mm (0.157")

- 934097100
- 934097101
- 934097102
- 934097103
- 934097104
- 934097105
- 934097106
- 934097107
- 934097109



KST S WS
4mm dual safety plug,
stackable, 1000V system,
nickel plated, 4mm jack.

4 mm (0.157")

- 932200100
- 932200101
- 932200102
- 932200103
- 932200104

Technical Data

Contact Type: spring loaded plug
 Connection Type: screw terminal 0.5-1.5mm²
 Voltage Rating: AC/DC 1000 V
 Measurement Category (IEC61010): CAT II
 Current Rating*: 24A
 Contact Resistance: -

Material Specifications

Plug: nickel plated brass
 Contact Spring: nickel plated copper-beryllium
 Housing: Polyamide

Environmental Conditions

Temperature range: -15°C to +70°C (5 to 158°F)

Flamability Rating

Housing: UL 94 V-2

Contact Type: spring loaded plug
 Connection Type: screw terminal 0.5-1.5mm²
 Voltage Rating: AC/DC 1000 V
 Measurement Category (IEC61010): CAT III
 Current Rating*: 24A
 Contact Resistance: -

Plug: nickel plated brass
 Contact Spring: nickel plated copper-beryllium
 Housing: Polyamide

Temperature range: -15°C to +70°C (5 to 158°F)

Housing: UL 94 V-2

Contact Type: 2x spring loaded plug
 Connection Type: jack Ø 4 mm
 Voltage Rating: AC/DC 1000 V
 Measurement Category (IEC61010): CAT II
 Current Rating*: 32A
 Contact Resistance: 8 mOhm

Plug: nickel plated copper-beryllium
 Contact Spring: nickel plated brass
 Housing: Polyamide

Temperature range: -15°C to +70°C (5 to 158°F)

Housing: UL 94 V-2

Drawing

Measurements are shown in millimeters.
 Multiply by 0.03937 to convert to inches.

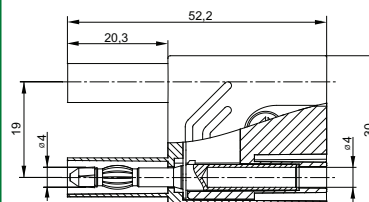
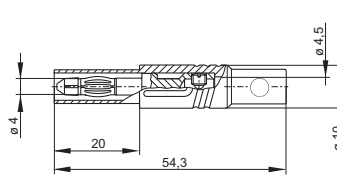
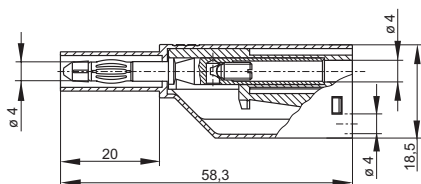

* Please consider derating graph on page 80.

X-ON Electronics

Largest Supplier of Electrical and Electronic Components

Click to view similar products for [Circuit Breaker Accessories](#) category:

Click to view products by [Altech](#) manufacturer:

Other Similar products are found below :

[CSC-403PS](#) [8T1-D-11A](#) [B151-7184-L](#) [NEB10](#) [8C1-C-721](#) [8T1-E-115](#) [8T1-E-275](#) [8T1-E-278](#) [4-1393247-8](#) [4-1393247-9](#) [506-11315-001](#)
[3803221](#) [3803231](#) [NEB6](#) [X10506BF](#) [NES](#) [9-1393249-0](#) [802-ESB50UL489](#) [3RV2011-1CA15](#) [607.5689.127](#) [30.329](#) [CA707/TS/01](#)
[11-32-2733](#) [X10508BF](#) [X22261102](#) [975090700](#) [CX2.5/4/O](#) [975090701](#) [PS-2P](#) [Y30019003](#) [C-TEC1225 P](#) [PS-1006](#) [618.6335.069](#)
[975455700](#) [BAC03](#) [930727103](#) [934097101](#) [ZG20-1](#) [934097100](#) [JX2.5/4](#) [KEM380CUL](#) [CC848756916](#) [JX2.5/6](#) [JX2.5/5](#) [HSP6/10U](#)
[DMRBU BLACK BOX](#) [DB16/BU](#) [DB16/BL](#) [CM2.5S2](#) [973604100](#)