

# Test Plugs 4 mm System



**Type**

**LAS S WS**

4mm safety banana plug, stackable, 1000V system, screw terminal 0.5-1.5mm<sup>2</sup> leads.

Pin diameter

4 mm (0.157")

**PART NO. / Housing color**

- 934099100
- 934099101
- 934099102
- 934099103
- 934099104
- 934099105
- 934099106
- 934099107
- 934099109



**LAS S G**

4mm safety banana plug, stackable, 1000V system, screw terminal 0.5-1.5mm<sup>2</sup> leads.

4 mm (0.157")

- 934097100
- 934097101
- 934097102
- 934097103
- 934097104
- 934097105
- 934097106
- 934097107
- 934097109



**KST S WS**

4mm dual safety plug, stackable, 1000V system, nickel plated, 4mm jack.

4 mm (0.157")

- 932200100
- 932200101
- 932200102
- 932200103
- 932200104

**Technical Data**

Contact Type	spring loaded plug
Connection Type	screw terminal 0.5-1.5mm <sup>2</sup>
Voltage Rating	AC/DC 1000 V
Measurement Category (IEC61010)	CAT II
Current Rating*	24A
Contact Resistance	-

**Material Specifications**

Plug	nickel plated brass
Contact Spring	nickel plated copper-beryllium
Housing	Polyamide

**Environmental Conditions**

Temperature range	-15°C to +70°C (5 to 158°F)
-------------------	-----------------------------

**Flamability Rating**

Housing	UL 94 V-2
---------	-----------

Contact Type	spring loaded plug
Connection Type	screw terminal 0.5-1.5mm <sup>2</sup>
Voltage Rating	AC/DC 1000 V
Measurement Category (IEC61010)	CAT III
Current Rating*	24A
Contact Resistance	-

Plug	nickel plated brass
Contact Spring	nickel plated copper-beryllium
Housing	Polyamide

Temperature range	-15°C to +70°C (5 to 158°F)
-------------------	-----------------------------

Housing	UL 94 V-2
---------	-----------

Contact Type	2x spring loaded plug
Connection Type	jack Ø 4 mm
Voltage Rating	AC/DC 1000 V
Measurement Category (IEC61010)	CAT II
Current Rating*	32A
Contact Resistance	8 mOhm

Plug	nickel plated copper-beryllium
Contact Spring	nickel plated brass
Housing	Polyamide

Temperature range	-15°C to +70°C (5 to 158°F)
-------------------	-----------------------------

Housing	UL 94 V-2
---------	-----------

**Drawing**

Measurements are shown in millimeters.  
Multiply by 0.03937 to convert to inches.

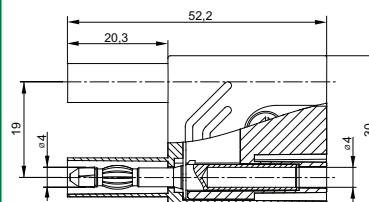
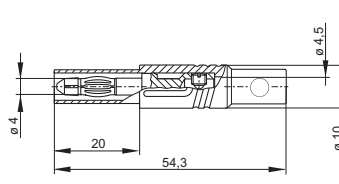
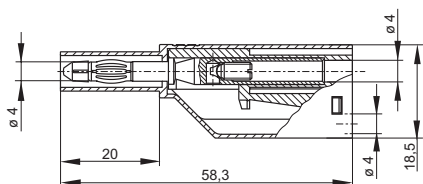

\* Please consider derating graph on page 80.

## X-ON Electronics

Largest Supplier of Electrical and Electronic Components

*Click to view similar products for [Test Plugs & Test Jacks](#) category:*

*Click to view products by [Altech](#) manufacturer:*

Other Similar products are found below :

[01-2601-4-0210](#) [01-2601-4-0212](#) [01-2604-4-0212](#) [01-2350-1-02](#) [01-2368-1-02](#) [01-2606-4-0210](#) [01-2606-5-0212](#) [M39024/11-09G](#)  
[M39024/11-42](#) [M39024/11-43](#) [M39024/12-08](#) [707-5311](#) [707-5402-01-19](#) [707-5410](#) [R948161000](#) [1408-4](#) [1533-1](#) [1659559](#) [1659567](#)  
[1663921](#) [1663939](#) [1696-102](#) [174-R825B-EX](#) [1905509](#) [1905527](#) [1914916](#) [211-101](#) [RS100GBL](#) [RS250GBL](#) [251-102](#) [25-2251-2-03](#) [25-](#)  
[2259-2-03](#) [923743-28-I](#) [2854-BLU](#) [2970-BLK](#) [30-443G](#) [1909861](#) [1916120](#) [1916466](#) [1918007](#) [1919515](#) [1920271](#) [1929125](#) [1933440](#)  
[1938303](#) [1944375](#) [204-103](#) [2079](#) [2435108](#) [2803-102](#)