

Test Plugs 4 mm System



Type

LAS N WS / LAS N WS Au

4mm stackable plug, nickel/ gold plated contact spring, screw terminal 0.5-1.5mm².

BSB 20 K

4mm multi spring plug with cable gland, nickel plated brass, screw terminal max. 2.5mm².

Pin diameter

4 mm (0.157")

4 mm (0.157")

PART NO. / Housing color

Nickel Plated	Gold Plated
● 934100100	● 934100700
● 934100101	● 934100701
● 934100102	● 934100702
● 934100103	● 934100703
● 934100104	● 934100704
● 934100105	● 934100705
● 934100106	● 934100706
● 934100107	● 934100707
● 934100109	● 934100709

● 930729100
● 930729101
● 930729102
● 930729103
● 930729104

Technical Data

Contact Type	spring loaded pin
Connection Type	screw terminal max. 1.5mm ²
Voltage Rating	30 VAC / 60 VDC
Measurement Category (IEC61010)	CAT I
Current Rating*	24A
Contact Resistance	3 mOhm

Material Specifications

Plug	nickel plated brass; gold plated brass
Contact Spring	nickel pl. copper-beryllium; gold pl. copper-beryllium
Housing	Polyamide

Environmental Conditions

Temperature range	-15 °C to +70°C (5 to 158°F)
-------------------	------------------------------

Flamability Rating

Housing	UL 94 V-2
---------	-----------

Contact Type	spring loaded pin
Connection Type	screw terminal max. 2.5mm ²
Voltage Rating	30 VAC / 60 VDC
Measurement Category (IEC61010)	CAT I
Current Rating*	30A
Contact Resistance	3 mOhm

Plug	brass
Contact Spring	nickel
Housing	PP

Temperature range	-25 °C to +100°C (-13 to 212°F)
-------------------	---------------------------------

Housing	UL 94 HB
---------	----------

Drawing

Measurements are shown in millimeters.
Multiply by 0.03937 to convert to inches.

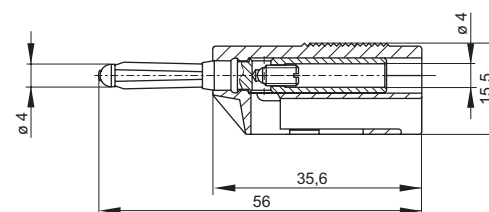
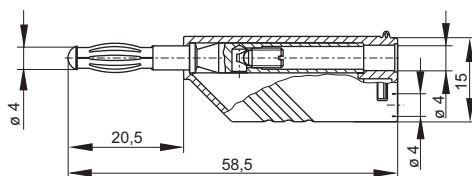

* Please consider derating graph on page 80.

X-ON Electronics

Largest Supplier of Electrical and Electronic Components

Click to view similar products for [Circuit Breaker Accessories](#) category:

Click to view products by [Altech](#) manufacturer:

Other Similar products are found below :

[CSC-403PS](#) [8T1-D-11A](#) [B151-7184-L](#) [NEB10](#) [8C1-C-721](#) [8T1-E-115](#) [8T1-E-275](#) [8T1-E-278](#) [4-1393247-8](#) [4-1393247-9](#) [506-11315-001](#)
[3803221](#) [3803231](#) [NEB6](#) [X10506BF](#) [NES](#) [9-1393249-0](#) [802-ESB50UL489](#) [3RV2011-1CA15](#) [607.5689.127](#) [30.329](#) [CA707/TS/01](#)
[11-32-2733](#) [X10508BF](#) [X22261102](#) [975090700](#) [CX2.5/4/O](#) [975090701](#) [PS-2P](#) [Y30019003](#) [C-TEC1225 P](#) [PS-1006](#) [618.6335.069](#)
[975455700](#) [BAC03](#) [930727103](#) [934097101](#) [ZG20-1](#) [934097100](#) [JX2.5/4](#) [KEM380CUL](#) [CC848756916](#) [JX2.5/6](#) [JX2.5/5](#) [HSP6/10U](#)
[DMRBU BLACK BOX](#) [DB16/BU](#) [DB16/BL](#) [CM2.5S2](#) [973604100](#)