

Test Probes 4 mm Safety System



Type

PRUEF 2700

Safety test probe with dual function. Tip for penetrating insulation and oxide layers and 4 mm diameter pin for insertion in sockets. 4 mm diameter brass socket connection. Connects with safety measuring leads.

PRUEF 2600

Test probe with elastic, shatter-proof insulated sleeve and slender stainless steel tip. Tip for penetration of insulation and oxide layers. 4 mm diameter brass socket connection. Connects with safety measuring leads. Accessory tip protector and IC tap SS 260.

Tip diameter

4 mm (0.157 in.)

2 mm (0.78 in.)

PART NO. / Housing color

972319100 ●
972319101 ●

972317100 ●
972317101 ●

Technical Data

Connection Type	stationary tip
Voltage Rating	fixed socket Ø 4 mm
Measurement Category (IEC61010)	AC/DC 1000 V
Current Rating*	CAT II
Contact Resistance	32 A
Material Specifications	2 mOhm
Tip	nickel plated brass
Connection pin/ socket	nickel plated brass
Contact Spring	-
Housing	PP
Environmental Conditions	
Temperature range	-25 °C to +80 °C (13°F to 176°F)
Flamability Rating	
Housing	UL 94 HB

Connection Type	stationary tip
Voltage Rating	fixed socket Ø 4 mm
Measurement Category (IEC61010)	AC/DC 1000 V
Current Rating*	CAT III
Contact Resistance	1 A
Material Specifications	50 mOhm
Tip	stainless steel
Connection pin/ socket	nickel plated brass
Contact Spring	-
Housing	PP
Environmental Conditions	
Temperature range	-25 °C to +80 °C (13°F to 176°F)
Flamability Rating	
Housing	UL 94 HB

Drawing

Measurements are shown in millimeters. Multiply by 0.03937 to convert to inches.

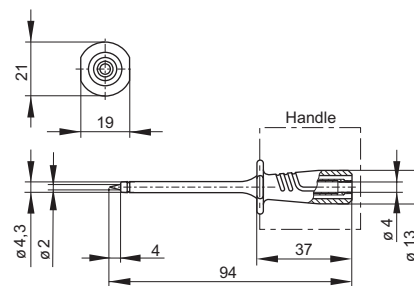
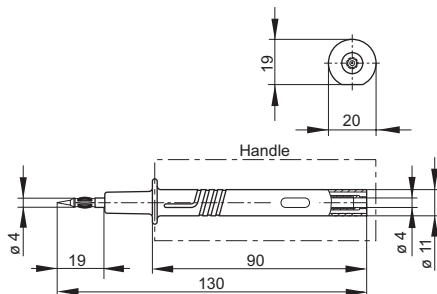

* Please consider derating graph on page 80.

X-ON Electronics

Largest Supplier of Electrical and Electronic Components

Click to view similar products for [Test Probes](#) category:

Click to view products by [Altech](#) manufacturer:

Other Similar products are found below :

[6214](#) [6474](#) [815003](#) [923832-BK-B](#) [P-KIT-1](#) [KT-MS001](#) [925250-R](#) [923848-C](#) [973368101](#) [972318101](#) [972318100](#) [MXHQ87WJ3000](#) [PK2-5MM-102](#) [382254](#) [TAS90](#) [VL1735/45](#) [973368100](#) [972327100](#) [972327101](#) [973995100](#) [973995101](#) [CT3982B-120](#) [CT4386](#) [PP023-1](#) [PK1-5MM-125](#) [PK1-5MM-127](#) [PP026-1](#) [P6139B-PK10](#) [PQ215](#) [PQ219](#) [PQ218](#) [GE.3421](#) [GE.3121](#) [GE.1511](#) [GE.1521](#) [GE.2511](#) [HVP15B](#) [TT-SI7002](#) [4005](#) [4011](#) [4013](#) [4014](#) [4015](#) [4016](#) [4018](#) [P TK-100](#) [P TK-250/100](#) [UTH05](#) [402-IEC-RT](#) [402-IEC-SW](#)