

Test Probes 4 mm Safety System



CE



CE



Type

PRUEF 2600 C2

Test probe shatter - proof insulating sleeve and slender stainless steel tip. Tip for penetration of insulation and oxide layers. 4mm diameter brass socket connection. Connection with safety measuring leads. Accessory (optional): protector and IC - tap SS 260

SS 260

Tip protection and IC tap. Clipping onto the PRUEF 2, PRUEF 2 S and PRUEF 2600 C2 test probe covers the needle tip and provides protection against injury. Contact is made with ICs without short circuiting or slipping off.

PRUEF 2610 FT

Test probe with insulated sleeve and slender, sprung stainless steel tip. This allows a constant pressure to be applied without the tip slipping off the component, even in the smallest measuring points. 4 mm diameter brass socket connection.

Tip diameter

2 mm (0.079 in.)

-

0.75 mm (0.029 in.)

PART NO. / Housing color

972327100 ●
972327101 ●

973865001 ○

972318100 ●
972318101 ●

Technical Data

Connection Type	stationary tip
Voltage Rating	fixed socket Ø 4 mm
Measurement Category (IEC61010)	AC/DC 1000V
Current Rating*	CAT II
Contact Resistance	1 A
Material Specifications	50 mOhm
Tip	stainless steel
Connection pin/ socket	nickel plated brass
Contact Spring	-
Housing	PP
Environmental Conditions	
Temperature range	-20°C to +60°C (-4°F to 140°F)
Flamability Rating	
Housing	UL 94 HB

-
-
-
-
-
-
-
-
-
-
-
-
-

Connection Type	spring-loaded tip
Voltage Rating	fixed socket Ø 4 mm
Measurement Category (IEC61010)	AC/DC 1000 V
Current Rating*	CAT II
Contact Resistance	1 A
Material Specifications	50 mOhm
Tip	stainless steel
Connection pin/ socket	nickel plated brass
Contact Spring	-
Housing	PP
Environmental Conditions	
Temperature range	-25 °C to +80 °C (13°F to 176°F)
Flamability Rating	
Housing	UL 94 HB

Drawing

Measurements are shown in millimeters.
Multiply by 0.03937 to convert to inches.

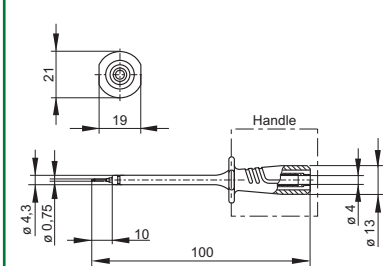
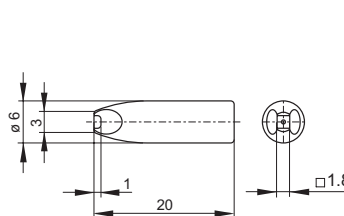
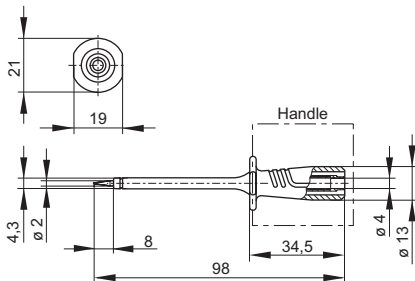

* Please consider derating graph on page 80.

X-ON Electronics

Largest Supplier of Electrical and Electronic Components

Click to view similar products for [Test Probes](#) category:

Click to view products by [Altech](#) manufacturer:

Other Similar products are found below :

[6214](#) [6265](#) [6474](#) [815003](#) [923832-BK-B](#) [P-KIT-1](#) [R941850000](#) [925250-R](#) [72923-2](#) [923848-C](#) [973368101](#) [972318101](#) [972318100](#)
[MXHQ87WJ3000](#) [66.9115-23](#) [850182](#) [TAS90](#) [VL1735/45](#) [973368100](#) [972327100](#) [972327101](#) [975017700](#) [975018700](#) [973995100](#)
[973995101](#) [100039-080-958](#) [CT3986B-120](#) [CT3987B-120](#) [CT3983B-120](#) [CT3979B-150](#) [CT3981B-120](#) [CT3985B-120](#) [402-IEC-RT](#) [402-](#)
[IEC-SW](#) [404-IEC-RT](#) [AX-CP-01-SET](#) [AX-CP-05-B](#) [AX-CP-05-R](#) [464-IEC-NEEDLE13/0,6-RT](#) [464-IEC-NEEDLE13/0,6-SW](#) [464-IEC-RT](#)
[464-IEC-SW](#) [00043](#) [404-IEC-SW](#) [00125](#) [1445](#) [MPS1RT](#) [0602 4592](#) [0602 4892](#) [0628 0020](#)