

Test Jacks 4 mm System

Type	SEP 2610 F4,8	SEP 2620 F6,3	SEP 2630 S1,9
	 	 	 
	Safety press-in socket, 4 mm diameter, contact-protected, with 4.8 x 0.8 tab connector complying with DIN 46 244, gold-plated brass. For rapid installation into switch panels with wall thicknesses between 1-10 mm. Installation hole: 12.2 +/- 0.1 mm diameter. Entry chamfer: 0.5 x 45 degree.	Safety press-in socket, 4 mm diameter, contact-protected, with 6.3 x 0.8 tab connector complying with DIN 46244, gold-plated brass. For rapid installation into switch panels with wall thicknesses between 1-10 mm. Installation hole: 12.2 +/- 0.1 mm diameter. Entry chamfer: 0.5 x 45 degree.	Gold-plated brass safety press-in socket, 4 mm diameter, contact-protected, with 1.9 mm soldering spike. For installation into switch panels with wall thicknesses between 1 mm and 10 mm. Installation hole: 12.2 +/- 0.1 mm diameter. Entry chamfer: 0.5 x 45 degree.
Pin Diameter	2 mm	2 mm	2 mm
PART NO. / Housing color	<ul style="list-style-type: none"> ● 972361100 ● 972361101 ● 972361102 ● 972361103 ● 972361104 ● 972361188 	<ul style="list-style-type: none"> ● 972362100 ● 972362101 ● 972362102 ● 972362103 ● 972362104 ● 972362188 	<ul style="list-style-type: none"> ● 972363100 ● 972363101 ● 972363102 ● 972363103 ● 972363104 ● 972363188

Technical Data		jack Ø 4 mm	jack Ø 4 mm	jack Ø 4 mm
Contact Type	jack Ø 4 mm	jack Ø 4 mm	jack Ø 4 mm	jack Ø 4 mm
Connection Type	flat 4.8 x 0.8 mm tab	flat 6.3 x 0.8 mm tab	flat 6.3 x 0.8 mm tab	solder pin 1.9mm
Voltage Rating	AC/DC 1000 V	AC/DC 1000 V	AC/DC 1000 V	AC/DC 1000V
Measurement Category (IEC61010)	CAT III	CAT III	CAT III	CAT III
Current Rating*	24 A	32 A	32 A	24 A
Contact Resistance	5 mOhm	5 mOhm	5 mOhm	5 mOhm
Mounting Type	press in	press in	press in	press in
Material Specifications				
Jack Body	gold plated brass	gold plated brass	gold plated brass	gold plated brass
Contact Spring	-	-	-	-
Housing	PA	PA	PA	PA
Environmental Conditions				
Temperature Range	-40°C to +80°C (-40 to 176°F)	-40°C to +80°C (-40 to 176°F)	-40°C to +80°C (-40 to 176°F)	-40°C to +80°C (-40 to 176°F)
Flamability Rating				
Housing	UL 94 V-2	UL 94 V-2	UL 94 V-2	UL 94 V-2

Drawing

Measurements are shown in millimeters.
Multiply by 0.03937 to convert to inches.

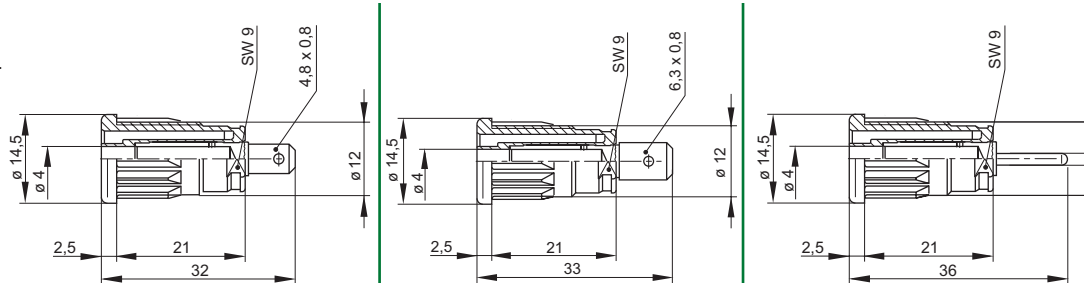

* Please consider derating graph on page 80.

X-ON Electronics

Largest Supplier of Electrical and Electronic Components

Click to view similar products for [Test Sockets](#) category:

Click to view products by [Altech](#) manufacturer:

Other Similar products are found below :

[AXS-5032-04-02](#) [AXS-3225-04-06](#) [AXS-7050-04-12](#) [5662](#) [BP30-10-B](#) [BP30GNN-1 PKG](#) [BP30-10Y-1 PKG](#) [AXS-7050-04-01](#) [AXS-5032-04-06](#) [AXS-2520-04-01](#) [AXS-5032-04-04](#) [972361101](#) [972361100](#) [930308100](#) [931714100](#) [931714101](#) [930308104](#) [66.9328-25](#) [563-0100](#) [563-0500](#) [551-0700](#) [563-0300](#) [563-0600](#) [563-0700](#) [5281](#) [5279](#) [571-0300](#) [572-0200](#) [572-0400](#) [AXS-7550-06-03](#) [2713BB](#) [295-103](#) [571-0200](#) [571-0400](#) [571-0600](#) [934097102](#) [1458-103](#) [AXS-1147-02-02](#) [AXS-2520-04-08](#) [AXS-3030-06-03](#) [AXS-3215-02-01](#) [AXS-3215-02-05](#) [AXS-3838-08-01](#) [AXS-5032-04-12](#) [930320100](#) [CL159701](#) [551-0100](#) [551-0200](#) [551-0400](#) [551-0500](#)