

Test Plugs 4 mm System



Type

LAS 30 / LAS 30 Au

4mm spring loaded plug, nickel/ gold plated contact spring, solder terminal up 1.5mm².

Pin diameter

4 mm (0.157")

PART NO. / Housing color

- | Nickel Plated | Gold Plated |
|---------------|-------------|
| ● 972518100 | ● 972518700 |
| ● 972518101 | ● 972518701 |
| ● 972518102 | ● 972518702 |
| ● 972518103 | ● 972518703 |
| ● 972518104 | ● 972518704 |



BUELA 20 K

4mm multi spring plug, flexible, insulated sleeve with 4mm cross hole, nickel plated brass, screw terminal max. 1.5mm².

4 mm (0.157")

- 930726100
- 930726101
- 930726102
- 930726103
- 930726104
- 930726107

Technical Data

Contact Type: spring loaded pin
 Connection Type: solder terminal max. 1.5mm²
 Voltage Rating: 30 VAC / 60 VDC
 Measurement Category (IEC61010): CAT I
 Current Rating*: 32A
 Contact Resistance: 3 mOhm

Material Specifications

Plug: nickel plated brass; gold plated brass
 Contact Spring: nickel pl. copper-beryllium; gold pl. copper-beryllium
 Housing: PVC-P

Environmental Conditions

Temperature range: -25 °C to +70°C (-13 to 158°F)

Flamability Rating

Housing: -

Contact Type: spring loaded pin
 Connection Type: screw terminal max. 1.5mm²
 Voltage Rating: 30 VAC / 60 VDC
 Measurement Category: CAT I
 Current Rating: 16A
 Contact Resistance: 3 mOhm

Plug: nickel plated brass
 Contact Spring: -
 Housing: PVC-P

Temperature range: -25 °C to +70°C (-13 to 158°F)

Housing: -

Drawing

Measurements are shown in millimeters.
 Multiply by 0.03937 to convert to inches.

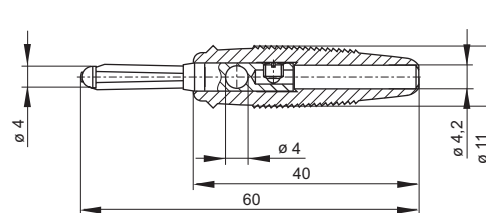
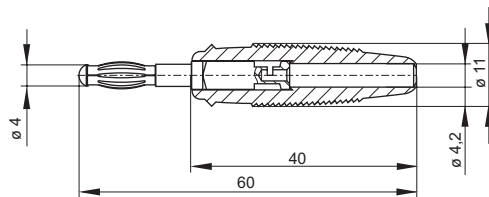

* Please consider derating graph on page 80.

X-ON Electronics

Largest Supplier of Electrical and Electronic Components

Click to view similar products for [Test Plugs & Test Jacks](#) category:

Click to view products by [Altech](#) manufacturer:

Other Similar products are found below :

[01-2601-4-0210](#) [01-2601-4-0212](#) [01-2604-4-0212](#) [01-2604-5-0210](#) [01-2150-1-0312](#) [01-2350-1-02](#) [01-2352-1-02](#) [01-2368-1-02](#) [01-2604-4-0210](#) [01-2604-5-0212](#) [01-2606-4-0210](#) [01-2606-4-0212](#) [01-2606-5-0212](#) [M39024/10-01G](#) [M39024/10-17G](#) [M39024/11-09G](#) [M39024/11-42](#) [M39024/11-43](#) [M39024/12-08](#) [707-5311](#) [707-5402-01-19](#) [707-5410](#) [923739-40-I](#) [R644543000](#) [R948161000](#) [R999351000](#) [1408-4](#) [1499-101](#) [1533-1](#) [1659559](#) [1659567](#) [1663921](#) [1663939](#) [1696-102](#) [174-R825B-EX](#) [NYS508-BU](#) [NYS508-O](#) [211-101](#) [RS100GBL](#) [RS250GBL](#) [251-102](#) [25-2251-2-03](#) [25-2259-2-03](#) [923743-16-I](#) [923743-24-I](#) [923743-28-I](#) [2854-BLU](#) [2970-BLK](#) [30-443G](#) [1680](#)