

# Clamp-type Test Probe 2 mm system



## KLEPS 1600

Safety clamp-type test probe with rotating grip jaws and flexible shaft. Wires and pins with up to a maximum diameter of 4 mm can be clamped thanks to the special form of the grip jaws. 4 mm diameter brass socket connection.

### Type

Clamping range 3 mm  
Clamp type rotating grip jaws

**PART NO. / Housing color**  
975106100 ●  
975106101 ●



## KLEPS 30

Clamp-type test probe with rotating grip jaws and flexible shaft. The special form of the grip jaws allows clamping of pins and wires up to a maximum of 4 mm diameter. 4 mm diameter brass socket connection with side screw, grip jaws additionally nickel-plated.

Clamping range 4 mm  
Clamp type rotating grip jaws

**PART NO. / Housing color**  
930113100 ●  
930113101 ●

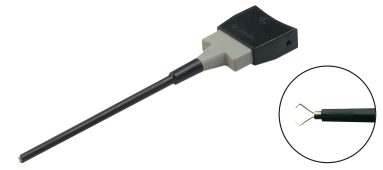

## KLEPS 60

Clamp-type test probe grip jaws and flexible shaft. The special form of the grip jaws permits clamping of pins and wires up to a maximum of 4 mm diameter. 4 mm diameter brass socket connection with additional screw connection, grip jaws additionally nickel-plated.

Clamping range 4 mm  
Clamp type rotating grip jaws

**PART NO. / Housing color**  
973053100 ●  
973053101 ●

### Technical data

Type of termination	socket Ø2 mm	socket Ø 4 mm, screw	socket Ø 4 mm, screw
Rated voltage	AC/DC 1000V	30 VAC / 60 VDC	30 VAC / 60 VDC
Measurement cat. acc. to IEC61010	CAT III	CAT I	CAT I
Rated current*	3 A	4 A	4 A
Contact resistance	50 mOhm	50 mOhm	50 mOhm
Certificate	CE		

### Material Specifications

Contact material	grip jaw: spring steel, socket: brass	grip jaw: spring steel, socket: brass	grip jaw: spring steel, socket: brass
Contact surface material	grip jaws: nickel, socket: gold	grip jaws: nickel	grip jaws: nickel
Housing material	PA	PF	PP, PS

### Environmental conditions

Temperature range	-25 °C to +70 °C	-25 °C to +80 °C	-25 °C to +60 °C
-------------------	------------------	------------------	------------------

### Inflamability class

Housing (basic material)	UL 94 V-2	UL 94 V-0	UL 94 HB
--------------------------	-----------	-----------	----------

### Drawing

Measurements are shown in millimeters.  
Multiply by 0.03937 to convert to inches.

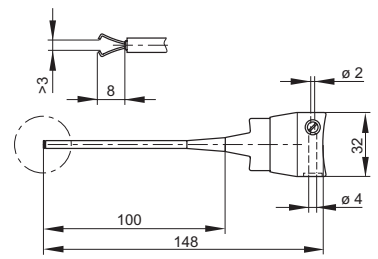
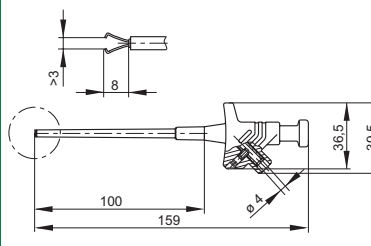
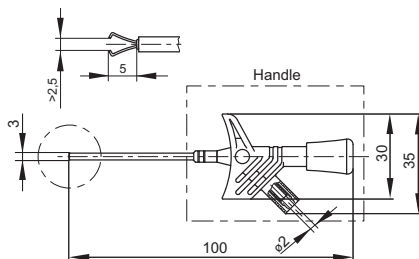

## X-ON Electronics

Largest Supplier of Electrical and Electronic Components

*Click to view similar products for [Test Probes](#) category:*

*Click to view products by [Altech](#) manufacturer:*

Other Similar products are found below :

[6214](#) [6474](#) [815003](#) [923832-BK-B](#) [P-KIT-1](#) [KT-MS001](#) [925250-R](#) [923848-C](#) [973368101](#) [972318101](#) [972318100](#) [MXHQ87WJ3000](#) [PK2-5MM-102](#) [382254](#) [TAS90](#) [VL1735/45](#) [973368100](#) [972327100](#) [972327101](#) [973995100](#) [973995101](#) [CT3982B-120](#) [CT4386](#) [PP023-1](#) [PK1-5MM-125](#) [PK1-5MM-127](#) [PP026-1](#) [P6139B-PK10](#) [PQ215](#) [PQ219](#) [PQ218](#) [GE.3421](#) [GE.3121](#) [GE.1511](#) [GE.1521](#) [GE.2511](#) [HVP15B](#) [TT-SI7002](#) [4005](#) [4011](#) [4013](#) [4014](#) [4015](#) [4016](#) [4018](#) [P TK-100](#) [P TK-250/100](#) [UTH05](#) [402-IEC-RT](#) [402-IEC-SW](#)