

# Clamp-type Test Probe 2 mm system



## KLEPS 1600

Safety clamp-type test probe with rotating grip jaws and flexible shaft. Wires and pins with up to a maximum diameter of 4 mm can be clamped thanks to the special form of the grip jaws. 4 mm diameter brass socket connection.

### Type

Clamping range 3 mm  
Clamp type rotating grip jaws

**PART NO. / Housing color**  
975106100 ●  
975106101 ●



## KLEPS 30

Clamp-type test probe with rotating grip jaws and flexible shaft. The special form of the grip jaws allows clamping of pins and wires up to a maximum of 4 mm diameter. 4 mm diameter brass socket connection with side screw, grip jaws additionally nickel-plated.

Clamping range 4 mm  
Clamp type rotating grip jaws

**PART NO. / Housing color**  
930113100 ●  
930113101 ●

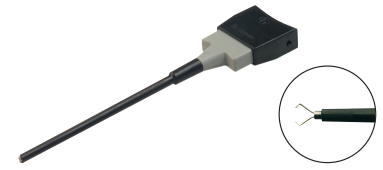

## KLEPS 60

Clamp-type test probe grip jaws and flexible shaft. The special form of the grip jaws permits clamping of pins and wires up to a maximum of 4 mm diameter. 4 mm diameter brass socket connection with additional screw connection, grip jaws additionally nickel-plated.

Clamping range 4 mm  
Clamp type rotating grip jaws

**PART NO. / Housing color**  
973053100 ●  
973053101 ●

### Technical data

Type of termination	socket Ø2 mm	socket Ø 4 mm, screw	socket Ø 4 mm, screw
Rated voltage	AC/DC 1000V	30 VAC / 60 VDC	30 VAC / 60 VDC
Measurement cat. acc. to IEC61010	CAT III	CAT I	CAT I
Rated current*	3 A	4 A	4 A
Contact resistance	50 mOhm	50 mOhm	50 mOhm
Certificate	CE		

### Material Specifications

Contact material	grip jaw: spring steel, socket: brass	grip jaw: spring steel, socket: brass	grip jaw: spring steel, socket: brass
Contact surface material	grip jaws: nickel, socket: gold	grip jaws: nickel	grip jaws: nickel
Housing material	PA	PF	PP, PS

### Environmental conditions

Temperature range	-25 °C to +70 °C	-25 °C to +80 °C	-25 °C to +60 °C
-------------------	------------------	------------------	------------------

### Inflammability class

Housing (basic material)	UL 94 V-2	UL 94 V-0	UL 94 HB
--------------------------	-----------	-----------	----------

### Drawing

Measurements are shown in millimeters.  
Multiply by 0.03937 to convert to inches.

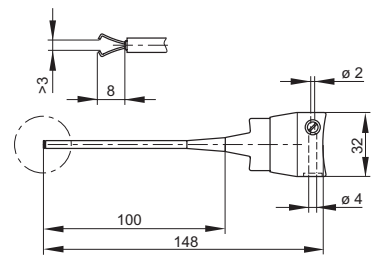
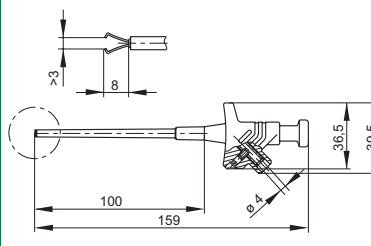
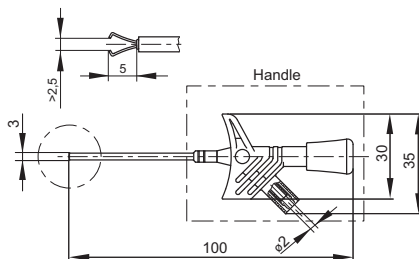

## X-ON Electronics

Largest Supplier of Electrical and Electronic Components

*Click to view similar products for [Test Probes](#) category:*

*Click to view products by [Altech](#) manufacturer:*

Other Similar products are found below :

[6214](#) [6265](#) [6474](#) [815003](#) [923832-BK-B](#) [P-KIT-1](#) [R941850000](#) [925250-R](#) [72923-2](#) [923848-C](#) [973368101](#) [972318101](#) [972318100](#)  
[MXHQ87WJ3000](#) [66.9115-23](#) [850182](#) [TAS90](#) [VL1735/45](#) [973368100](#) [972327100](#) [972327101](#) [975017700](#) [975018700](#) [973995100](#)  
[973995101](#) [100039-080-958](#) [CT3986B-120](#) [CT3987B-120](#) [CT3983B-120](#) [CT3979B-150](#) [CT3981B-120](#) [CT3985B-120](#) [402-IEC-RT](#) [402-](#)  
[IEC-SW](#) [404-IEC-RT](#) [AX-CP-01-SET](#) [AX-CP-05-B](#) [AX-CP-05-R](#) [464-IEC-NEEDLE13/0,6-RT](#) [464-IEC-NEEDLE13/0,6-SW](#) [464-IEC-RT](#)  
[464-IEC-SW](#) [00043](#) [404-IEC-SW](#) [00125](#) [1445](#) [MPS1RT](#) [0602 4592](#) [0602 4892](#) [0628 0020](#)