

Pin Spacing: 7.50mm  
 Orientation: Horizontal Header  
 Clamp Type: –  
 Design: Single Mold - Closed End

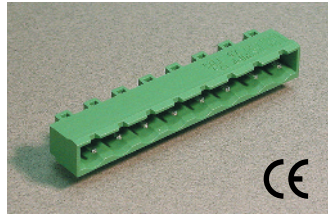

**PHPxx-7.50**

**ELECTRICAL**

|  | Current | Voltage | Wire Range |
|--|---------|---------|------------|
|  | 12A     | 300V    | –          |
|  | 16A     | 750V    | –          |

**INSTALLATION DATA**

|            |   |                 |       |
|------------|---|-----------------|-------|
| Screw Size | – | PCB Hole Size   | 1.5mm |
| Torque     | – | Stripping Lgth. | –     |

**MATERIAL**

|                    |                       |          |                  |
|--------------------|-----------------------|----------|------------------|
| Body               | Polyamide             | Screw    | –                |
| Flammability Class | UL94V-0               | Terminal | Tin-Plated Brass |
| Temperature Limit  | 105°C UL<br>125°C IEC | Clamp    | –                |
| Color              | Green                 |          |                  |

| No. Poles | Cat. #     | Length (mm) | Std. Pk. |
|-----------|------------|-------------|----------|
| 2         | PHP02-7.50 | 17.0        | 100      |
| 3         | PHP03-7.50 | 24.5        | 100      |
| 4         | PHP04-7.50 | 32.0        | 50       |
| 5         | PHP05-7.50 | 39.5        | 50       |
| 6         | PHP06-7.50 | 47.0        | 50       |
| 7         | PHP07-7.50 | 54.5        | 50       |
| 8         | PHP08-7.50 | 62.0        | 50       |
| 9         | PHP09-7.50 | 69.5        | 50       |
| 10        | PHP10-7.50 | 77.0        | 50       |
| 11        | PHP11-7.50 | 84.5        | 20       |
| 12        | PHP12-7.50 | 92.0        | 20       |
| 13        | PHP13-7.50 | 99.5        | 20       |
| 14        | PHP14-7.50 | 107.0       | 20       |
| 15        | PHP15-7.50 | 114.5       | 20       |
| 16        | PHP16-7.50 | 122.0       | 20       |

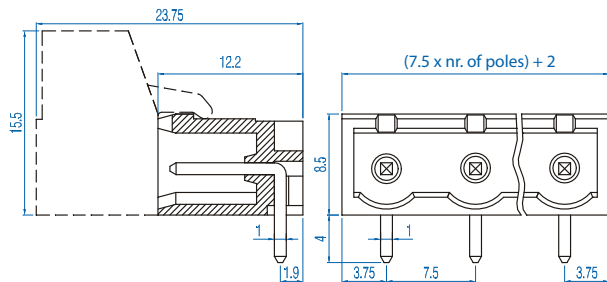

## X-ON Electronics

Largest Supplier of Electrical and Electronic Components

*Click to view similar products for [Pluggable Terminal Blocks](#) category:*

*Click to view products by [Altech](#) manufacturer:*

Other Similar products are found below :

[57.510.0053](#) [MC 1.5/ 6-ST-3.5 GY AU](#) [734-104](#) [734-302](#) [8-141-P](#) [8426620000](#) [860505](#) [860810](#) [GBPACX-12](#) [93.731.4953.0](#) [PV05-5,08-K](#)  
[PVP04-3,50](#) [PVS02-5,00](#) [1-1986160-3](#) [1377680000](#) [1531000000](#) [1546228-5](#) [ELFH16150](#) [ELFP03110](#) [ELFP10210](#) [ELFT06250](#)  
[ELVP03100](#) [1700410](#) [1700425](#) [1702246](#) [1717806](#) [1719600](#) [1734692](#) [1734795](#) [1740291](#) [1752441](#) [1752865](#) [1754144](#) [1760051](#) [1760336](#)  
[1777701](#) [1783410](#) [1800227](#) [1801080](#) [1836888](#) [1848818](#) [1849079](#) [1860870](#) [1876327](#) [1896417](#) [1903096](#) [19346](#) [1946309](#) [1970579](#) [1973592](#)