

NOTES:

1. MATERIALS AND FINISHES:
 HD-BNC STR CRIMP PLUG - 34-1017-300
 1.0/2.3 PUSH-PULL CRIMP PLUG - 282137-75
 CABLE - BELDEN 1694A

2. ELECTRICAL:
 A. IMPEDANCE: 75 OHM

3. PACKAGING:
 A. QUANTITY: SINGLE PACK
 B. MARKING: BAG TO BE MARKED
 "AMPHENOL RF, 95-850-157XXXX, AND DATE CODE"

THIRD ANGLE PROJ.

REVISIONS

REV	DESCRIPTION	DATE	ECO	APPR
A	RELEASE TO MFG.	5/15/15	50350	NR/BCG

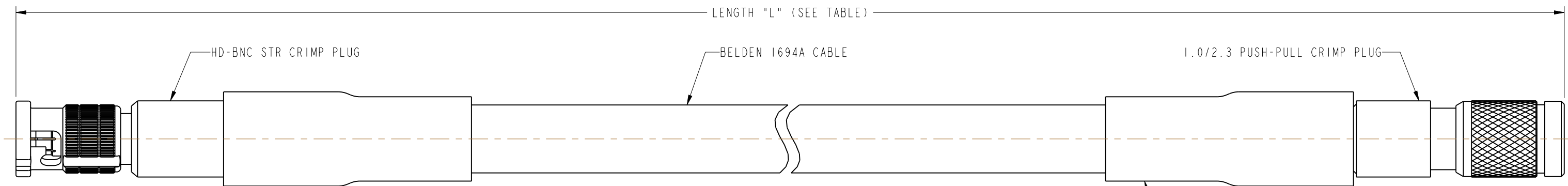

1.00±0.10
TYP(2)

LENGTH TABLE		
PART NUMBER (IMPERIAL)	PART NUMBER (METRIC)	LENGTH "L" IN INCHES [METERS]
95-850-157-006	-	6.00 [0.152]
	95-850-157M025	9.84 [0.250]
95-850-157-012	-	12.00 [0.305]
95-850-157-018	-	18.00 [0.457]
	95-850-157M050	19.69 [0.500]
95-850-157-024	-	24.00 [0.610]
	95-850-157M075	29.53 [0.750]
95-850-157-036	-	36.00 [0.914]
	95-850-157M100	39.37 [1.000]
95-850-157-048	-	48.00 [1.219]
	95-850-157M125	49.21 [1.250]
	95-850-157M150	59.06 [1.500]
95-850-157-060	-	60.00 [1.524]
95-850-157-072	-	72.00 [1.829]
	95-850-157M200	78.74 [2.000]
	95-850-157M300	118.11 [3.000]
95-850-157-120	-	120.00 [3.048]
95-850-157-180	-	180.00 [4.572]
	95-850-157M500	196.85 [5.000]
95-850-157-300	-	300.00 [7.620]
	95-850-157M10L	393.70 [10.000]
95-850-157L050	-	600.00 [15.240]
	95-850-157M20L	787.40 [20.000]
95-850-157L075	-	900.00 [22.860]
	95-850-157M30L	1181.10 [30.000]
95-850-157L100	-	1200.00 [30.480]

HEAT SHRINK TUBE
TYP(2)

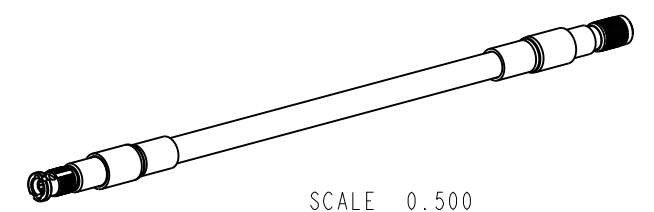

SCALE 0.500

DESIGN REQUIREMENTS:

<input checked="" type="checkbox"/> FREQUENCY DC TO 4 GHz	<input checked="" type="checkbox"/> CONTINUITY
<input type="checkbox"/> VSWR: _____ MAX	<input checked="" type="checkbox"/> HI-POT : 500 VRMS
<input type="checkbox"/> INS. LOSS _____ dB MIN	<input type="checkbox"/> OTHER

CUSTOMER OUTLINE DRAWING
 ALL OTHER SHEETS ARE FOR INTERNAL USE ONLY

UNLESS OTHERWISE SPECIFIED, DIMENSIONS ARE IN INCHES AND TOLERANCES ARE: 2 PLACE DECIMAL 3 PLACE DECIMAL ±.015 (0.381 mm) ±.005 (0.127 mm)	MATERIAL	DRAWN	DATE	TITLE HD-BNC STR CRIMP PLUG TO 1.0/2.3 PUSH-PULL CRIMP PLUG, USING BELDEN 1694A CABLE, VARIOUS LENGTH	Amphenol RF www.amphenolrf.com
	SEE NOTES	KARTHIK R	09-Dec-14		
NOTICE - These drawings, specifications, or other data (1) are, and remain the property of Amphenol corp. (2) must be returned upon request; and (3) are confidential and not to be disclosed to any person other than those to whom they are given by Amphenol Corp. the furnishing of these drawings, specifications, or other data by Amphenol Corp., or to any other person to anyone for any purpose is not to be regarded by implication or otherwise in any manner licensing, granting rights to permitting such holder or any other person to manufacture, use or sell any product, process or design, patented or otherwise, that may in any way be related to or disclosed by said drawings, specifications, or other data.	REFERENCE	ENGINEER	DATE	SCALE: 2.5:1.0 SHEET 2 OF 2	DRAWING NO.95-850-157XXXX ITEM NO.95-850-157XXXX
	EAR # 6515	KARTHIK R	09-Dec-14		
	CONFIGURATION LEVEL: In Work	APPROVED	DATE		DWG SIZE
FINISH	K. CAPOZZI	5/7/15		B	A
					PART NO.95-850-157XXXX

X-ON Electronics

Largest Supplier of Electrical and Electronic Components

Click to view similar products for [RF Cable Assemblies](#) category:

Click to view products by [Amphenol](#) manufacturer:

Other Similar products are found below :

[73-6352-10](#) [73-6353-3](#) [73-6364-6](#) [R285001001](#) [R288940004](#) [R288940005](#) [145111-05-12.00](#) [1661-C-24](#) [1801171170914KE](#) [24P104C24J1-012](#) [24P104C24P1-006](#) [24P104C24P1-018](#) [24P204C24J1-003](#) [172-2150-EX](#) [1800920920914PJ](#) [FCB-3030-ALT](#) [21117-046](#) [21117-050](#) [PCX-24-50](#) [24P103C24P2-003](#) [25P203C25P2-003](#) [PTWY-24-78](#) [R284008001](#) [R285001021](#) [R285426000](#) [R288940003](#) [R288940008](#) [RF179-74BJ3-77RP1-0305](#) [4814-BB-24](#) [5260-72](#) [JT2N1-CL1-1F](#) [DLP-COAX1](#) [4814-K-48](#) [115101-09-06.00](#) [CCNTN2-MM-LL335-26](#) [73-6351-25](#) [73-6352-3](#) [73-6353-25](#) [1800920920610PJ](#) [GD0BQ0BQ024.0](#) [1-3636-600-5210](#) [TL8A-11SMA-11SMA-01500-51](#) [R284C0351060](#) [R288940009](#) [R284C0351028](#) [R288940002](#) [9702-1SL-1](#) [PT82NSMA](#) [73-6353-10](#) [R285020301W](#)