

NOTES:

1. MATERIALS AND FINISHES:

SMA JACK:
 BODY, HOUSING: BRASS, GOLD PLATING,
 CONTACT: BERYLLIUM COPPER, GOLD PLATING.
 INSULATOR: PTFE, NATURAL
 AMC PLUG: PHOSPHOR BRONZE, SILVER, AND GOLD PLATING
 CABLE: 1.13MM MICRO-COAX

2. ELECTRICAL:

A. IMPEDANCE: 50 OHMS
 B. FREQUENCY RANGE: DC - 3 GHz
 C. VSWR: 1.21:1 MAX @ DC - 3 GHz
 D. DIELECTRIC WITHSTANDING VOLTAGE: 200 VRMS, MIN.

3. PACKAGING:

A. QUANTITY: SINGLE PACK
 B. MARKING: BAG TO BE MARKED
 "AMPHENOL RF, 95-902-492-XXX, AND DATE CODE"

4. AMC IS INTERMATABLE WITH U.FL.

THIRD ANGLE PROJ.

REVISIONS

REV	DESCRIPTION	DATE	ECN	APPR
A	RELEASE TO MFG.	21-Jun-18	8402	NB



SCALE 2.000

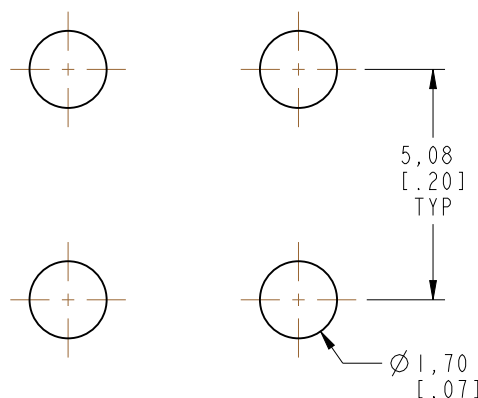
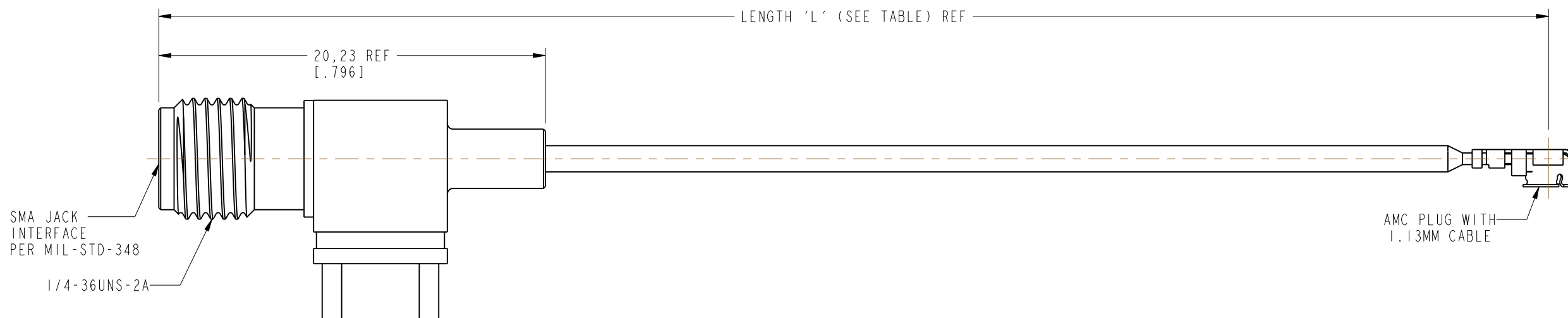

**RECOMMENDED
 PCB MOUNTING HOLE**

95-902-492-300	300.00 [11.81]
95-902-492-250	250.00 [9.84]
95-902-492-200	200.00 [7.87]
95-902-492-150	150.00 [5.91]
95-902-492-100	100.00 [3.94]
95-902-492-050	50.00 [1.97]
PART NUMBER	LENGTH IN MM (INCHES)

CUSTOMER OUTLINE DRAWING

ALL OTHER SHEETS ARE FOR INTERNAL USE ONLY

UNLESS OTHERWISE SPECIFIED, DIMENSIONS ARE IN METRIC AND TOLERANCES ARE:
 <math><0.5\text{mm}</math> $0.5 - 6\text{mm}$ $6 - 30\text{mm}$ $30 - 120\text{mm}$ ANGLES
 $\pm 0.05\text{mm}$ $\pm 0.1\text{mm}$ $\pm 0.2\text{mm}$ $\pm 0.3\text{mm}$ $\pm 1^\circ$

NOTICE - These drawings, specifications, or other data (1) are, and remain the property of Amphenol corp. (2) must be returned upon request; and (3) are confidential and not to be disclosed to any person other than those to whom they are given by Amphenol Corp. the furnishing of these drawings, specifications, or other data by Amphenol Corp., or to any other person to anyone for any purpose is not to be regarded by implication or otherwise in any manner licensing, granting rights to permitting such holder or any other person to manufacture, use or sell any product, process or design, patented or otherwise, that may in any way be related to or disclosed by said drawings, specifications, or other data.

MATERIAL	SEE NOTES
REFERENCE	EAR# 8413 REF: 95-902-44847
CONFIGURATION LEVEL:	In Work
FINISH	

DRAWN	N.BUDRIS	DATE	11-Jun-18
ENGINEER	N.BUDRIS	DATE	11-Jun-18
APPROVED	K.CAPOZZI	DATE	21-Jun-18
CAD FILE			

TITLE		CABLE ASSY, SMA JACK TO AMC 1.13 CABLE	
SCALE:	4.0:1.0	SHEET 2 OF 2	
DWG SIZE	B	REV	A

Amphenol RF	
www.amphenolrf.com	
DRAWING NO.	95-902-492-XXX
ITEM NO.	95-902-492-XXX
PART NO.	95-902-492-XXX

X-ON Electronics

Largest Supplier of Electrical and Electronic Components

Click to view similar products for [RF Cable Assemblies](#) category:

Click to view products by [Amphenol](#) manufacturer:

Other Similar products are found below :

[73-6352-10](#) [73-6353-3](#) [73-6364-6](#) [R285001001](#) [R288940004](#) [R288940005](#) [145111-05-12.00](#) [1661-C-24](#) [1801171170914KE](#) [24P104C24J1-012](#) [24P104C24P1-006](#) [24P104C24P1-018](#) [24P204C24J1-003](#) [172-2150-EX](#) [1800920920914PJ](#) [FCB-3030-ALT](#) [21117-046](#) [21117-050](#) [PCX-24-50](#) [24P103C24P2-003](#) [25P203C25P2-003](#) [PTWY-24-78](#) [R284008001](#) [R285001021](#) [R285426000](#) [R288940003](#) [R288940008](#) [RF179-74BJ3-77RP1-0305](#) [4814-BB-24](#) [5260-72](#) [JT2N1-CL1-1F](#) [DLP-COAX1](#) [4814-K-48](#) [115101-09-06.00](#) [CCNTN2-MM-LL335-26](#) [73-6351-25](#) [73-6352-3](#) [73-6353-25](#) [1800920920610PJ](#) [GD0BQ0BQ024.0](#) [1-3636-600-5210](#) [TL8A-11SMA-11SMA-01500-51](#) [R284C0351060](#) [R288940009](#) [R284C0351028](#) [R288940002](#) [9702-1SL-1](#) [PT82NSMA](#) [73-6353-10](#) [R285020301W](#)