

PRODUCT NO.
10074141-001LF
10074141-003LF

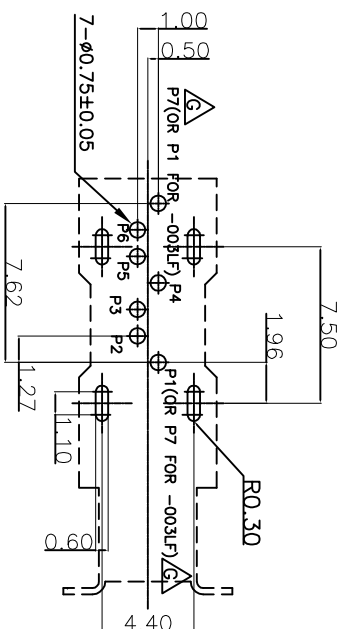

PDFfill PDF Editor with Free Writer and Tools

RECOMMEND P.C.B. BOARD LAYOUT
PCB TOLERANCE: ±0.05

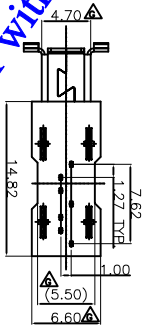
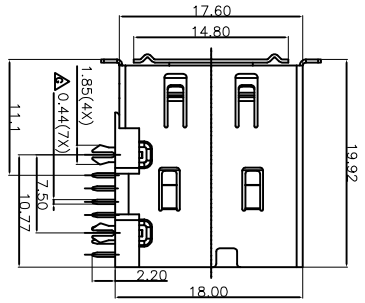
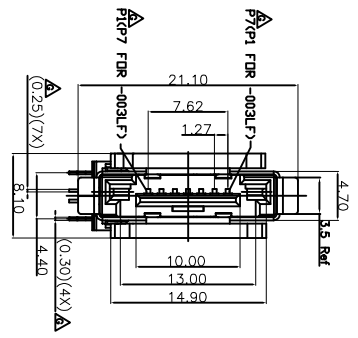
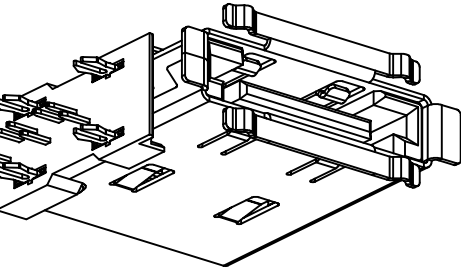

PIN DEFINITION

ESATA	NAME	TYPE
P1	GND	GND
P2	A+	A+
P3	A-	A-
P4	GND	GND
P5	B-	B-
P6	B+	B+
P7	GND	GND

mat'l. code	14	surface	ISO 1302	tolerance	ISO 406	ISO 100	projection	product family	533
lfr	ecm no	dr	date	ISO 1302	tolerance unless otherwise specified	ISO 100	projection	product family	533
A	107-1074S	LIN	2007-05-23	angles	.XX±0.25	MM		E-SATA_UP_RIGHT	
B	108-1082S	LIN	2008-04-28	linear	.XX±0.25	MM		DIP_TYPE	
C	110-0184S	LIN	2010-12-14	σ±Z	.XXX±0.100	scale 2:1			
D	T-00544QS	LIN	2011-08-31	STERLING	LIN	2007-05-21			
E	EX-S-00781	HKL	2011-10-17	ENG	HKLIM	2016-03-03			
F	EX-S-01181	HKL	2012-06-08	CH	HKLIM	2016-03-03			
G	EX-S-23401	HKL	2016-03-03	DPD	KPTAY	2016-03-03			
Sheet	Revision	G	G	G	107109	111113	115117	119121	123125
Index	Sheet	1	2	3	106108	110112	114116	118120	122124
					126128	130132	134136	138139	

- NOTES:
1. MATERIAL: HOUSING: THERMAL PLASTIC HIGH TEMP WITH 30% G/F U94 V-0
 2. FINISH: 500" MIN. NICKEL UNDERPLATING OVER ALL SHELL/BOARD LOOK: 500" MIN. NICKEL PLATING OVER ALL IN A WAVE SOLDER APPLICATION WITH A 1.6MM PCB
 3. THE HOUSING WILL WITHSTAND TO 280C FOR 10 SEC
 4. PRODUCT SPEC: GS-12-386
 5. PACKING SPEC: GS-14-1109
 6. A SYMBOL Δ WILL BE NEXT TO ANY DIMENSION, VIEW OR NOTE WHICH HAS BEEN MODIFIED WITH THE CURRENT DRAWING REVISION
- PACKING: TRAY PACKING
BLANK: TRAY PACKING
1. 150" GOLD PLATING
2. 2 G/F GOLD PLATING
3. 150" GOLD PLATING WITH NEW PINOUT ASSIGNMENT
- 0: LAYOUT?!

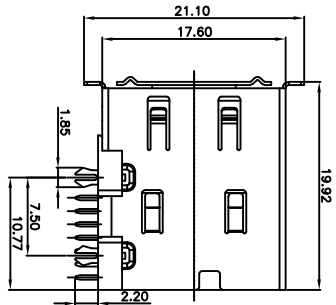
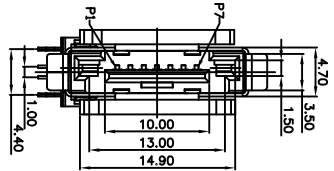
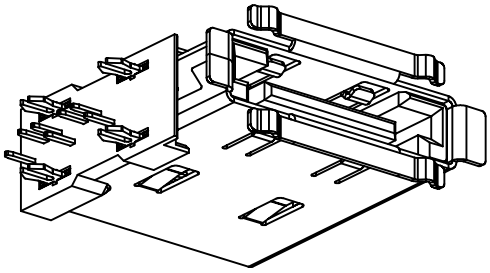

PDFfill PDF Editor With Free Writer and Tools

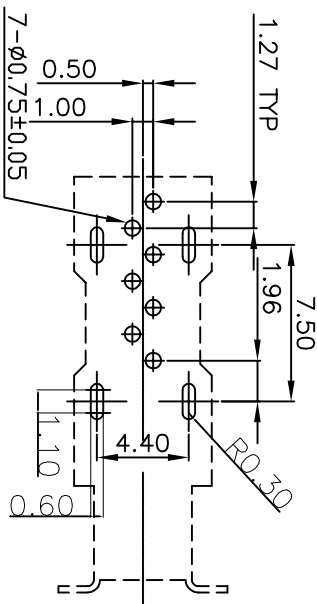

P.C.B. BOARD MOUNTING DIMENSIONS T=1.60mm
PCB TOLERANCE: ±0.05

PIN DEFINITION

ESATA	NAME	TYPE
P1	GND	A+
P2	A+	A-
P3	A-	GND
P4	GND	B-
P5	B-	B+
P6	B+	GND
P7	GND	

mat'l. code	lfr	ecm no	dr	date	surface	sg	tolerance	projection	product family												
	14				ISO 1302	√	ISO 406 150	100%	533												
	A	107-1074S	LNK	2007-05-23	tolerances unless otherwise specified		.XX±0.38	MM	E-SATA_UP_RIGHT												
	B	108-1082S	LNK	2008-04-28	angle		.XX±0.25		DIP_TYPE												
	C	110-0184S	LNK	2010-12-14	line ar		.XXX±0.100	scale 2:1													
	D	T-00544QS	LNK	2011-08-31	STERLING	LNK	2007-05-21														
	E	ex-s-00781	HKL	2011-10-17	eng		HKLIM	2016-03-03													
	F	ex-s-01187	HKL	2012-06-08	ch		HKLIM	2016-03-03													
	G	ex-s-2340	HKL	2016-03-03	qpp		KPTAY	2016-03-03													
Sheet	Revision	G	G	107109	111	113	115	117	119	121	123	125	127	129	131	133	135	137	139		
Index	Sheet	1	2	3	106	108	110	112	114	116	118	120	122	124	126	128	130	132	134	136	138

- NOTES:
1. MATERIAL: HOUSING: THERMAL PLASTIC HIGH TEMP WITH 30% G/F U194 V-0 COLOR: BLACK CONTACT: COPPER ALLOY SHELL/BOARD LOCK: COPPER ALLOY
 2. CONTACT: GOLD PLATING ON CONTACT AREA 100µ" MIN. WATT TIN PLATING ON SOLDERMILLS 50µ" MIN. NICKEL UNDERPLATING OVER ALL BOARD LOCK: 50µ" MIN. NICKEL PLATING OVER ALL SHELL/BOARD LOCK: 50µ" MIN. WATT TIN PLATING OVER ALL SHELL/BOARD LOCK: 50µ" MIN. NICKEL PLATING OVER ALL
 3. IN A WAVE SOLDER APPLICATION WITH A 1.5MM P/B
 4. PRODUCT SPEC : GS-12-398
 5. PACKING SPEC : GS-14-1109
 6. PRODUCT NUMBERING: 10074141 - 1 0 2 LF LEAD FREE
- PAKING: BLANK: TRAY PACKING
1: 1.5µ" GOLD PLATING
2: 0.7µ" GOLD PLATING
6. A SYMBOL Δ WILL BE NEXT TO ANY DIMENSION, VIEW OR NOTE, WHICH HAS BEEN MODIFIED WITH THE CURRENT DRAWING REVISION
- 1: LAYOUT/2

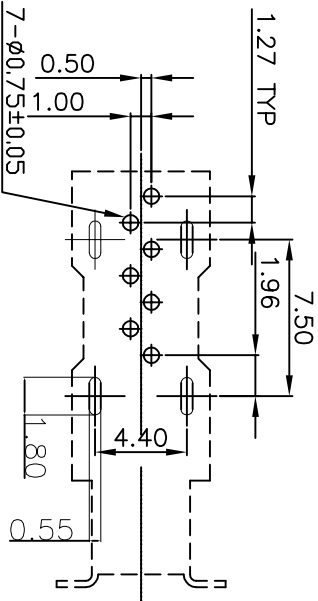
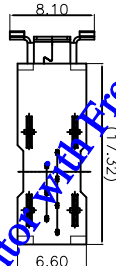
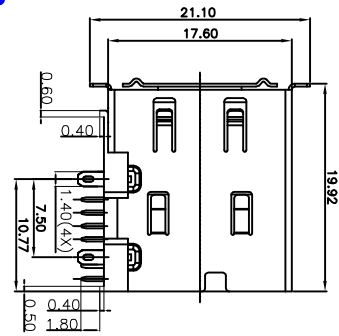
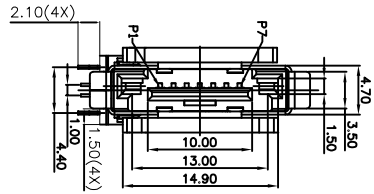

P.C.B. BOARD MOUNTING DIMENSIONS T=1.60mm
PCB TOLERANCE: ±0.05

NAME	TYPE	ESATA
P1	GND	
P2	A+	
P3	A-	
P4	GND	
P5	B-	
P6	B+	
P7	GND	

PIN DEFINITION

PDFill PDF Editor with Free Writer and Tools

mat'l. code	14	surface	ISO 1302	ISO 406	ISO 150	100	projection	product family	533												
lfr	ecm no	dr	date	tolerances unless otherwise specified	angles	linear	scale	2:1													
A	T07-1074S	LIN	2007-05-23			.X±0.38	MM	E-SATA_UP_RIGHT													
B	T08-1082S	LIN	2008-04-28			.XX±0.25		DIP_TYPE													
C	T10-0184S	LIN	2010-12-14	0±Z		.XXX±0.100	scale	2:1													
D	T-00544QS	LIN	2011-08-31	dr																	
E	EX-S-0078R	HKL	2011-10-17	engr																	
F	EX-S-0118R	HKL	2012-06-08	chr																	
G	EX-S-234W	HKL	2016-03-03	dpd																	
Sheet	Revision	1	2	3	107	109	111	113	115	117	119	121	123	125	127	129	131	133	135	137	139
Index	Sheet	G	G	G	106	108	110	112	114	116	118	120	122	124	126	128	130	132	134	136	138

- NOTES:
1. MATERIAL: THERMOPLASTIC HIGH TEMP WITH 30% G/F UL94 V-0 ROUSING: COLOR:BLACK
 2. FINISH: CONTACT: COPPER ALLOY SHELL/BOARD LOCK: COPPER ALLOY
 3. CONTRACT: GOLD PLATING ON CONTACT AREA
 4. BOARD LOCK: 50μ" MIN. NICKEL UNDERPLATING OVER ALL SHELL/BOARD LOCK: 50μ" MIN. NICKEL PLATING OVER ALL IN A WAVE SOLDER APPLICATION WITH A 1.5MM PCB
 5. PRODUCT SPEC: 05-12-386
 6. PACKING SPEC: 05-14-1109
 7. PRODUCT NUMBERING: 10074141 - 2 0 X X X LF - LEAD FREE
6. A SYMBOL Δ WILL BE NEXT TO ANY DIMENSION, VIEW OR NOTE, WHICH HAS BEEN MODIFIED WITH THE CURRENT DRAWING REVISION
- 2: LAYOUTS
1: 15μ" GOLD PLATING
2: 0.7μ" GOLD PLATING
PACKING: TRAY PACKING
BLANK: TRAY PACKING

X-ON Electronics

Largest Supplier of Electrical and Electronic Components

Click to view similar products for [I/O Connectors](#) category:

Click to view products by [Amphenol](#) manufacturer:

Other Similar products are found below :

[571763P](#) [58098-0628](#) [72.250.1628.2](#) [72.250.2428.2](#) [74720-0505](#) [76.350.0729.0](#) [76871-1403](#) [FCN-244F080-G/1](#) [FCN-260A9920](#) [PCR-E36PM](#) [PCS-XE26MA+](#) [G38A71314B](#) [1571250010](#) [157-22500-3](#) [MS3471L14-19P L/C](#) [192991-0703](#) [172501-4002](#) [172501-6002](#) [FCN-260C008-A/L0](#) [FCN-260C024-AL0](#) [FCN-261Z008](#) [2000314-1](#) [200331-1](#) [PCR-E36FC+](#) [PCS-E28FS+](#) [PCS-XE26SLFD+](#) [PCS-XE26SLFDT+](#) [G730VID08BDC24](#) [HDR-E14MSG1+](#) [U90B2054081210](#) [UE86K842720321](#) [38113800006](#) [DP3AR020WQ1R200](#) [Z4.102.0680.0](#) [500-1040](#) [500-1052](#) [500-1054](#) [ZP-4008-66L](#) [0709821002](#) [DX40-20P\(55\)](#) [5554841-1](#) [MS3474W18-8P-LC*](#) [SM3106F14S-7S-LC](#) [U90B3054061110](#) [U65-E04-4020](#) [ZPF000000000097891](#) [557-262M2-06C](#) [747360449](#) [10099439-003C-TRLF](#) [10137239-0021LF](#)