

PRODUCT NUMBER	MOUNTING TYPE	PACKAGING
10099100-011LF	NORMAL(0 DEGREE ANGLE)	TRAY
10099100-021LF	PCIe(1 DEGREE ANGLE)	TRAY

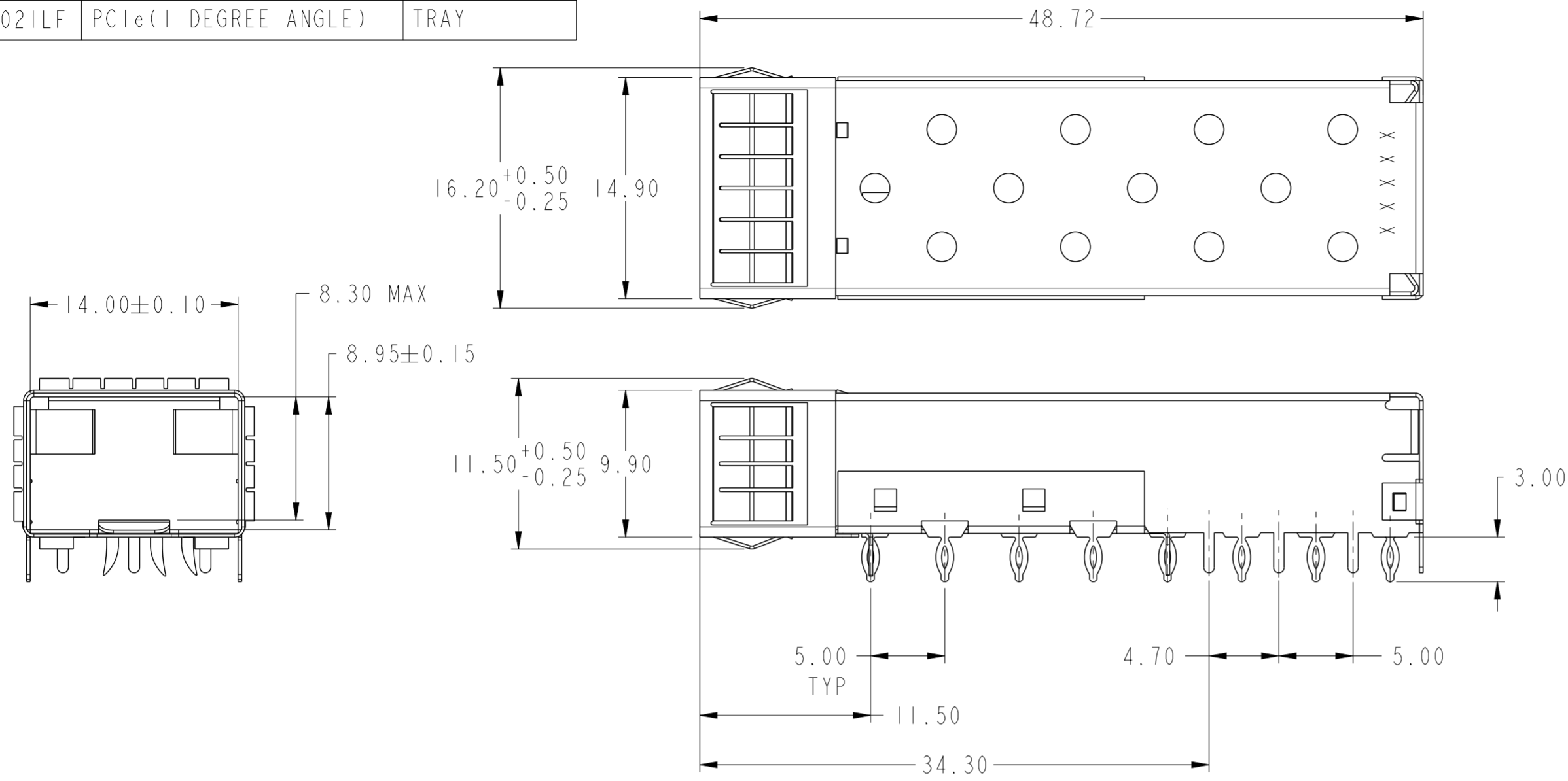

NORMAL TYPE (0 DEGREE ANGLE)

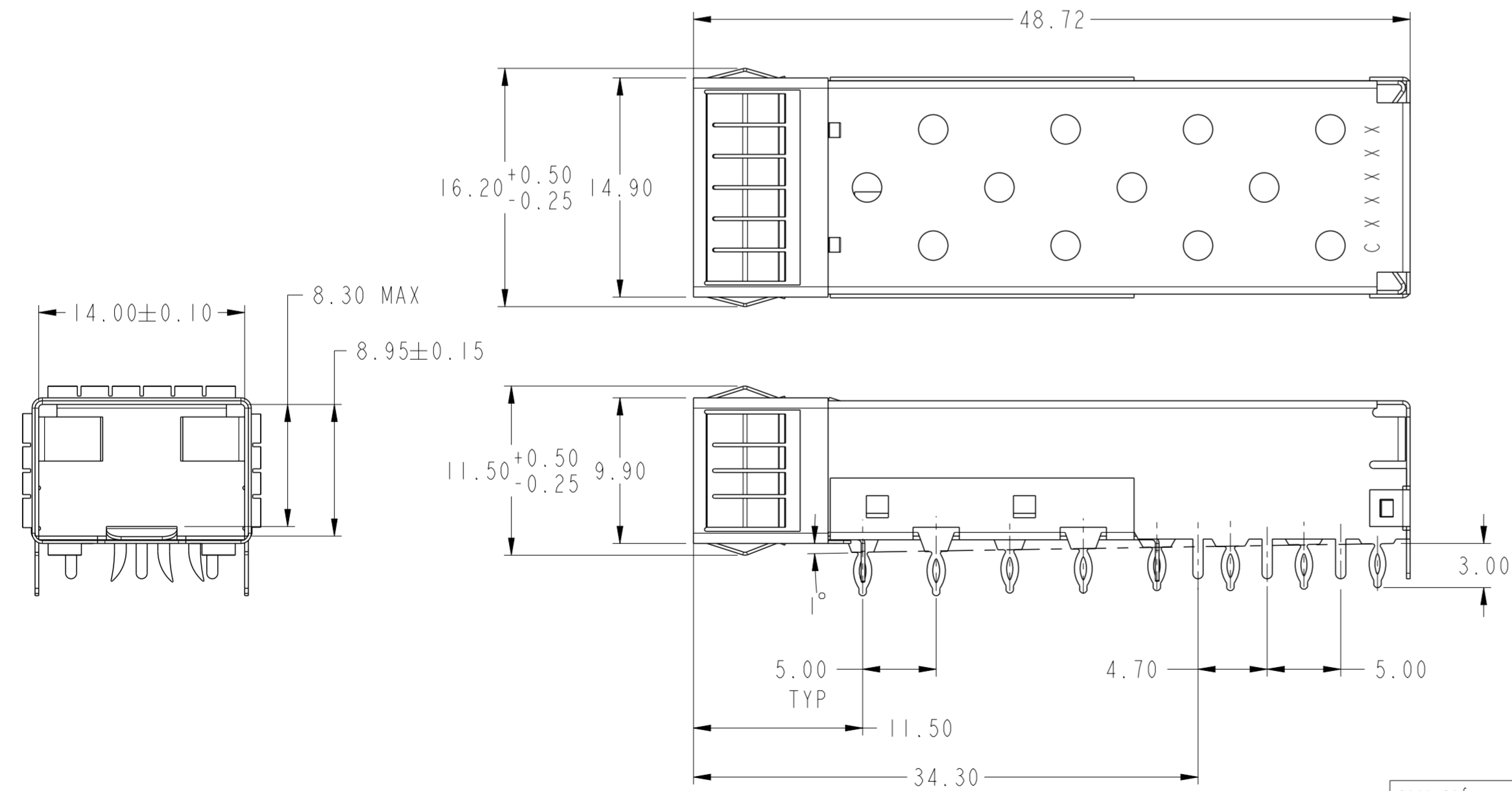

PCIe TYPE (1 DEGREE ANGLE)

NOTES:

1. MATERIAL: COPPER ALLOY.
2. PLATING:
CAGE BODY: 1.27µm MIN. NICKEL PLATING OVER ALL.
EMI FINGER: 1.27µm MIN NICKEL PLATING OVER ALL.
3. DATUM AND BASIC DIMENSIONS ARE ESTABLISHED BY CUSTOMER.
4. PADS AND VIAS ARE CHASSIS GROUND, 11 PLACES.
5. THROUGH HOLES, PLATING OPTIONAL.
6. CROSS-HATCHED AREA DENOTES COMPONENT AND TRACE KEEP-OUT (EXCEPT CHASSIS GROUND).
7. THIS AREA DENOTES COMPONENT KEEP-OUT (TRACES ALLOWED).
8. PRODUCT SPECIFICATION: GS-12-616
9. APPLICATION SPECIFICATION: GS-20-125
10. PRODUCT MEETS EUROPEAN UNION DIRECTIVES AND OTHER COUNTRY REGULATIONS AS DESCRIBED IN GS-22-008.
11. DATE CODE BE PRINTED ON PROPER SURFACE.
12. PRINTED "C" MARK BEFORE DATE CODE FOR P/N:-021LF(FCIe TYPE).

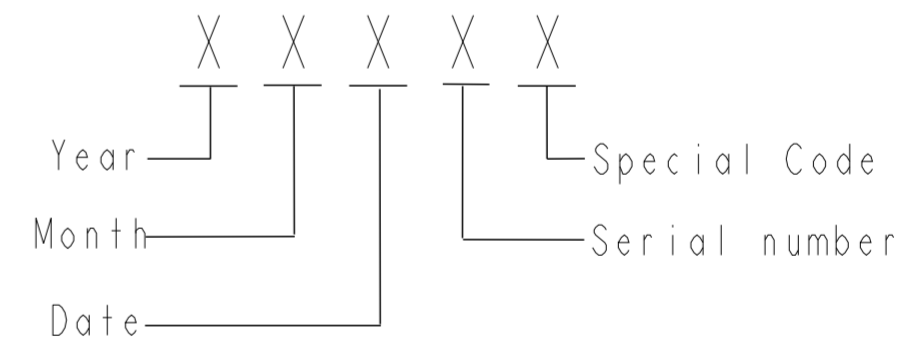

DATE CODE DESCRIPTION

spec ref	RELEASE	dr	Andy Zhang	2010/11/03	projection	MM	size	A2	scale	2:1
tolerance std	ASME Y14.5	eng	Andy Zhang	2012/02/09	chr	-	ecn no	ELX-N-010226-1	rel level	Released
surface	✓	appr	Rick Bian	2012/02/15	product family	SFP+	cat. no.	10099100	rev	D
ASME Y14.5	linear	0.X	±0.25	0.XX	±0.15	0.XXX	±-	angular	0°	±2°
		www.fci.com		Product - Customer Drw		sheet 1 of 3				

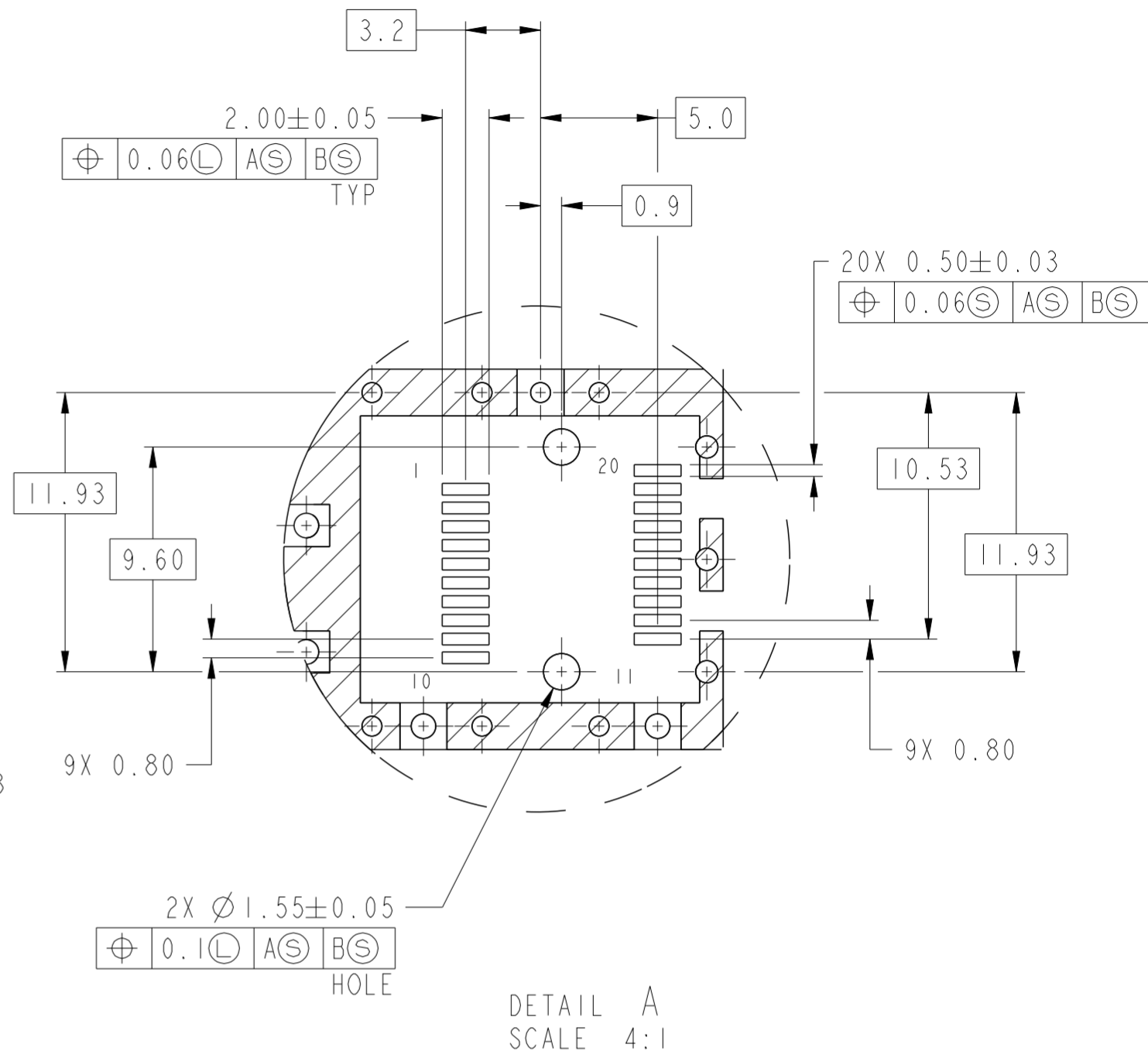
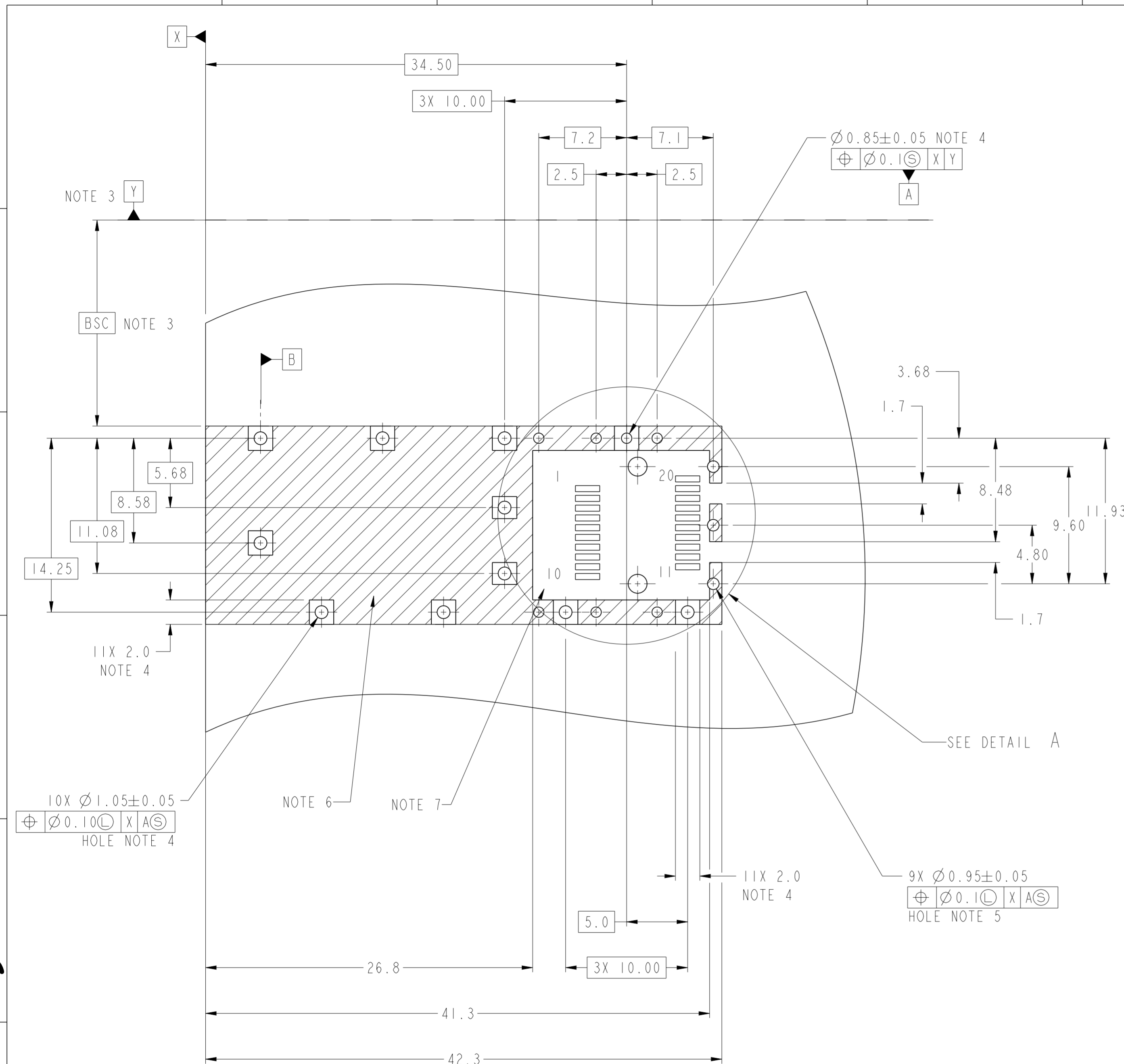

HOST BOARD MECHANICAL LAYOUT

spec ref	RELEASE	dr	Andy Zhang	2010/11/03	projection	MM	size	A2	scale	2:1
tolerance std	ASME Y14.5	eng	Andy Zhang	2012/02/09	chr	-	ecn no	ELX-N-010226-1		
	TOLERANCES UNLESS OTHERWISE SPECIFIED	appr	Rick Bian	2012/02/15	product family	SFP +	rel level	Released		
surface	✓	linear	0.X	± 0.25		SFP+ IXI Cage EMI FINGER TYPE	10099100	rev D	sheet 2 of 3	
		0.XX	± 0.15	cat. no.					Product - Customer Drw	
		0.XXX	\pm							
ASME Y14.5	angular	0°	$\pm 2^\circ$							

Copyright FCI.
FCI

PRODUCT NUMBER	MOUNTING TYPE
10099100-011LF	NORMAL TYPE
10099100-021LF	FCI _e TYPE

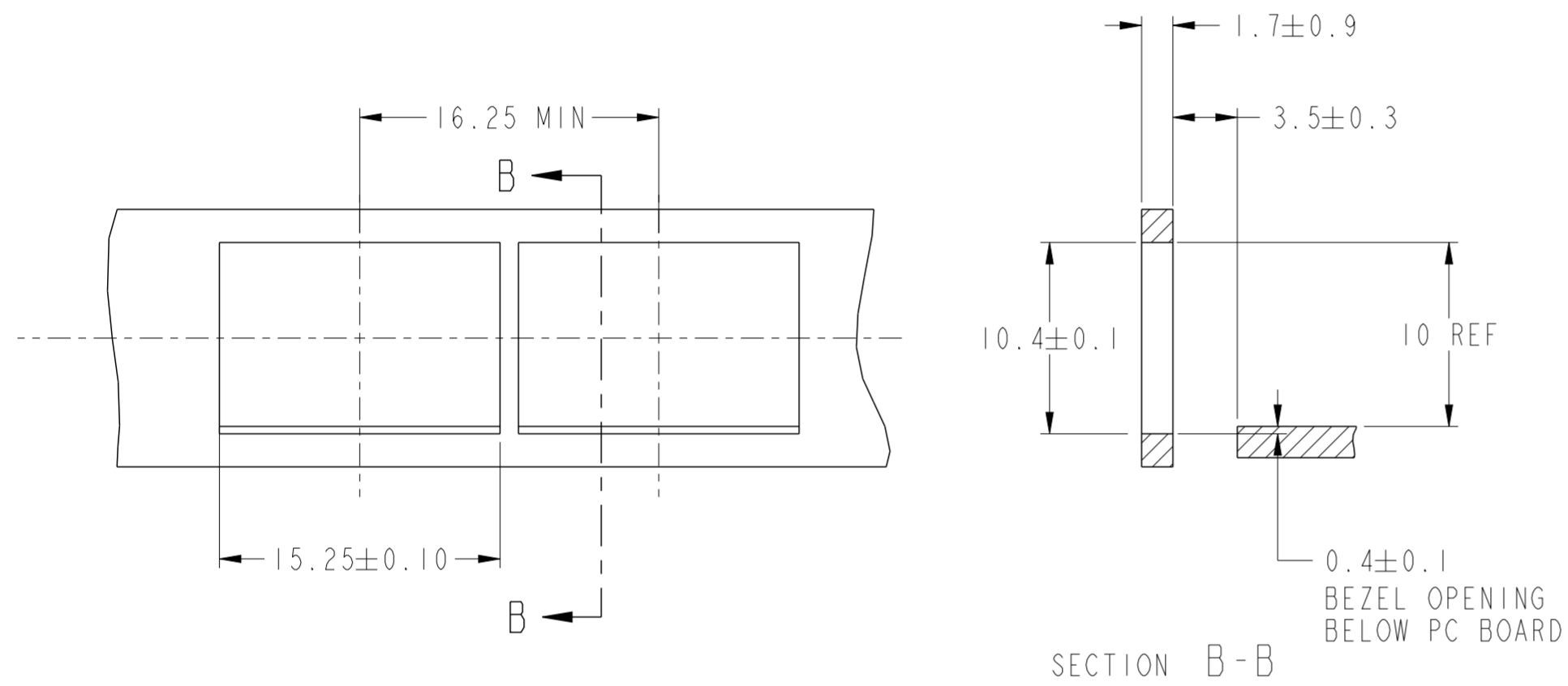

RECOMMENDED PANEL DESIGN
FOR NORMAL TYPE

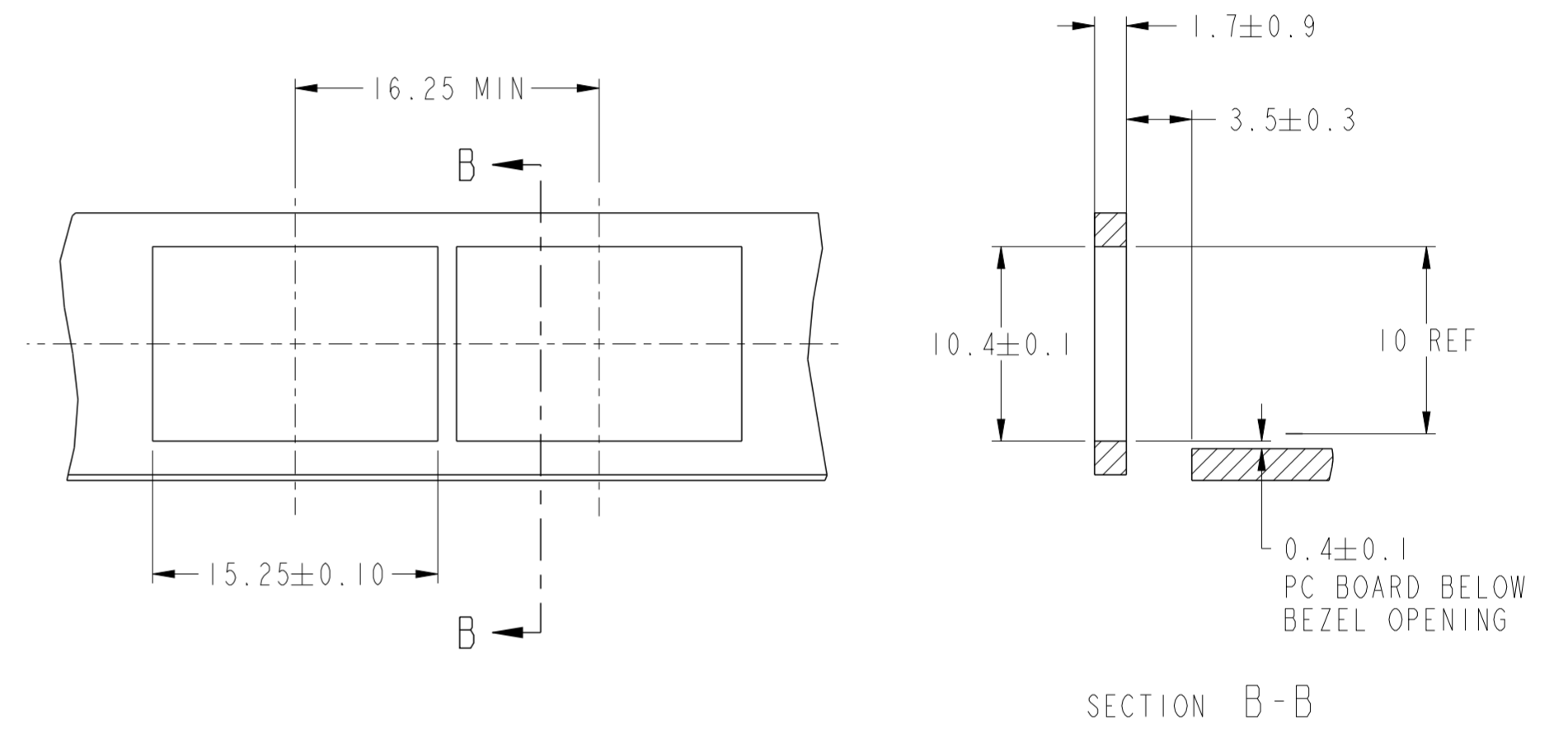

RECOMMENDED PANEL DESIGN
FOR FCI_e TYPE

spec ref	RELEASE	dr	Andy Zhang	2010/1/03	projection	MM	size	A2	scale	2:1	
tolerance std	ASME Y14.5	eng	Andy Zhang	2012/02/09			ecn no	ELX-N-010226-1			
TOLERANCES UNLESS OTHERWISE SPECIFIED		chr	-	appr			Rick Bian	2012/02/15	product family	SFP+	rel level
surface	✓	linear	0.X	±0.25		SFP+ IXI Cage EMI FINGER TYPE	cat. no.	Product - Customer Drw	sheet 3 of 3	rev	D
			0.XX	±0.15						diag no	10099100
		angular	0°	±2°						www.fci.com	

X-ON Electronics

Largest Supplier of Electrical and Electronic Components

Click to view similar products for [I/O Connectors](#) category:

Click to view products by [Amphenol](#) manufacturer:

Other Similar products are found below :

[571763P](#) [58098-0628](#) [72.250.1628.2](#) [72.250.2428.2](#) [74720-0505](#) [76.350.0729.0](#) [76871-1403](#) [FCN-244F080-G/1](#) [FCN-260A9920](#) [MP-5T180MUNNA-005](#) [PCR-E36PM](#) [PCS-XE26MA+](#) [G38A71314B](#) [1571250010](#) [157-22500-3](#) [MS3471L14-19P L/C](#) [192991-0703](#) [172501-4002](#) [172501-6002](#) [FCN-260C008-A/L0](#) [FCN-260C024-AL0](#) [FCN-261Z008](#) [2000314-1](#) [200331-1](#) [PCR-E36FC+](#) [PCS-E28FS+](#) [PCS-XE26SLFD+](#) [PCS-XE26SLFDT+](#) [G730VID08BDC24](#) [U90B2054081210](#) [UE86K842720321](#) [38113800006](#) [DP3AR020WQ1R200](#) [Z4.102.0680.0](#) [500-1040](#) [500-1052](#) [500-1054](#) [ZP-4008-66L](#) [0709821002](#) [DX40-20P\(55\)](#) [5554841-1](#) [MS3474W18-8P-LC*](#) [U90B3054061110](#) [U65-E04-4020](#) [ZPF000000000097891](#) [557-262M2-06C](#) [747360449](#) [10099439-003C-TRLF](#) [10137239-0021LF](#) [E9320-001-01](#)