

PRODUCT NUMBER	DESCRIPTION	DIM "L"	A	B	DIM "C"	D	USED ON XXXXXX
10125490-010	10 COLUMN	20.00	5	4	8	6	3P 10C
10125490-008	8 COLUMN	16.00	4	3	6	5	3P 08C
10125490-006	6 COLUMN	12.00	3	2	4	4	3P 06C

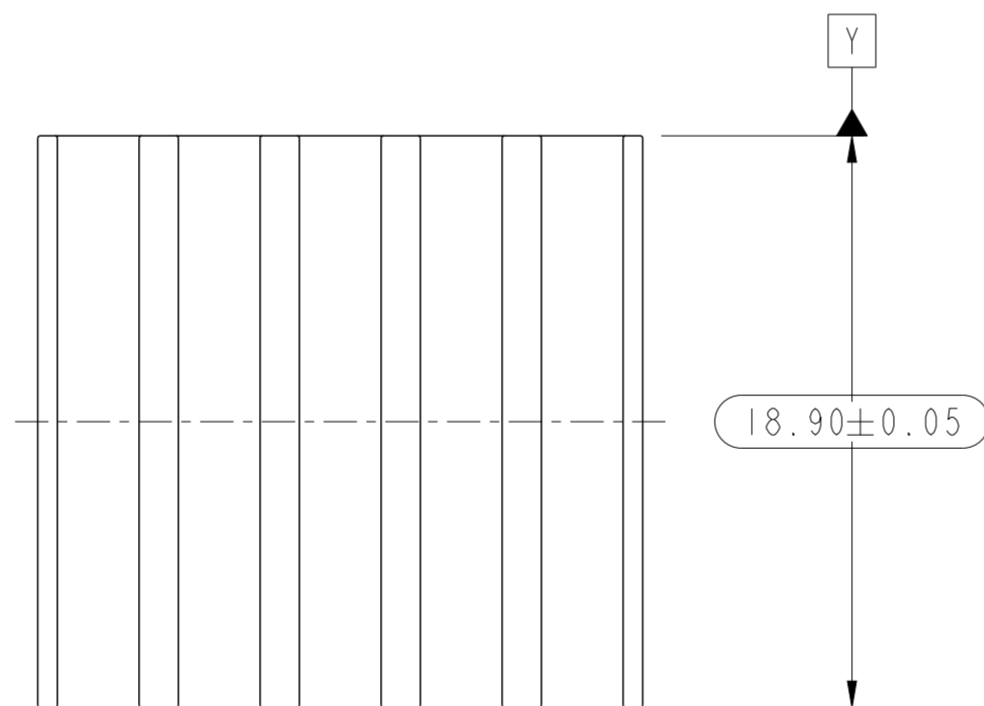
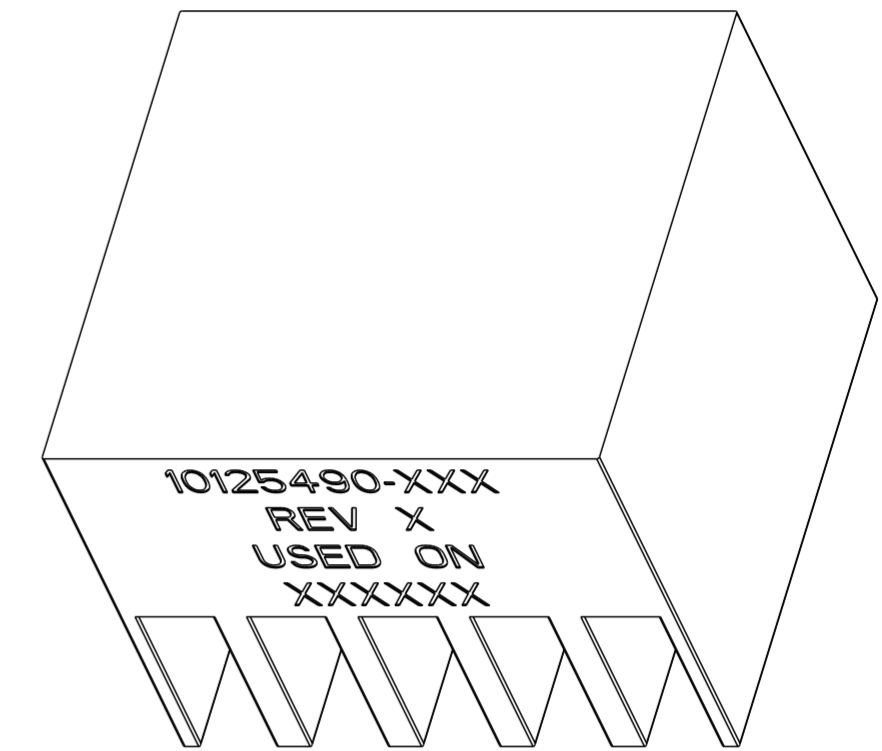
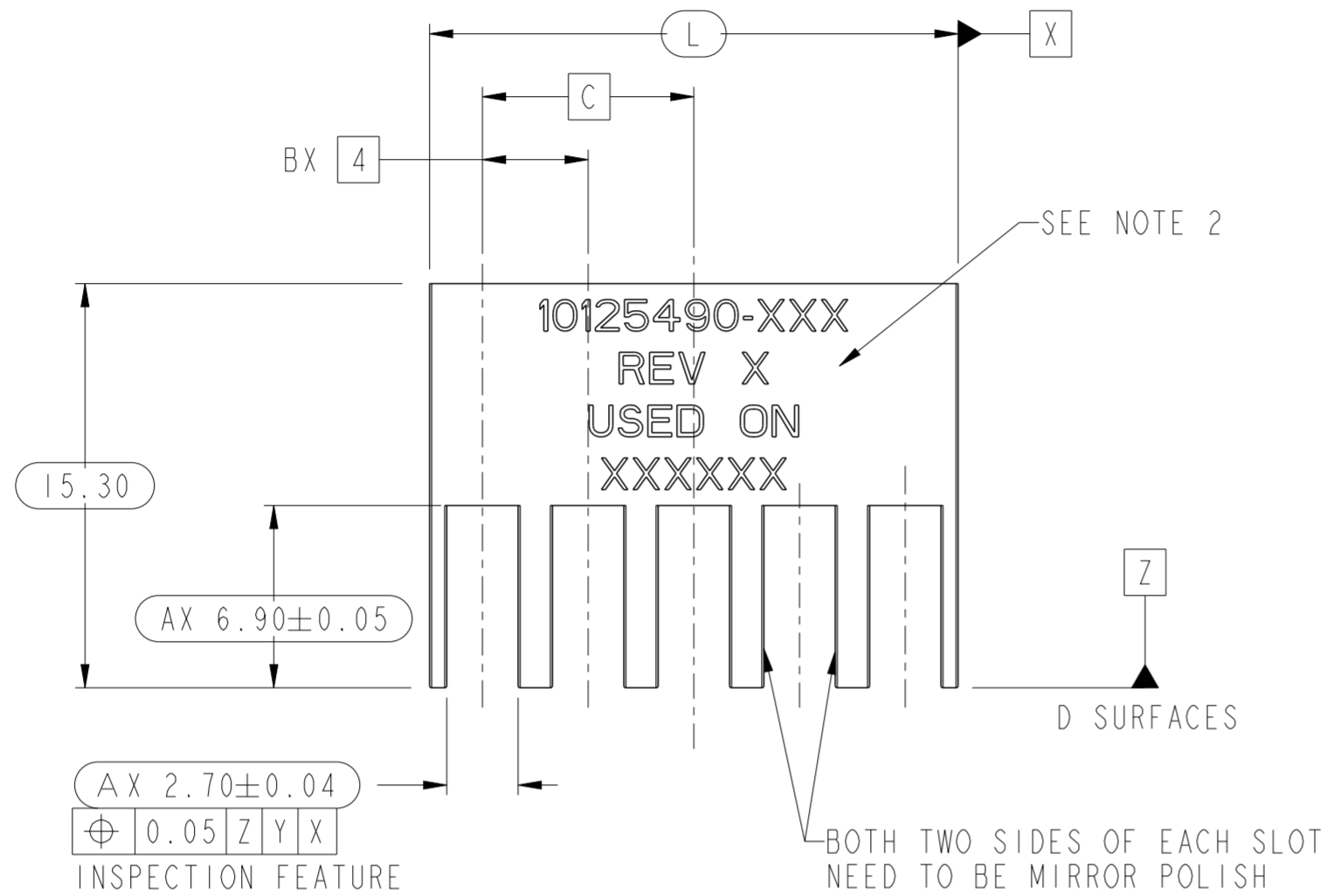

DRNOTES:

- BREAK ALL UNDEFINED SHARP EDGES 0.13MM X 45°.
- PRODUCT MARKING (PART NUMBER, REVISION, AND USED ON PN) ON THIS SURFACE IN 1.5MM HIGH TEXT.
- A \triangle SYMBOL WILL BE NEXT TO ANY DIMENSION, VIEW, OR NOTE, WHICH HAS BEEN MODIFIED WITH THE CURRENT DRAWING REVISION.
- DIMENSIONS WITH AN "OVAL" ARE SPECIFIED IN THE INSPECTION DOCUMENTS AS CC, IPI, FPI, OR ICI DIMENSIONS. OTHER FEATURES OR STAND-ALONE GEOMETRICAL TOLERANCES THAT ARE SPECIFIED IN THE INSPECTION DOCUMENTS AS CC, IPI, FPI, OR ICI MUST HAVE THE NOTE "INSPECTION FEATURE" BELOW THEM.

TOLERANCES UNLESS OTHERWISE SPECIFIED		tolerance std	material	AISI	-A6	dr	Heaven Cen	2014/02/11	projection	mm	size	A2	scale	4:1
linear	X.	±	ASME Y14.5M	mat code	-	eng	Terry Luo	2017/02/09	\oplus \square	← →	ecn no	-	rel level	Released
	0.X	±0.3		heatreat	RC 54-56	chr	-	product family			ExaMAX			
	0.XX	±0.10		surface	spec ref	-	Amphenol FCI		title	INSERTION TOOL	cat. no.	SEE TABLE	Product - Inspection Drw	sheet 1 of 1
	0.XXX	±0.050			model name	10125490-010	ExaMAX VH 3Pr	10125490	rev	A				
angular	0°	±2°	ASME Y14.5M	model revision	A	cat. no.	SEE TABLE	Product - Inspection Drw	sheet 1 of 1					

AFCI CONFIDENTIAL

Amphenol FCI

This document is the property of and embodies CONFIDENTIAL and PROPRIETARY information of AFCI. No part of the information shown on this document may be used in any way or disclosed to others without the written consent of AFCI. © 2016 AFCI

X-ON Electronics

Largest Supplier of Electrical and Electronic Components

Click to view similar products for [Extraction, Removal & Insertion Tools](#) category:

Click to view products by [Amphenol](#) manufacturer:

Other Similar products are found below :

[M8196914-08](#) [768211-2](#) [809-131](#) [844751-2](#) [8-59558-2](#) [91018-1](#) [12014013](#) [12093647](#) [1-21048-0](#) [R282867020](#) [12093078](#) [12180559](#) [1-21048-6](#) [12121897](#) [DCF.91.405.5LT](#) [1322](#) [13549852](#) [15314260](#) [15313892](#) [15350698](#) [15350707](#) [15430130](#) [1643916-1](#) [1-679532-0](#) [1976593-3](#) [OUTEXT-0321](#) [2-1579008-3](#) [2-1579008-4](#) [229694-7](#) [231106-1](#) [241469](#) [91040-3](#) [91040-7](#) [965004-000](#) [965069-000](#) [1738219-1](#) [ET-JL05-16](#) [FG 0300 146 3000](#) [FIT-6](#) [210S048](#) [2-1579007-9](#) [231879-1](#) [CF-008025-000](#) [312138-3](#) [RJ11FODE](#) [356-162](#) [M8196914-10](#) [4-1579018-0](#) [483249-1](#) [5-1579007-2](#)