

PRODUCT NO.  
10131144-001RLF

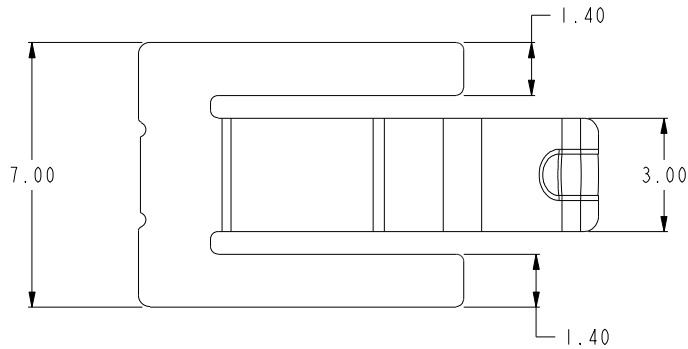
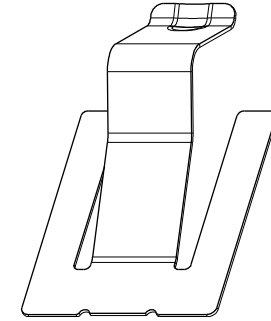
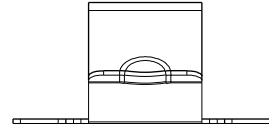
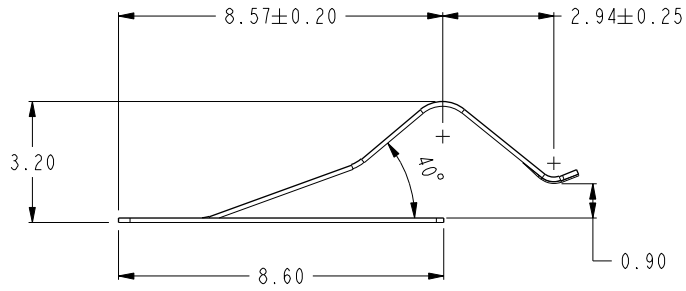

NOTES:

1. MATERIAL: TITANIUM COPPER ALLOY.
2. CONTACT PLATING:  
CONTACT AREA: PLATING 0.76um Au OVER Ni UNDERPLATE.  
SOLDER AREA: PLATING GOLD FLASH OVER Ni UNDERPLATE.
3. PACKAGING: TAPE & REEL.
4. PART NUMBER DESCRIPTION:  
10131144-0 0 X X X

LF : LEAD FREE  
R : TAPE & REEL  
CONTACT PLATING:  
I : 0.76um Au OVER Ni

spec ref *		dr ANDY LU		2014-11-20	projection 	mm ←→	size A4	scale 5:1	
tolerance std ASME Y14.5		eng ANDY LU		2016-02-25			ecn no .		
TOLERANCES UNLESS OTHERWISE SPECIFIED		chr TERRIS LIU		2016-02-25			rel level		
ASME Y14.5		appr PM ZHENG		2016-02-25	product family -				
surface - ✓ ASME Y14.5	linear	0.X	±0.3	Amphenol FCi	UNIVERSAL CONTACT SPRING WITH 3.2mm HEIGHT		dwg no 10131144		
		0.XX	±0.13						
		0.XXX	±0.050						
angular	0°	±3°		cat. no. -	Product - Customer Drw		sheet 1 of 2		
							rev 4		

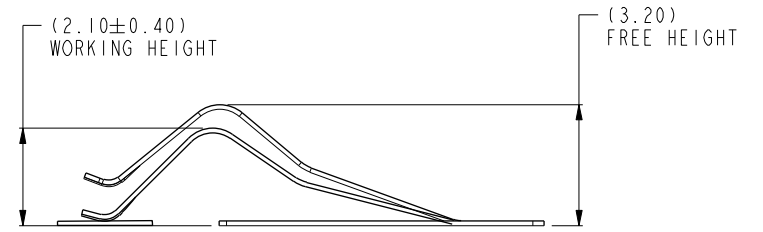
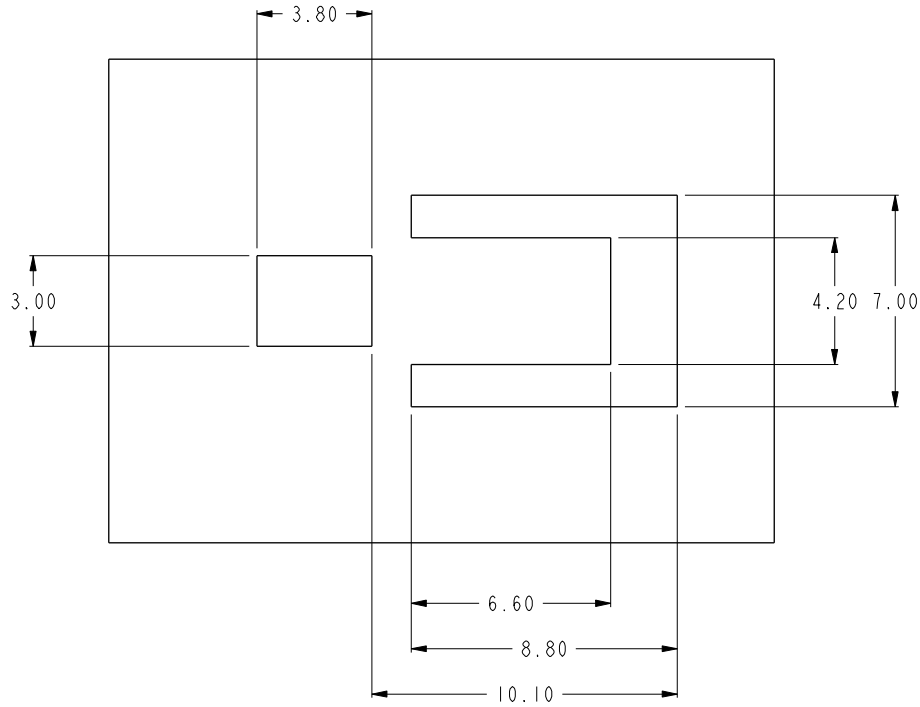

RECOMMENDED PCB DIMENSION  
TOLERANCE: +/- 0.05mm

spec ref *		dr ANDY LU		2014-11-20	projection 	mm 	size A4	scale 4:1
tolerance std ASME Y14.5	TOLERANCES UNLESS OTHERWISE SPECIFIED	eng ANDY LU		2016-02-25			ecn no .	rel level
		chr TERRIS LIU		2016-02-25				
		appr PM ZHENG		2016-02-25	product family -			
surface ASME Y14.5	linear	0.X	$\pm 0.3$	<b>Amphenol FCi</b>	part no UNIVERSAL CONTACT		dwg no 10131144	rev 4
		0.XX	$\pm 0.13$		+ SPRING WITH 3.2mm HEIGHT			
	angular	0°	$\pm 3^\circ$		cat. no. -	Product - Customer Drw		sheet 2 of 2

## X-ON Electronics

Largest Supplier of Electrical and Electronic Components

*Click to view similar products for [Power to the Board](#) category:*

*Click to view products by [Amphenol](#) manufacturer:*

Other Similar products are found below :

[6643429-1](#) [6766604-1](#) [120959-1](#) [1393557-2](#) [1393532-2](#) [1393532-3](#) [1393532-4](#) [1393557-1](#) [1744132-7](#) [1892109-1](#) [1-6450850-6](#) [1-6450869-6](#)  
[1645526-2](#) [2005243-2](#) [377-0020-11130](#) [MC116N](#) [TE34-12-16P-F0](#) [51700-10201602AALF](#) [51970-004](#) [5-6450830-6](#) [4-6600333-3](#)  
[10125416-4050LF](#) [10130248-005LF](#) [6600320-3](#) [1888123-2](#) [701-15-02109](#) [6450810-7](#) [46437-1112](#) [6450813-2](#) [6450842-4](#) [1645523-1](#) [PSS-](#)  
[06-01-T-S](#) [FWS-03-04-T-S](#) [FWS-05-01-T-S](#) [QE-POL-KEY](#) [FWS-08-01-T-S](#) [C10-642216-56P](#) [6651670-1](#) [2-1600788-6](#) [1761385-3](#) [46562-](#)  
[1175](#) [2221861-1](#) [HFWS-10-05-TM-S](#) [FWS-13-04-T-S-RA](#) [MC4006D](#) [45938-0002](#) [46437-1650](#) [46437-1652](#) [46437-1926](#) [46562-1650](#)