

PRODUCT DESCRIPTION CODE :

10131932-YXXXLF

PLATING :

1 = 0.76 μm GOLD ON CONTACT AREA  
2.54 μm MIN MATTE TIN ON TAIL

2 = 0.38 μm GOLD ON CONTACT AREA  
2.54 μm MIN MATTE TIN ON TAIL

3 = 0.20 μm GOLD ON CONTACT AREA  
2.54 μm MIN MATTE TIN ON TAIL

4 = 0.76 μm GXT ON CONTACT AREA  
2.54 μm MIN MATTE TIN ON TAIL

5 = 0.38 μm GXT ON CONTACT AREA  
2.54 μm MIN MATTE TIN ON TAIL

6 = 0.20 μm GXT ON CONTACT AREA  
2.54 μm MIN MATTE TIN ON TAIL

9 = 2.54 μm MIN MATTE TIN FULL PLATED

1.27 μm NICKEL MIN UNDERLAYER

NOTES :

1 - MATERIAL  
HOUSING : HIGH TEMPERATURE GLASS FILLED FLAME  
RETARDANT PER UL 94 V-0  
TERMINAL: COPPER ALLOY

2- TO DETERMINE DIMENSIONS :  
N = NUMBER OF POSITIONS PER ROW  
EXAMPLE : 8 POS N x 2 = 16mm

3 - RoHS COMPATIBLE PRODUCT SPECIFICATIONS  
a - PLATING :  
"LF" MEANS THE PRODUCT IS LEAD-FREE, 2 μm MINIMUM MATTE TIN OVER  
1.27 μm MINIMUM NICKEL UNDERPLATE

b - MANUFACTURING PROCESS COMPATIBILITY  
THE HOUSING WILL WITHSTAND EXPOSURE TO 260°C ±5°C SOLDER BATH  
TEMPERATURE FOR 5 SECONDS IN A WAVE SOLDER APPLICATION WITH A  
1.6mm MIN THICK CIRCUIT BOARD.

c - LABELLING :  
MEETS PACKAGING SPECS AS PER GS-14-920  
d - LEGAL STATEMENT : SEE GS-47-0004

RoHS COMPATIBLE, SEE NOTE 3  
PACKAGING : "U" FOR TUBE  
TOTAL NUMBER OF POSITIONS 04 TO 50

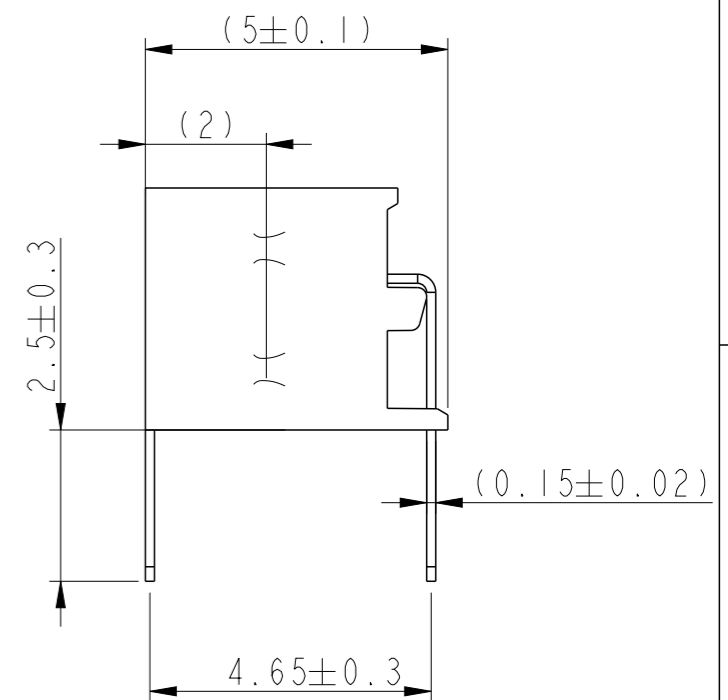
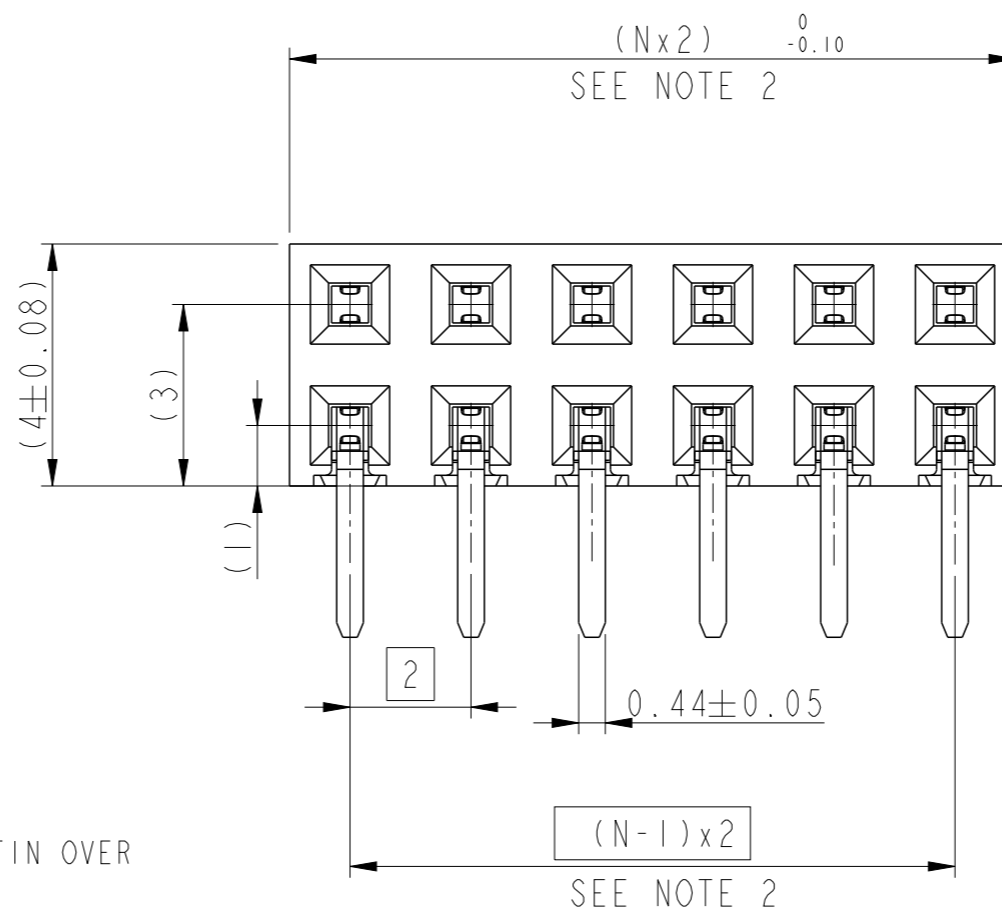
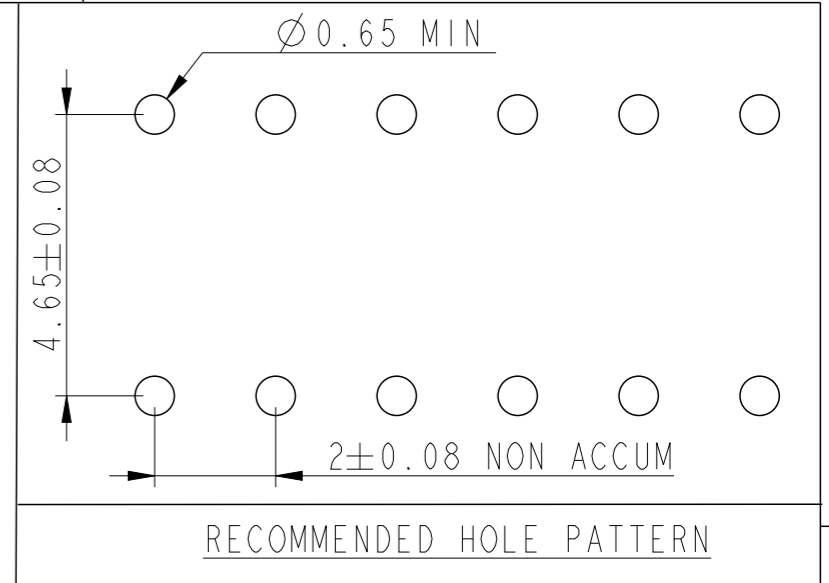

PRELIMINARY

spec ref	GS-12-1326	dr	Cyril Jeune	2014/12/02	projection	mm	size	A3	scale	8:1
tolerance std	ISO 406 ISO 1101	eng	Cyril Jeune	2015/11/18			ecn no	-	rel level	Preliminary
surface	ISO 1302	chr	-	-			product family	-	rel level	Preliminary
	linear	0.X	±		MINITEK RECEPTACLE 2MM ASSEMBLY HCC DR TMT	dwg no 10131932	rev 2			
		0.XX	±							
	angular	0°	±°							
		www.fci.com		cat. no.	-	Product - Customer Drw		sheet 1 of 1		

## X-ON Electronics

Largest Supplier of Electrical and Electronic Components

*Click to view similar products for [Headers & Wire Housings](#) category:*

*Click to view products by [Amphenol](#) manufacturer:*

Other Similar products are found below :

[892-18-020-10-001101](#) [58102-G61-06LF](#) [582553-1](#) [0009485154](#) [009176003701906](#) [0050291907](#) [LY20-4P-DT1-P1E-BR](#) [02.125.8002.8](#)  
[609-3404](#) [61062-3](#) [622-0430](#) [622-3653LF](#) [63453-116](#) [636-1030](#) [636-1427](#) [636-3427](#) [636-4007](#) [641938-9](#) [641991-4](#) [644827-2](#) [65817-010LF](#)  
[65817-015LF](#) [65863-015LF](#) [66207-023LF](#) [67095-007LF](#) [67601157](#) [68648-049](#) [70.362.1628.0](#) [70-4210](#) [70-4226B](#) [70-4853B](#) [707-5020](#) [707-](#)  
[5028](#) [71.350.2428.0](#) [71918-208LF](#) [71961-016LF](#) [733-134](#) [733-162](#) [754199-000](#) [760-3052](#) [787-8014-00](#) [79531-3000](#) [FCN-360C032-B](#) [FCN-](#)  
[367T-T012/H](#) [FCN-723D010/2](#) [80.063.4001.1](#) [800-90-001-10-001000](#) [800-90-010-10-002000](#) [801-43-002-10-013000](#) [801-43-006-10-002000](#)