

PRODUCT NUMBER	PACKAGING
10140369-101LF	STANDARD TRAY

S.NO	DESCRIPTION	MATERIAL	QTY
1	LGA\BGA INTERPOSER HOUSING	LCP	1
2	SCREW INSERT	BRASS	4
3	SOLDER BALL	SAC 305 ALLOY	225
4	VACUUM CAP	LCP	1
5	CONTACT	Cu Alloy Au over Ni	225

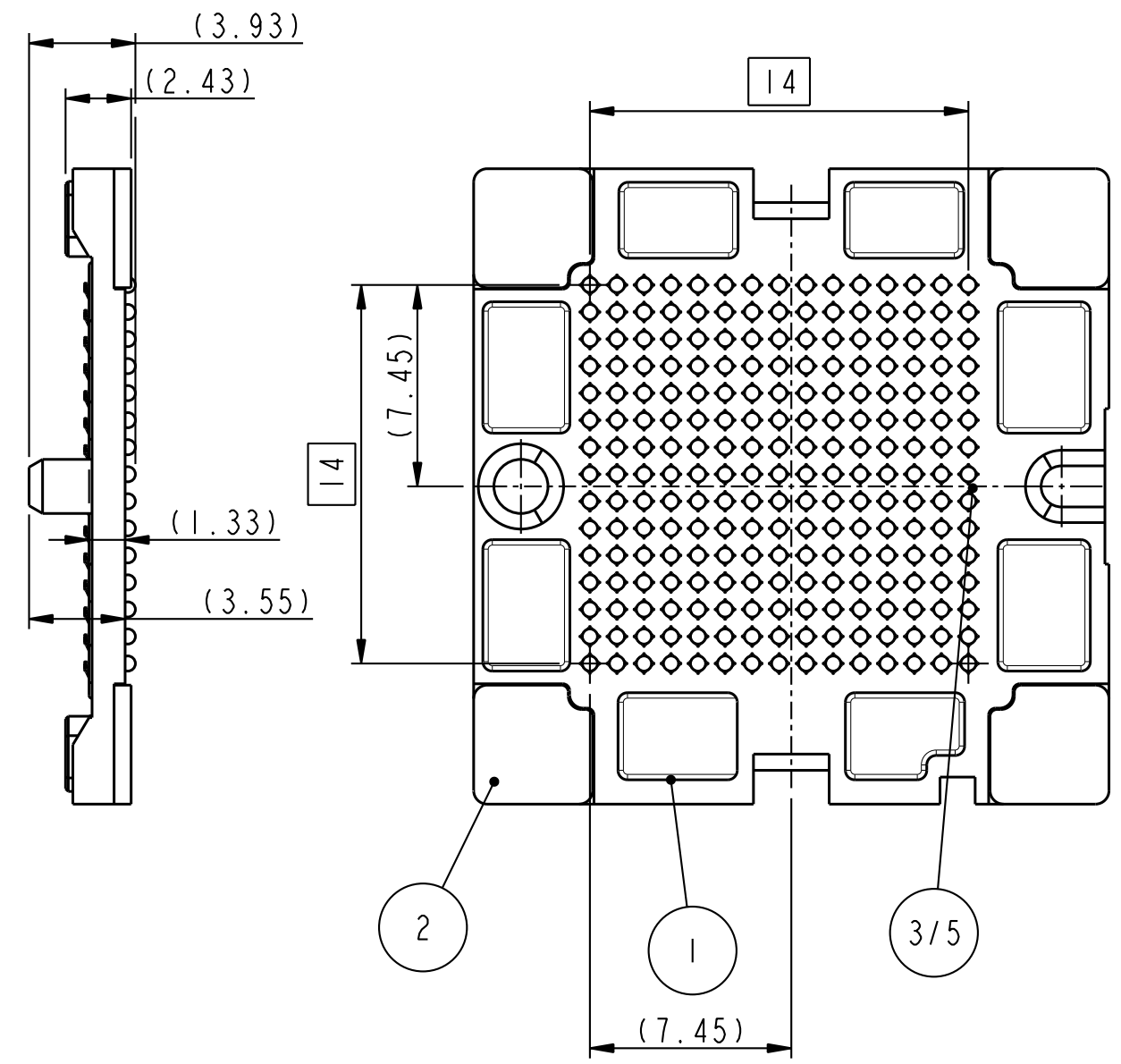
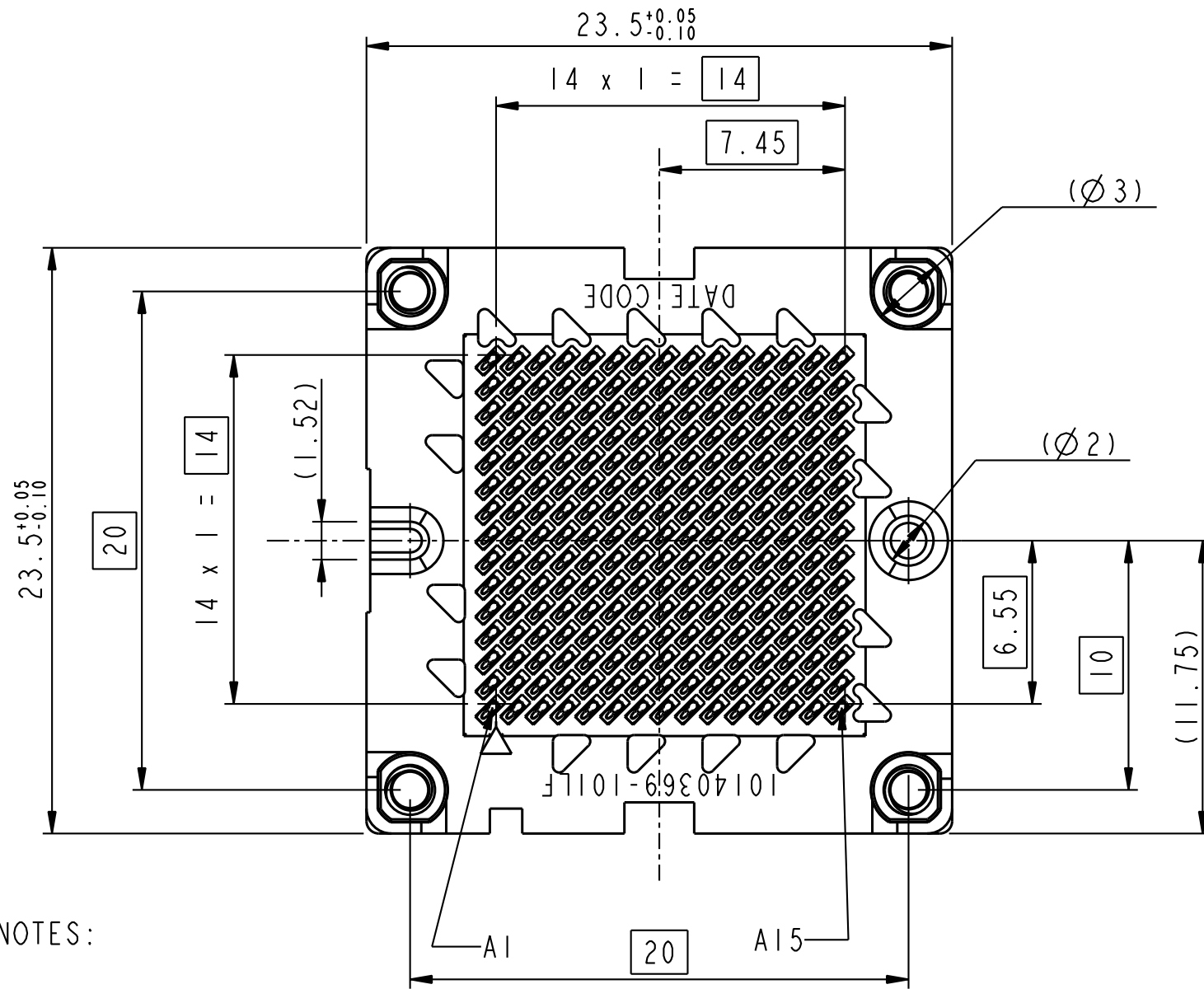

NOTES:

- SOCKET CONTAINS 15 X 15 CONTACT POSITIONS
- SPRING FORCE = 0.32N PER CONTACT
- IN DEFLECTED POSITION, SPRING TIP MUST BE FLUSH WITH HOUSING SURFACE
- FITS WITH FCI TRANSCEIVER PN:10124588
- APPLICATION SPEC: GS-20-0470
- PRODUCT SPEC: GS-12-1293
- PACKAGING SPEC: GS-14-2460
- RECOMMENDED TIGHTENING TORQUE
0.073 Nm ± 0.017 Nm

spec ref	-	dr	M Streckwald	2016/07/08	projection	mm	size	A3	scale	4:1
tolerance std	ISO 406 ISO 1101	eng	M Streckwald	2017/09/30			ecn no	-	rel level	Released
TOLERANCES UNLESS OTHERWISE SPECIFIED		chr	-	-			product family	-		
surface	ISO 1302	appr	C Pendleton	2017/09/30	Amphenol FCI MBO SOCKET ASSEMBLY INTERPOSER REL		dwg no	10140369	rev	A
					www.fci.com	cat. no.	-	Product - Customer Drw	sheet 1 of 3	

Amphenol FCI

© 2016 AFCI

RECOMMENDED PCB FOOTPRINT

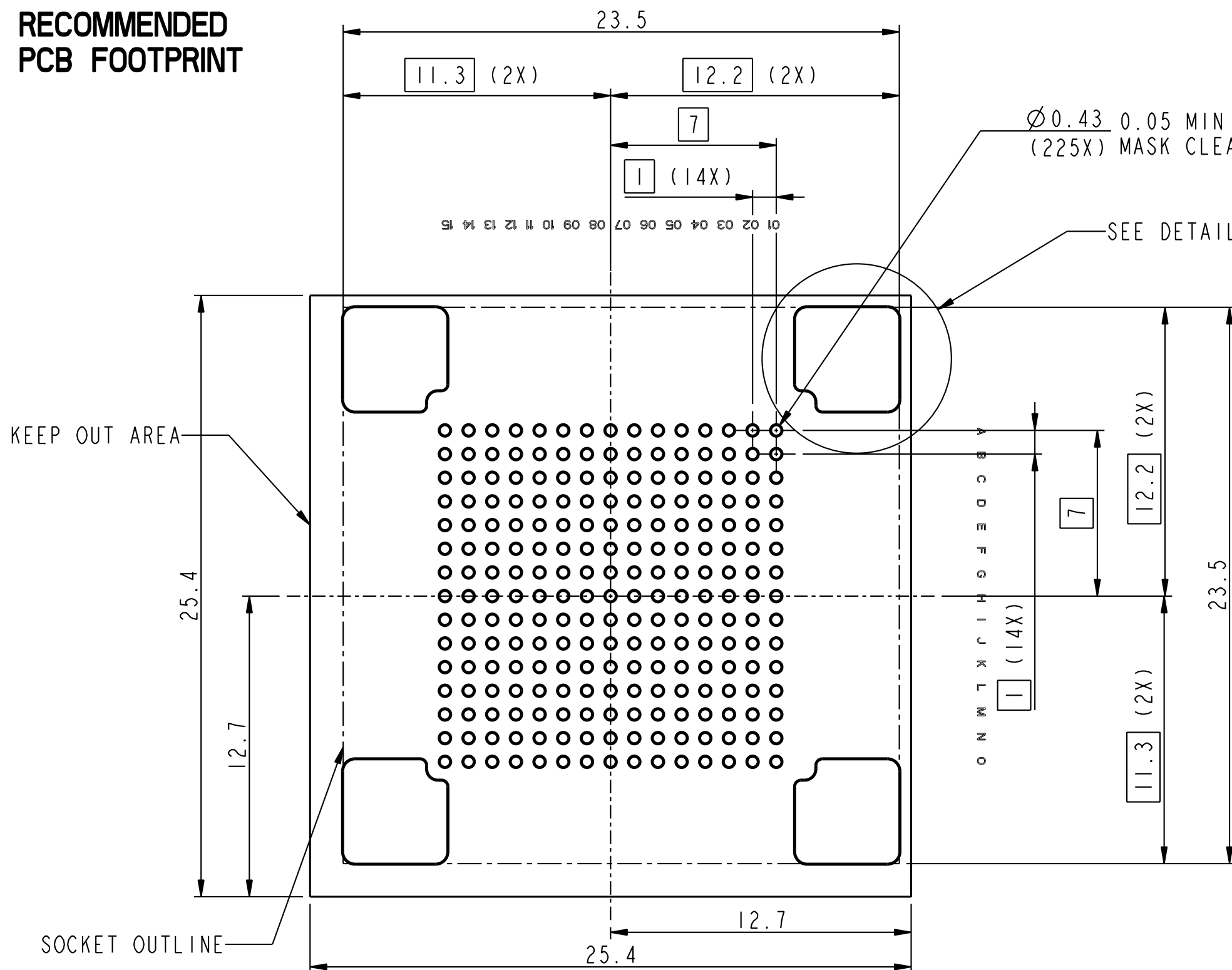

Ø0.43 0.05 MIN SOLDER
(225X) MASK CLEARANCE

SEE DETAIL A

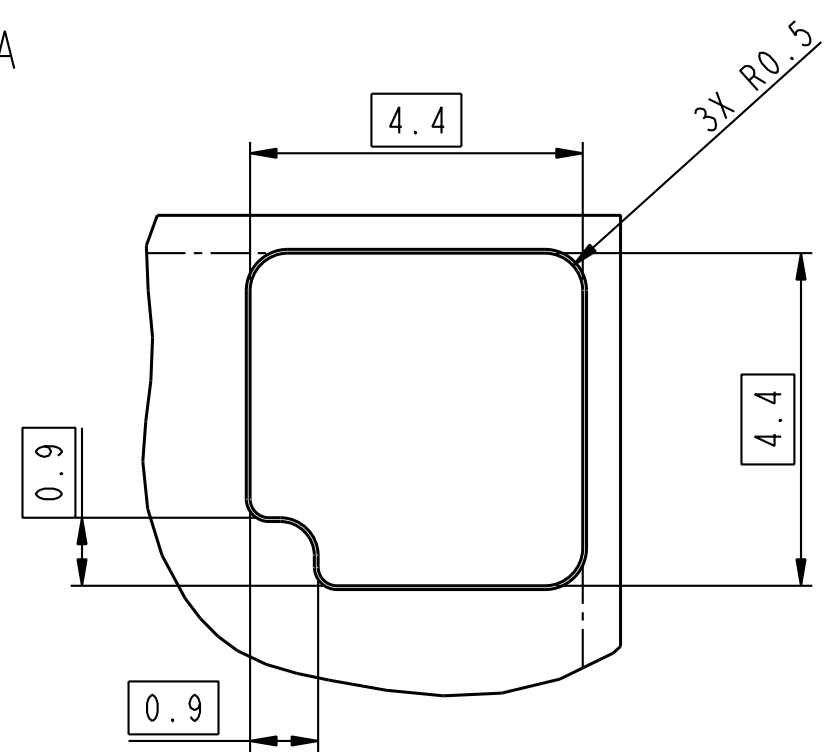

DETAIL A

CENTERLINE TO CENTERLINE SPACING: 25.4mm
SCALE 10:1
(4X)

Amphenol FCI

© 2016 AFCI

dr	M Streckewald	2016/07/08	projection	mm	size	A3	scale	5:1
eng	M Streckewald	2017/09/30			ecn no			
chr	-	-			-			
appr	C Pendleton	2017/09/30	product family	-	rel level Released			
Amphenol FCI		title MBO SOCKET ASSEMBLY			dwg no		10140369	
www.fci.com		cat. no.			-		Product - Customer Drw	
		-			-		sheet 2 of 3	
		-			-		-	

PRODUCT NUMBER
10140369-101LF

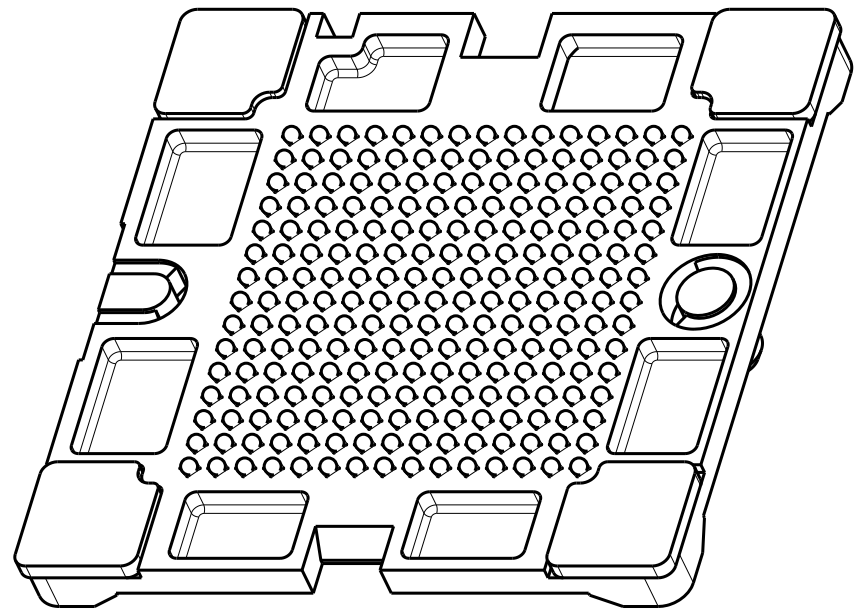

MBO SOCKET ASSEMBLY
WITHOUT PCB AND VACCUM CAP

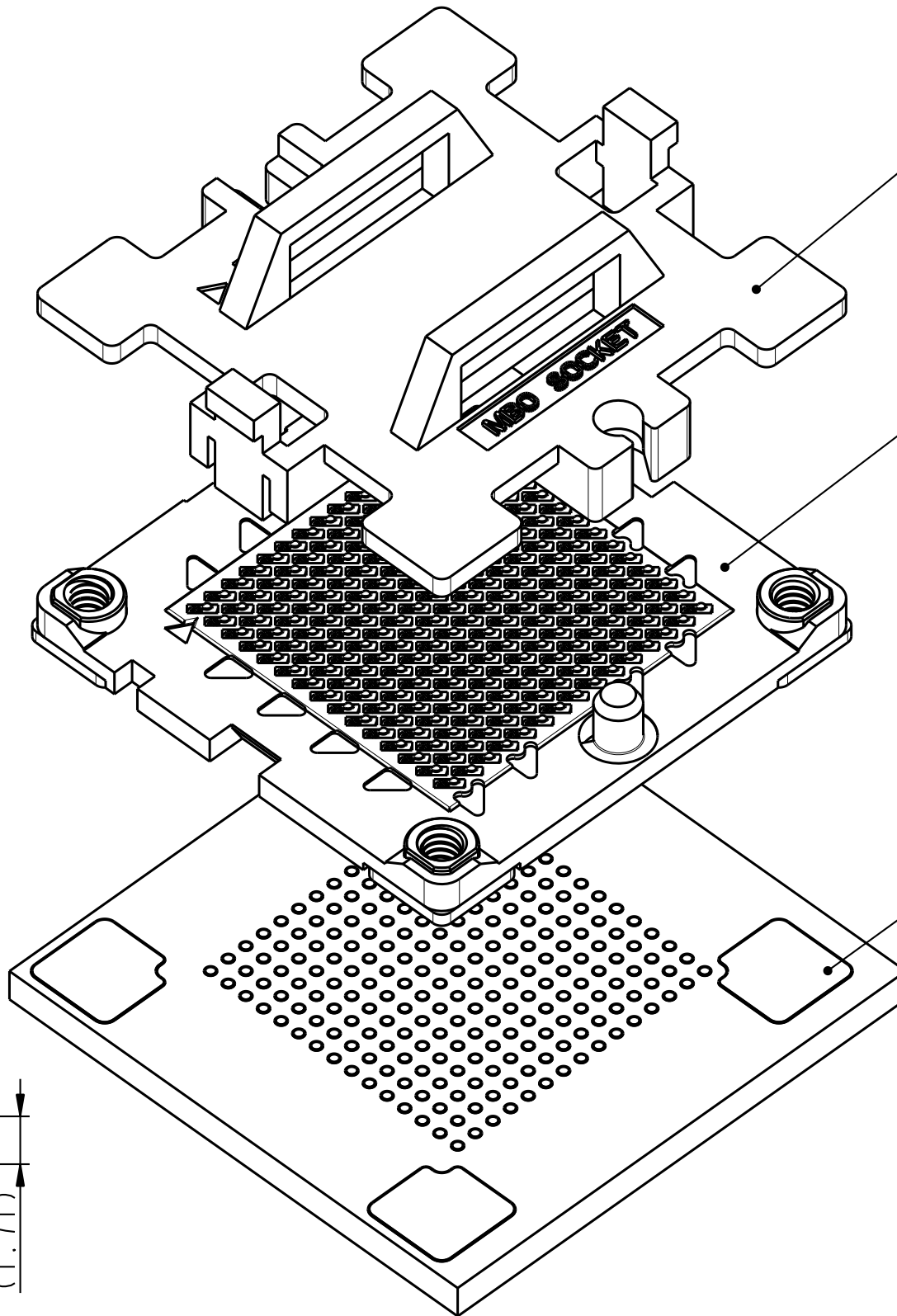

VACUUM CAP

MBO SOCKET ASSEMBLY

PCB
(SHOWN FOR
REFERENCE)

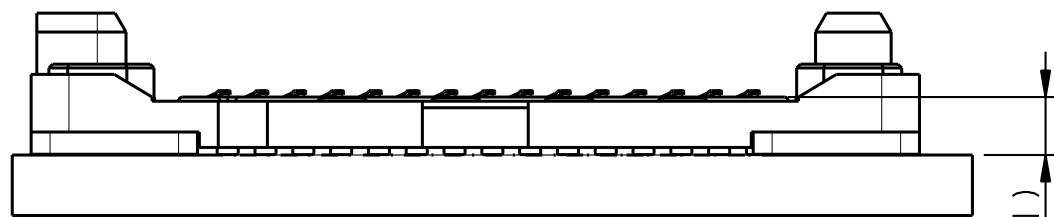

MBO SOCKET ASSEMBLY
WITHOUT VACCUM CAP ON BOARD

SCALE 5:1

(1.71)



dr	M Streckewald	2016/07/08	projection	mm	size	A3	scale	1:1
eng	M Streckewald	2017/09/30			ecn no		-	
chr	-	-			rel level		Released	
appr	C Pendleton	2017/09/30	product family		-			
Amphenol FCI		title MBO SOCKET ASSEMBLY INTERPOSER REL			dwg no 10140369	rev A		
www.fci.com		cat. no.	-		Product - Customer Drw		sheet 3 of 3	

X-ON Electronics

Largest Supplier of Electrical and Electronic Components

Click to view similar products for [I/O Connectors](#) category:

Click to view products by [Amphenol](#) manufacturer:

Other Similar products are found below :

[571763P](#) [58098-0628](#) [61-168618-12P](#) [D38999/20FJ24PA L/C](#) [D38999/20FJ29SB L/C](#) [D38999/24FG11SN L/C](#) [72.250.1628.2](#) [72.250.2428.2](#)
[74720-0505](#) [76.350.0729.0](#) [76871-1403](#) [FCN-244F080-G/1](#) [FCN-260A9920](#) [FCN-268D024-G/2F#10X-R10](#) [PCS-E50FA](#) [PCS-XE26LKA](#)
[PCS-XE26MA+](#) [PCS-XES68MS+](#) [G38A71314B](#) [91-569719-35R](#) [9776-18-6](#) [DX40-50P\(55\)](#) [1571250010](#) [157-22500-3](#) [MS3476W12-10S](#)
[L/C](#) [1888020-8](#) [91-569786-35H](#) [91-569786-35M](#) [91-644626-35P](#) [172501-4002](#) [172501-6002](#) [FCN-260C008-A/L0](#) [FCN-260C024-AL0](#)
[FCN-261Z008](#) [FCN-268D008-G/1K](#) [2000314-1](#) [200331-1](#) [2007498-2](#) [PCR-E28LMDAG1+](#) [PCR-E36FC+](#) [PCS-E28FS+](#) [PCS-XE26SLFD+](#)
[PCS-XE26SLFDT+](#) [G38A71214B](#) [HDRA-E68W1LFDTC-SL+](#) [HDR-E14MSG1+](#) [R88A-CNK81S](#) [CRT1-ATT02](#) [54182-0605](#)
[U90B2054081210](#)