

| PART NUMBER | DIMENSIONS | | | | IDENT NUMBER | RELEASE | COMMENT |
|-------------|-------------------------|------|------|-------|--------------|-----------|----------|
| | A DIA +.000 -.010 | B | C | D DIA | | | |
| 10-150913-6 | .392 | .719 | .234 | .202 | 62 | 32508-133 | 22553-47 |
| -8 | .516 | ↓ | | .327 | 82 | | |
| -10 | .642 | .706 | | .444 | 102 | | |
| -12 | .766 | .719 | | .558 | 122 | | |
| -14 | .892 | | | .683 | 142 | | |
| -16 | 1.018 | | | .808 | 162 | | |
| -18 | 1.142 | ↓ | | .909 | 182 | | |
| -20 | 1.268 | .781 | | 1.034 | 202 | | |
| -22 | 1.392 | .781 | | 1.159 | 222 | | |
| ↓ -24 | 1.518 | .781 | ↓ | 1.284 | 242 | 33524-601 | 22698-25 |

10-150913

| REL | 32508-133 | WAS | DATE | D'MAN | APPD. |
|-----|-----------|--|---------|-----------|--------|
| 1 | CNR | REM. 3 KNOBS EQUALLY SPACED ADD. IDENT NUMBER COLUMN, NOTE 4 | 3-1-57 | A.NILES | |
| 2 | 33524-571 | ADD -24 & DATA | 6-9-58 | A.NILES | |
| 3 | 33524-601 | RELEASE -24 | 8-8-58 | FEN | |
| 4 | 34281-1 | REM FLASH PERMISSIBLE (1 PLACE) | 8-13-58 | Lambrecht | |
| 5 | 36878-2 | ADD .125 MIN, NOTE 5. | 7-1-60 | RICKS | |
| 6 | 38330-1 | ADD. NOTE 6 | 6-6-61 | DYKEMAN | |
| AI | 44781-1 | (MFG); ADD. NOTE 7 | 5-17-65 | Lambrecht | |
| B | 20079 | (CL D) WAS .719 (-10) | 1/19/88 | Melligot | Nesbit |
| C | 20603 | (CL D) WAS .031±.010 (.031+.015-.010) | 7-21-88 | Melligot | Nesbit |

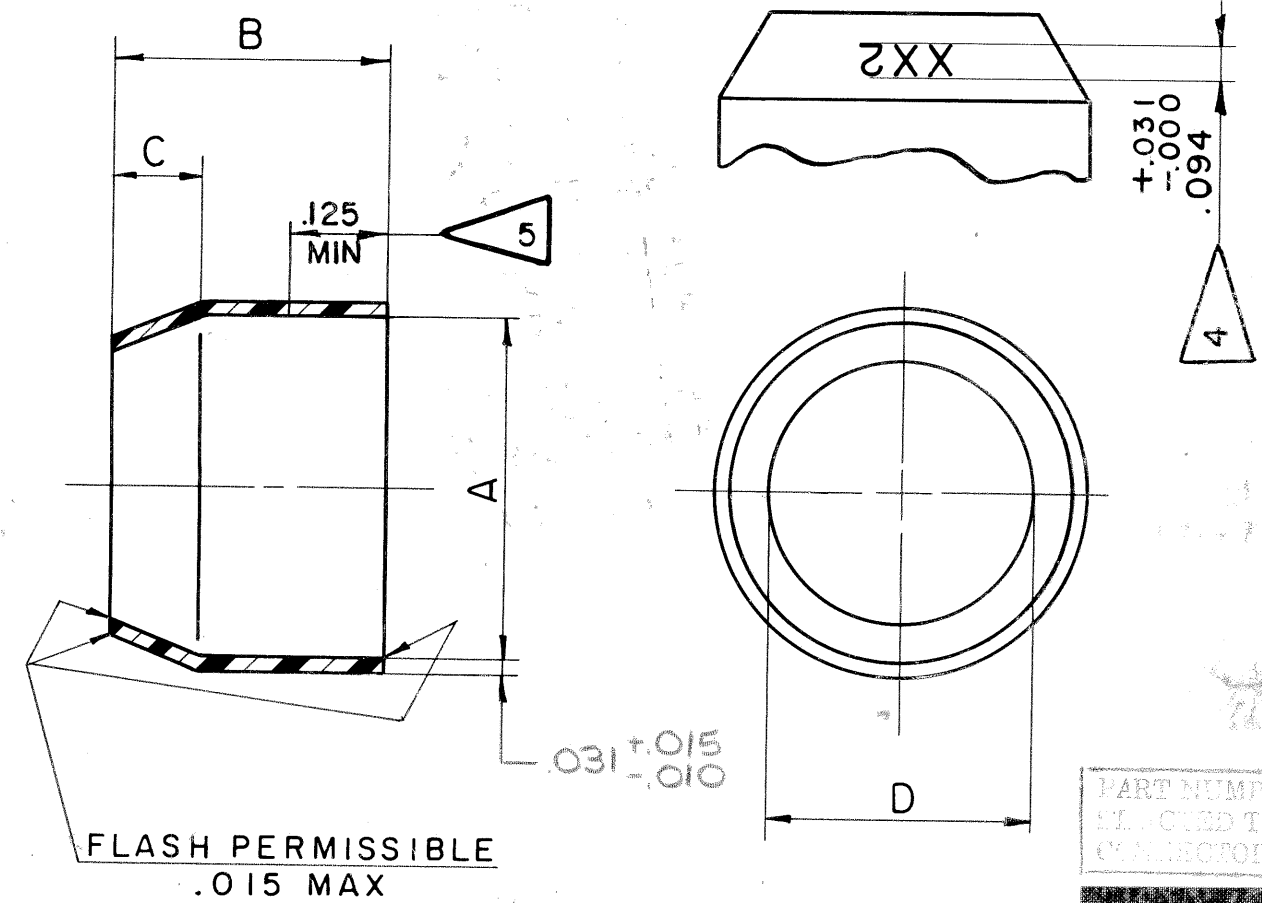

NOTE: REF SYMBOL <

7. PARTS SHALL BE CLEANED AFTER MOLDING TO REMOVE FOREIGN MATERIAL.
6. ANNEAL PARTS IMMEDIATELY AFTER MOLDING AND MOISTURE CONDITION TO APPROXIMATELY 2.5 PER CENT.
5. TOLERANCE OF A DIAMETER TO BE APPLICABLE FOR INDICATED LENGTH.
4. IDENTIFICATION NUMBER TO BE LOCATED IN RELATIVE POSITION SHOWN ON INSIDE OF END BELL. NUMBERS TO BE RAISED .006-.010.
3. PARTS TO BE TRANSPARENT TO TRANSLUCENT.
2. E. I. DUPONT DE NEMOURS & CO, INC ZYTEL 101.
1. ENGINEERING SOURCE APPROVAL REQUIRED.

| | | | | | | | | | | | |
|---|---------------|--|--|-------------------|------------------|---|---------------|--------------------|------------------|-------------------|--|
| MATERIAL SPEC. NYLON SEE NOTES 1 & 2 | PROCESS SPEC. | SCINTILLA MAGNETO DIVISION BENDIX AVIATION CORPORATION SIDNEY, N. Y., U.S.A. | | | | TOLERANCES UNLESS OTHERWISE SPECIFIED FRACTIONS ± 1/32 DECIMALS ± .010 ANGLES ± 2° CONCENTRICITY .015 FIR. BREAK SHARP EDGES .010-.030 SQUARENESS .010 PER INCH OF LENGTH MACHINED SURFACES MUST BE FLAT AND PARALLEL WITHIN THE TOLERANCE OF THE APPLICABLE DIMENSION AND SMOOTH WITHIN 200 MICRO-INCHES RMS. | | | | | |
| HEAT TREAT SPEC. | FINISH SPEC. | NAME END BELL, POTTING, ELECTRICAL CONNECTOR, TYPE BT () | | | | NEXT ASSEMBLY 72-105606 THRU 72-105650 72-127006 THRU 72-127050 | WEIGHT - LBS. | | | | |
| TOOL ACC. | | COM. R: ABOVE | | D'MAN VIMISLIK | CHECKER Rudak | MAT. CP | ST'DS Whit | CH. D'MAN Dunne | APPROVED Whit | SCALE NONE | SUPERSEDES AND IS NOT INTERCHANGEABLE |
| | | | | 1-29-57 | 3-5-57 | 8-4-57 | 3-6-57 | 3-8-57 | 3-8-57 | REF. 10-117913 | 10-150913 |

PART NUMBER USAGE DE
SELECTED TO ELECTRIC
CONNECTOR DESIGN GROUP

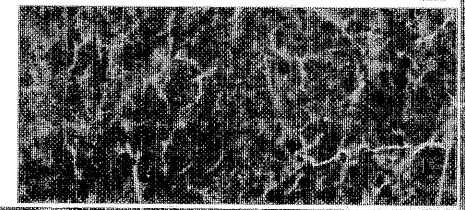

X-ON Electronics

Largest Supplier of Electrical and Electronic Components

Click to view similar products for [Circular MIL Spec Tools, Hardware & Accessories](#) *category:*

Click to view products by [Amphenol](#) *manufacturer:*

Other Similar products are found below :

[0113-201-2025](#) [600-079-06](#) [600-146-06](#) [M10-101983-183](#) [M10-454396-008](#) [602GB18808](#) [CS3102A-22-14PW](#) [M2887615-CD](#) [627-009](#)
[M38999/9-19B](#) [630A007NF083A](#) [630B007M051A](#) [630BJ003NF032H](#) [637-149NF04B](#) [M39029/29-215](#) [6408-203V-09273](#) [6426-201-11343](#)
[650FS002NF16](#) [660-008NF14S7-01](#) [660-009M22H8-03](#) [660-013NF19U6-210](#) [660-015M10S6-17](#) [660-015NF10S5-01](#) [660-015NF14R3.5-01](#)
[660-023NF19H6-19](#) [660-024NF11S12-01](#) [660-024NF11S3-01](#) [660-024NF17S4-109](#) [660-050XM17F4-01](#) [660-068NF25R6-30G](#) [660-](#)
[070M23S8-04](#) [660-073MTCH9-20](#) [M83723/61-18W](#) [M83723/61-218R](#) [M83723/61-224W](#) [667-084-23C](#) [667-084-35C](#) [667-224NF16](#) [687-](#)
[697NF-1](#) [M85049/94-10-A](#) [M85049/96-7-A](#) [M855282-10A01A](#) [M85528/2-10B](#) [M855282-18A01A](#) [M85528/2-22A01A](#) [M85528/2-22AA](#)
[710HS460NF2508](#) [780-001-22G12-SK](#) [780-002-19G12-SK](#) [780-002-20G12SK](#)