

REV. A	SHEET 1 OF 1	918-766995-01
REVISIONS		
LTR	DESCRIPTION	DATE
A	INITIAL RELEASE	

KIT PART NUMBER	CONNECTOR PART NUMBER	KIT TYPE	PCB PART NUMBER	CONTACTS QTY.	MS REF NUMBER	CAP/CONTAINER
10-565997-816N	88-565759-35S	II	10-497623-015	128	D38999/24WJ35BN	10-576238-002 10-576237-002
10-565997-816A	88-565759-35H				D38999/24WJ35BA	
10-565997-816B	88-565759-35J				D38999/24WJ35BB	
10-565997-816C	88-565759-35L				D38999/24WJ35BC	
10-565997-816D	88-565759-35N				D38999/24WJ35BD	
10-565997-816E	88-565759-35T				D38999/24WJ35BE	

**FOR UNIT ILLUSTRATION AND DIMENSIONAL DATA
SEE 10-536197-DS TYPE I**

ALTERNATE SHELL ROTATION

SEE NOTE 1

CONNECTOR LESS STAMPING
SEE NOTE 4
FOR STAMPING REQUIREMENT

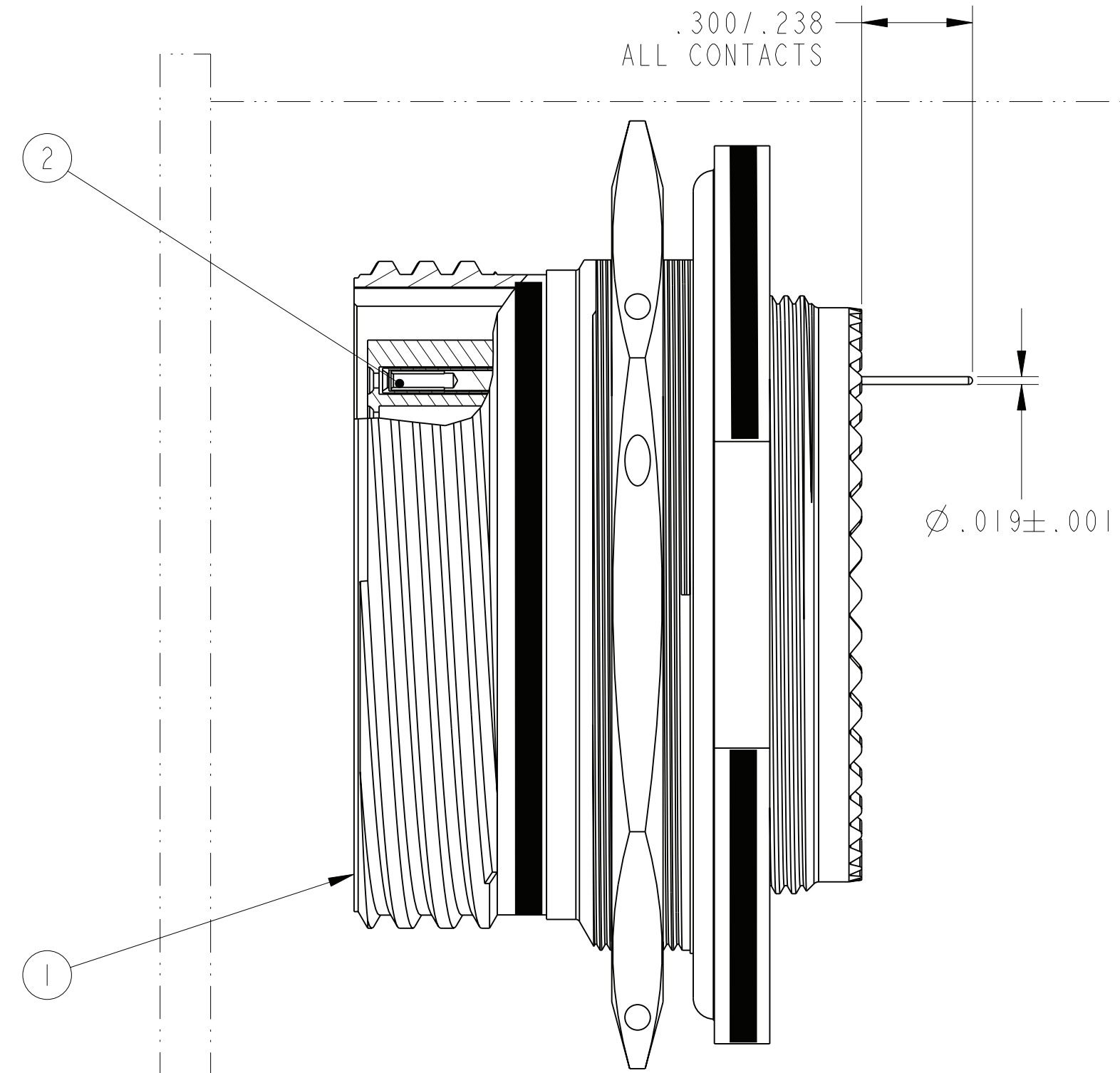
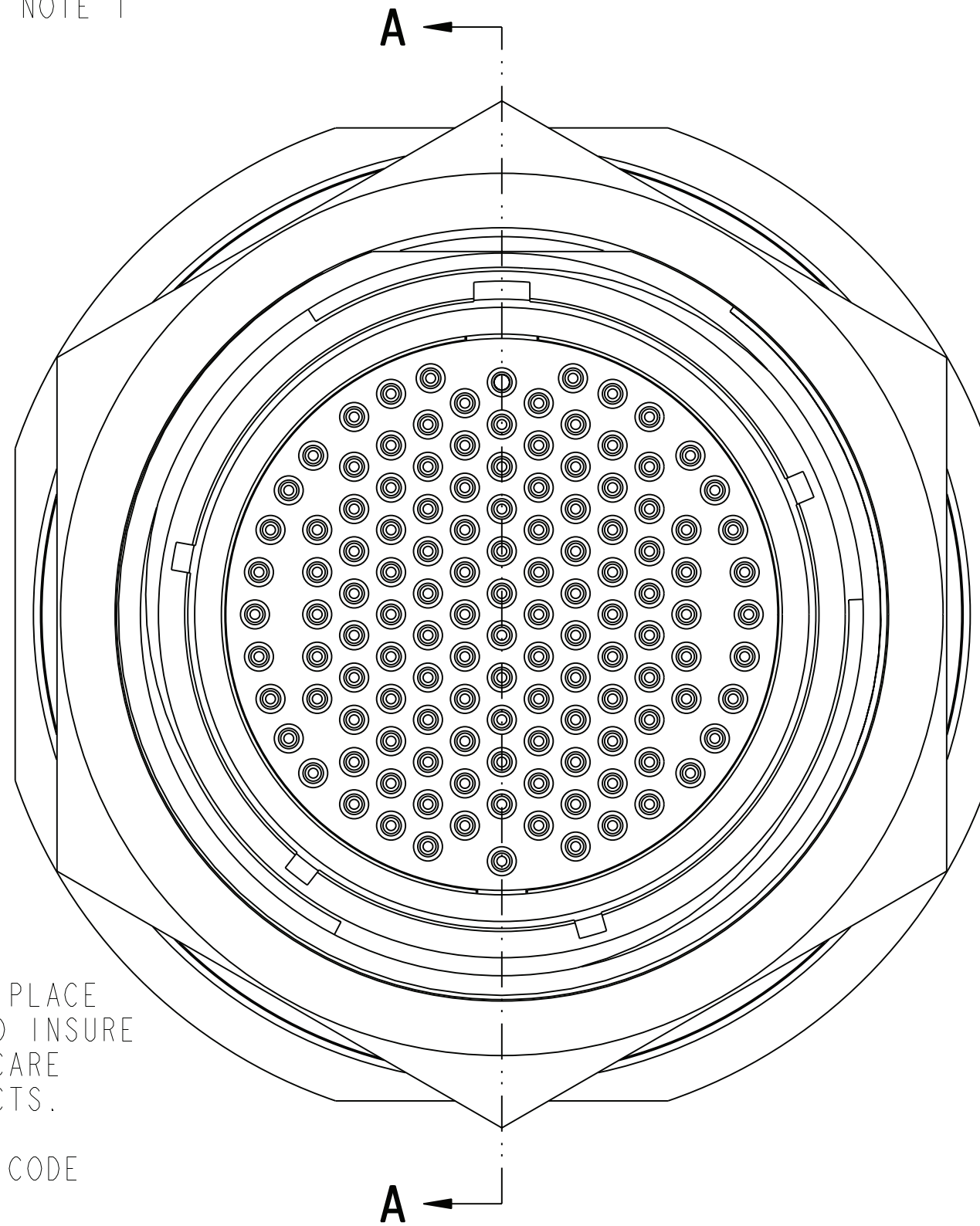

5. AFTER CONTACTS HAVE BEEN INSTALLED, PLACE CONNECTOR INTO CONTAINER AND CAP. TO INSURE CAP LOCATION APPLY TAPE IF NEEDED. CARE MUST BE TAKEN NOT TO BEND THE CONTACTS.

4. STAMP "AMPHENOL", PART NUMBER, DATE CODE (9-3895), AND LOT NUMBER PER 9-5788
EXAMPLE:
AMPHENOL 10-565997-816B 0938 001000

3. PROCESS SPEC::
SPECIAL CONTROL 9-6000-2
PROCESS SHEET CONTROL 9-4796
9-3895, 9-5788

2. PACKAGE PER PRODUCTION PROCESS SHEET.

1. KIT TYPE I CONTACTS ARE SHIPPED UNASSEMBLED.
KIT TYPE II CONTACTS ARE SHIPPED ASSEMBLED IN CONNECTOR.

NOTES:

THE USE OF THIS DOCUMENT IS UNLIMITED. HOWEVER, DOCUMENTS REFERENCED HEREON MAY CONTAIN LIMITED RIGHTS DATA.

PRO/ENGINEER INFORMATION	
N/A	Pro/e Model Used:
N/A	10-565997-481.ASSEM
N/A	Drawing Name:
N/A	10-565997-816

UNLESS OTHERWISE SPECIFIED	SPECIFICATIONS
LINEAR DIMENSIONS ARE IN INCHES TOLERANCES: .XXXX = ±.0005 ANGLES= ±2° .XXX = ±.010 .XX = ±.03 .X = ±.1	MATERIAL SPEC. N/A
DIM. & TOL. PER ASME Y14.5M; DRM PER MIL-DTL-31000; OTHER Amphenol Sds. PER 9-3800	PROCESS SPEC. SEE NOTE 3
LEGENDS: = FLAG NOTE CALL OUT REFERENCE ONLY	

POS	QTY	PART NUMBER	DESCRIPTION	NOTE
3	I	SEE COLUMN	CAP/CONTAINER	5
2		SEE COLUMN	CONTACT	
1	I	SEE COLUMN	CONNECTOR	

APPROVALS		DATE
PREPARED BY	D. ALGER	26-SEPT-09
ENGINEER IN CHARGE	D. FREAR	
DESIGN MANAGER	E. SHEPLER	
DESIGN ACTIVITY GROUP	MILAERO	

PARTS LIST			
AMPHENOL CORPORATION 40-60 DELAWARE AVENUE SIDNEY, N.Y. 13839			
CONNECTOR KIT, TYPE MS AB-STAMPING, D38999/24WJ35B()			
SIZE C	CAGE CODE 77820	DOCUMENT NO. 10-565997-816	REV. A
SCALE: 4.0 REF: 88-565750/759		SHEET 1 OF 1	

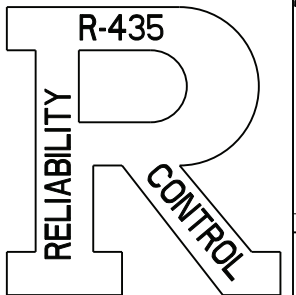

RELEASED / Oct . 05 2009, 2:24:56 PM

X-ON Electronics

Largest Supplier of Electrical and Electronic Components

Click to view similar products for [Circular MIL Spec Contacts](#) category:

Click to view products by [Amphenol](#) manufacturer:

Other Similar products are found below :

[006-1189-20](#) [M39029/106-616](#) [71-VEAM](#) [809-023](#) [809-111](#) [811393-000](#) [850-014](#) [97-45-1418P-5\(920\)](#) [97-45-1418S-4](#) [D-602-0106CS076](#)
[AIC12-14P](#) [AIC16-16PG](#) [AIC8-12P](#) [AIC8-8SG](#) [AIC8-8SRAD](#) [1495044-1](#) [BACC47CP2T](#) [BACC47CP3S](#) [BACC47DP4](#) [BACC47GC1A](#)
[BACC47GN1](#) [16968/2C](#) [173-900245-91](#) [241611N001](#) [2560-220-2031](#) [27915-38T9](#) [27964-38T112](#) [2M809-118](#) [97-67-36-20](#) [AIC12-16P](#)
[AIC16-14SG](#) [AIC16-18PG](#) [AIC16-18S](#) [AIC16-20PG](#) [AIC4-4PG](#) [CE102S-18](#) [M39029/30-221](#) [M39029/77-430](#) [416-2020-088I](#) [MDM-](#)
[21SH003B-F222](#) [BA-4120-50LD](#) [BACC47CN2](#) [BACC47GC3A](#) [BACC47GD3A](#) [BACC47GM1](#) [52G137 REV A](#) [CB2-18-21PS](#) [D-602-](#)
[1116CS2727](#) [D-602-1117CS2727](#) [419-2082-102](#)