

REV	DATE	DESCRIPTION
NC	07/23/04	INITIAL RELEASE

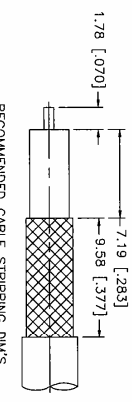
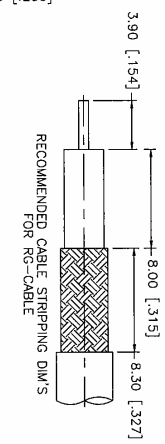
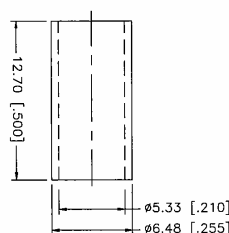
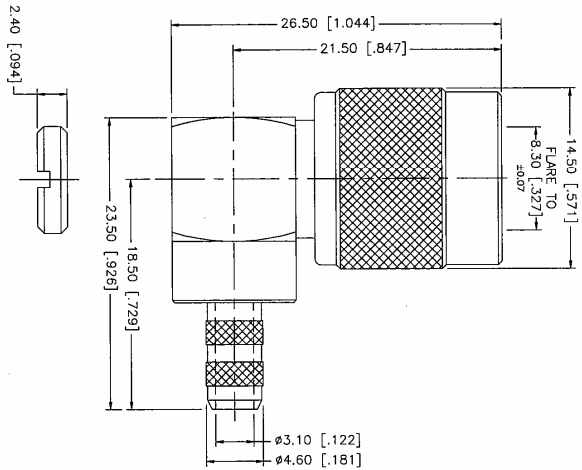

NOTES:
 1. CRIMPED FERRULE HEX SIZE :213*
 2. SOLDER CENTER CONTACT.

RECOMMENDED CABLE STRIPPING DIM'S
 FOR 6 GHz PERFORMANCE CABLE WITH FOLD BRAND.
 ELECTRICAL:
 A) IMPEDANCE: 50ohms
 B) FREQUENCY RANGE: DC-6 GHz
 C) VSWR (RETURN LOSS): 1.4 (13.5dB), MAX.
 D) DIELECTRIC WITHSTANDING VOLTAGE:
 1500 VRMS, MIN.

QTY	FINISH	MATERIAL	DESCRIPTION
1	NICKEL	BRASS	BODY
1	NATURAL	TEFLON	INSULATOR
1	GOLD	PHOS. BRONZE	CONTACT PIN
1	NICKEL	COPPER	FERRULE
1	NICKEL	BRASS	NUT

APPROVALS	DATE	APP. NO.	REV.	SCALE
DRWN: G.R.S.	07/23/04	122140RP DWG	NC	NA

Amphenol Connex

TNC REVERSE POLARITY R/A CRIMP PLUG
 (FOR RG-58/U, 58C/U CABLE)

122140RP

UNLESS OTHERWISE SPECIFIED DIMENSIONS ARE IN MILLIMETERS (IN PARENTHESES). DIMENSIONS FOR MILLIMETERS ARE 0.5 - 8mm ± 0.20mm 8 - 120mm ± 0.30mm 120 - 150mm ± 0.50mm UNLESS OTHERWISE SPECIFIED TOLERANCES FOR INCHES ARE 0.20 - 0.315 ± 0.0075 0.315 - 1.180 ± 0.015 1.180 - 4.724 ± 0.020 DO NOT SCALE DRAWING

X-ON Electronics

Largest Supplier of Electrical and Electronic Components

Click to view similar products for [RF Connectors / Coaxial Connectors](#) category:

Click to view products by [Amphenol](#) manufacturer:

Other Similar products are found below :

[8915-1511-000](#) [89674-0827](#) [6001-7071-019](#) [6002-7051-003](#) [6002-7551-202](#) [6059674-1](#) [619550-1](#) [630059-000](#) [M39030/3-01N](#) [M3933/25-36N](#) [6500-7071-046](#) [6769](#) [CX050L2AQ](#) [7002-1542-011](#) [7004-1512-000](#) [7009-1511-004](#) [7010-1511-000](#) [7029-1511-060](#) [7101-1541-010](#) [7101-1571-002](#) [7105-1521-002](#) [7145-1521-002](#) [7203-1571-003](#) [7209-1511-011](#) [7210-1511-015](#) [7210-1511-019](#) [73137-5015](#) [73216-2241](#) [7325-1512-000](#) [73404-2300](#) [7405-1521-005](#) [7405-1521-802](#) [7406-1521-005](#) [8527](#) [8547](#) [FS11V](#) [8808-1511-001](#) [9049-9513-000](#) [9074-9513-000](#) [9101-9573-002](#) [910A205F](#) [9130-9573-002](#) [PL11SC-026](#) [PL375-33](#) [PL40-5](#) [PL71-9](#) [PL74C-221](#) [PL75MC-217](#) [PL803-7](#) [980-8666-005](#)