

REV.	DATE	DESCRIPTION
NC	06/12/02	INITIAL RELEASE

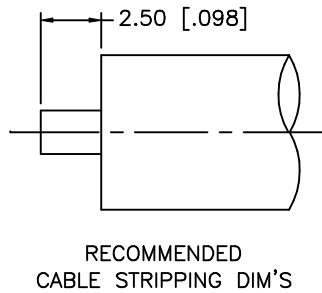
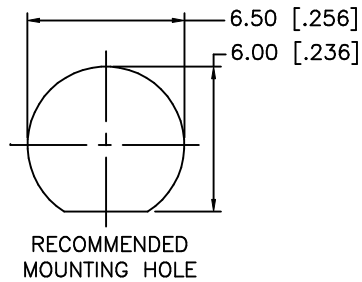
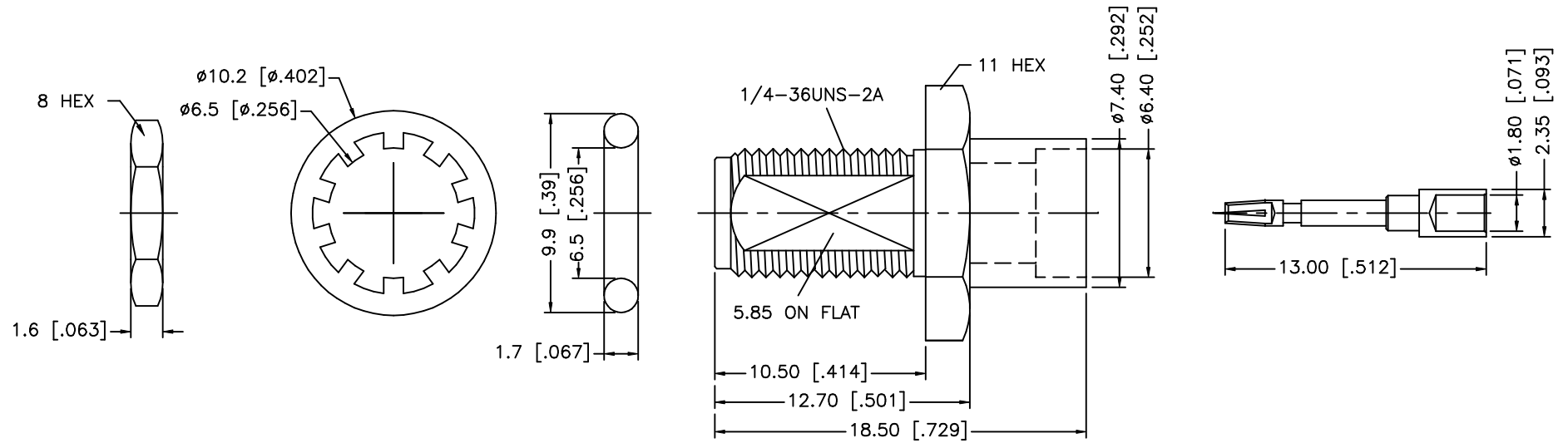

CRIMP NOTES:

1. SOLDER CENTER CONTACT
2. MAX. PANEL THICKNESS = 2.4mm

8				UNLESS OTHERWISE SPECIFIED DIMENSIONS ARE IN MILLIMETERS	APPROVALS	DATE	<b>Amphenol - Connex</b> CONNECTOR CORPORATION				
7					DRAWN	G.R.S.					06/12/02
6	HEX NUT	BRASS	GOLD		DIMENSIONS IN [ ] ARE IN INCHES FOR CUSTOMER REFERENCE ONLY	CHECKED		TITLE SMA DIRECT SOLDER BULKHEAD JACK (.250 SEMI RIGID CABLE)			
5	LOCK WASHER	BRASS	GOLD		UNLESS OTHERWISE SPECIFIED TOLERANCES FOR INCHES ARE:	ISSUED		SIZE	FSCM NO.	DWG. NO.	REV.
4	GASKET	RUBBER	RED	.XXX = ± 0.005"			A	99001	132346.DWG	NC	
3	CONTACT PIN	BER. COPPER	GOLD	.XX = ± 0.010"			SCALE	PART NO.	SHEET		
2	INSULATOR	TEFLON	NATURAL	.X = ± 0.020"			NA	132346	1 OF 1		
1	BODY	BRASS	GOLD	DO NOT SCALE DRAWING							

## X-ON Electronics

Largest Supplier of Electrical and Electronic Components

*Click to view similar products for [RF Connectors / Coaxial Connectors](#) category:*

*Click to view products by [Amphenol](#) manufacturer:*

Other Similar products are found below :

[8915-1511-000](#) [89674-0827](#) [6001-7071-019](#) [6002-7051-003](#) [6002-7551-202](#) [6059674-1](#) [619550-1](#) [630059-000](#) [M39030/3-01N](#) [M3933/25-36N](#) [6500-7071-046](#) [6769](#) [CX050L2AQ](#) [7002-1542-011](#) [7004-1512-000](#) [7009-1511-004](#) [7010-1511-000](#) [7029-1511-060](#) [7101-1541-010](#) [7101-1571-002](#) [7105-1521-002](#) [7145-1521-002](#) [7203-1571-003](#) [7209-1511-011](#) [7210-1511-015](#) [7210-1511-019](#) [73137-5015](#) [73216-2241](#) [7325-1512-000](#) [73404-2300](#) [7405-1521-005](#) [7405-1521-802](#) [7406-1521-005](#) [8527](#) [8547](#) [FS11V](#) [8808-1511-001](#) [9049-9513-000](#) [9074-9513-000](#) [9101-9573-002](#) [910A205F](#) [9130-9573-002](#) [PL11SC-026](#) [PL375-33](#) [PL40-5](#) [PL71-9](#) [PL74C-221](#) [PL75MC-217](#) [PL803-7](#) [980-8666-005](#)