

Recommended P.C.B. Layout
Layout Tolerance = ± 0.05 mm

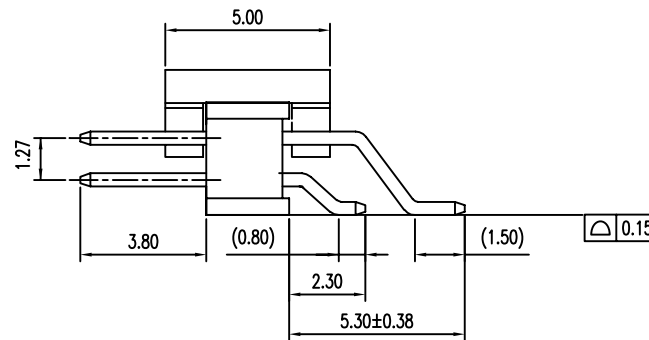

NOTE:

- MATERIAL,
HOUSING: HIGH TEMP PLASTIC, UL94-V0, BLACK
TERMINAL: COPPER ALLOY, SQ=0.40±0.03MM
- FINISH:
TERMINAL: GOLD AT CONTACT,
G/F OVER 1um(40u") MIN Ni OVER ALL
- SPEC.:
PRODUCT SPEC: GS-12-629
PACKING SPEC: GS-14-1420
- THE HSG. WILL WITHSTAND EXPOSURE TO 260°C
PEAK TEMP. FOR 10 SEC. IN A CONVECTION INFRA-RED
OR VAPOR PHASE REFLOW OVEN.
- THE TOLERANCE OF THIS DIMENSION

2-60 PINS	± 0.20
62-98 PINS	± 0.30

- PRODUCT NUMBERING:
20021122 - 0 0 0 XX X X LF

LEAD FREE
PLATING:
1: GOLD FLASH ALL OVER
4: 0.25um(10U") GOLD AT CONTACT
8: 0.76um(30U") GOLD AT CONTACT
9: 1u" GOLD OVER 30u" PdNi AT CONTACT
PACKING
T: TUBE
D: TUBE + CAP
C: REEL + CAP
PIN COUNT
06, 08, 10, ..., 98
(8 - 98 EVERY EVEN PIN)

mat'l. code		surface		tolerance		projection		product family	
		ISO1302		ISO1101 ISO406		MM		MINITEK	
ltr	ecn no	dr	date	tolerances unless otherwise specified		MM		title	
A	T09-1117	S.LIN	09/15/09	angles	0.X±0.38	MM		1.27X1.27MM BTB HEADER	
B	T09-1155	S.LIN	12/03/09	0°±2'	0.XX±0.25	MM		UNSHROUDED SMT	
C	T10-0014	S.LIN	01/28/10	0°±2'	0.XXX±0.10	scale 5:1		sheet. 1 of 1 size	
D	T11-0029	S.LIN	06/14/11	dr	STERLING LIN	09/15/09		dwg no	
E	ELX-N-010358	ZK	01/16/12	engr	STERLING LIN	09/15/09		20021122	
F	ELX-N-010619	ZK	03/12/12	chr	GRAY HSIEH	09/15/09		A4	
G	ELX-N-16465	TIM	12/06/13	appd	JOSEPH	09/15/09		type Product Customer Drawing	
sheet	revision	G							
index	sheet	1							

X-ON Electronics

Largest Supplier of Electrical and Electronic Components

Click to view similar products for [Headers & Wire Housings](#) category:

Click to view products by [Amphenol](#) manufacturer:

Other Similar products are found below :

[892-18-020-10-001101](#) [58102-G61-06LF](#) [582553-1](#) [0009485154](#) [009176003701906](#) [0050291907](#) [LY20-4P-DT1-P1E-BR](#) [02.125.8002.8](#)
[609-3404](#) [61062-3](#) [622-0430](#) [622-3653LF](#) [63453-116](#) [636-1030](#) [636-1427](#) [636-3427](#) [636-4007](#) [641938-9](#) [641991-4](#) [644827-2](#) [65817-010LF](#)
[65817-015LF](#) [65863-015LF](#) [66207-023LF](#) [67095-007LF](#) [67601157](#) [68648-049](#) [70.362.1628.0](#) [70-4210](#) [70-4226B](#) [70-4853B](#) [707-5020](#) [707-5028](#) [71.350.2428.0](#) [71918-208LF](#) [71961-016LF](#) [733-134](#) [733-162](#) [754199-000](#) [760-3052](#) [787-8014-00](#) [79531-3000](#) [FCN-360C032-B](#) [FCN-367T-T012/H](#) [FCN-723D010/2](#) [80.063.4001.1](#) [800-90-001-10-001000](#) [800-90-010-10-002000](#) [801-43-002-10-013000](#) [801-43-006-10-002000](#)