

Recommended P.C.B. Layout  
Layout Tolerance = ± 0.05 mm

TABLE 1 ,DIM INFORMATION

DASH No.	Dim.	Amount of Pins	Dim.A	Dim.B
-00X 06 XX LF	06	06	2.54	10.11
-00X 10 XX LF	10	10	5.08	12.65
-00X 12 XX LF	12	12	6.35	13.92
-00X 14 XX LF	14	14	7.62	15.19
-00X 16 XX LF	16	16	8.89	16.46
-00X 20 XX LF	20	20	11.43	19.00
-00X 22 XX LF	22	22	12.70	20.27
-00X 26 XX LF	26	26	15.24	22.81
-00X 30 XX LF	30	30	17.78	25.35

DASH No.	Dim.	Amount of Pins	Dim.A	Dim.B
-00X 34 XX LF	34	34	20.32	27.89
-00X 40 XX LF	40	40	24.13	31.70
-00X 44 XX LF	44	44	26.67	34.24
-00X 50 XX LF	50	50	30.48	38.05
-00X 60 XX LF	60	60	36.83	44.40
-00X 64 XX LF	64	64	39.37	46.94
-00X 68 XX LF	68	68	41.91	49.48
-00X 80 XX LF	80	80	49.53	57.10
-00X A0 XX LF	100	100	62.23	69.90

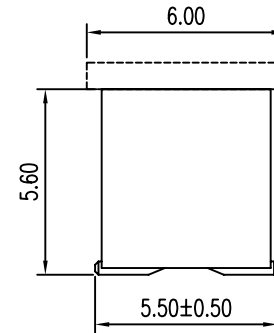

0.10 FOR 6-40 POS.  
0.12 FOR 40-100 POS.

DIM. A	2-60 PINS	± 0.20
	62-100 PINS	± 0.30

mat'l. code		surface ISO1302 ✓ tolerance ISO1101 ISO406		projection MM		product family MINITEK	
ltr		ecn no		dr		date	
H	ELX-N-011951	ZK	06/15/12				
J	ELX-N-14099	TIM	02/25/13				
K	ELX-N-17601	TIM	04/30/14				
L	ELX-N-19182	TIM	10/24/14	dr		STERLING LIN 09/15/09	
E	ELX-N-010364	ZK	01/16/12	engr		STERLING LIN 09/15/09	
F	ELX-N-010621	ZK	03/12/12	chr		GRAY HSEH 09/15/09	
G	ELX-N-011182	ZK	03/31/12	appd		JOSEPH 09/15/09	
sheet		revision		L		L	
index		sheet		1		2	
title		1.27X1.27MM BTB HEADER		UNSHROUDED SMT		scale 5:1	
dwg no		20021521		sheet. 1 of 2		size A4	
type		Product		Customer		Drawing	

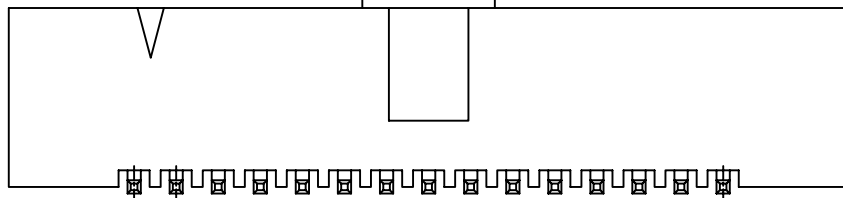
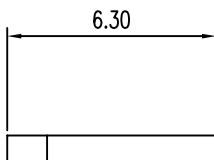
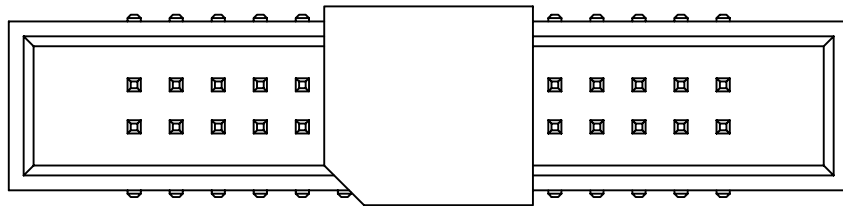

NOTE:

- 1. MATERIAL,  
HOUSING: HIGH TEMP PLASTIC, UL94-V0, BLACK  
TERMINAL: COPPER ALLOY, SQ=0.40±0.03MM
- 2. FINISH:  
TERMINAL: GOLD AT CONTACT,  
G/F OVER 1um(40u")MIN Ni OVER ALL
- 3. SPEC.:  
PRODUCT SPEC: GS-12-629  
PACKING SPEC: GS-14-1420
- 4. THE HSG. WILL WITHSTAND EXPOSURE TO 260C  
PEAK TEMP. FOR 10 SEC. IN A CONVECTION, INFRA-RED  
OR VAPOR PHASE REFLOW OVEN.
- 5. PRODUCT NUMBERING:  
20021521 - 0 0 X XX X X LF

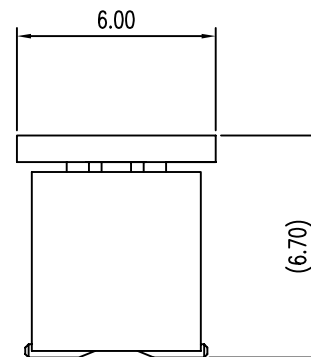

- LEAD FREE
- PLATING:  
1:GOLD FLASH ALL OVER  
4:0.25um(10u")GOLD AT CONTACT  
8:0.76um(30u")GOLD AT CONTACT  
9:1u" GOLD OVER 30u" PdNi AT CONTACT
- PACKING  
T: TUBE  
D: TUBE+CAP  
C: REEL+CAP(P:12mm)  
E: REEL+CAP(P:16mm)
- PIN COUNT  
SEE TABLE 1
- CONFIG  
0: NORMAL(CAP MATERIAL:NYLON)  
1: CONFIG 1(CAP MATERIAL:LCP)

CONFIG 1: 20021521-001XXXXLF  
WITH EDGE CUT CAP, OTHER DIMENSIONS SEE SHEET 1

mat'l. code		surface ISO1302 <input checked="" type="checkbox"/> ISO1101 ISO406		tolerance ISO1101 ISO406		projection 		product family MINITEK	
ltr		ecn no		dr		date		title	
L								1.27X1.27MM BTB HEADER UNSHROUDED SMT.	
				tolerances unless otherwise specified		MM		scale 5:1	
				angles		0.X±0.38		sheet. 2 of 2	
				0°±2'		0.XX±0.25		size A4	
				0.XXX±0.10		FCI		20021521	
		dr		STERLING LIN		09/15/09		type Product Customer Drawing	
		enr		STERLING LIN		09/15/09			
		chr		GRAY HSEH		09/15/09			
		app		JOSEPH		09/15/09			
sheet index		revision sheet							

## X-ON Electronics

Largest Supplier of Electrical and Electronic Components

*Click to view similar products for [Headers & Wire Housings](#) category:*

*Click to view products by [Amphenol](#) manufacturer:*

Other Similar products are found below :

[892-18-020-10-001101](#) [58102-G61-06LF](#) [582553-1](#) [0009485154](#) [009176003701906](#) [0050291907](#) [LY20-4P-DT1-P1E-BR](#) [02.125.8002.8](#)  
[609-3404](#) [61062-3](#) [622-0430](#) [622-3653LF](#) [63453-116](#) [636-1030](#) [636-1427](#) [636-3427](#) [636-4007](#) [641938-9](#) [641991-4](#) [644827-2](#) [65817-010LF](#)  
[65817-015LF](#) [65863-015LF](#) [66207-023LF](#) [67095-007LF](#) [67601157](#) [68648-049](#) [70.362.1628.0](#) [70-4210](#) [70-4226B](#) [70-4853B](#) [707-5020](#) [707-5028](#) [71.350.2428.0](#) [71918-208LF](#) [71961-016LF](#) [733-134](#) [733-162](#) [754199-000](#) [760-3052](#) [787-8014-00](#) [79531-3000](#) [FCN-360C032-B](#) [FCN-367T-T012/H](#) [FCN-723D010/2](#) [80.063.4001.1](#) [800-90-001-10-001000](#) [800-90-010-10-002000](#) [801-43-002-10-013000](#) [801-43-006-10-002000](#)