

REV.	DATE	DESCRIPTION
A	04/27/99	CHANGE PLATING SPEC. / UPDATE DWG.
B	05/01/04	UPDATE DRAWING FORMAT
C	02/21/06	MODIFY BODY DIMENSIONS

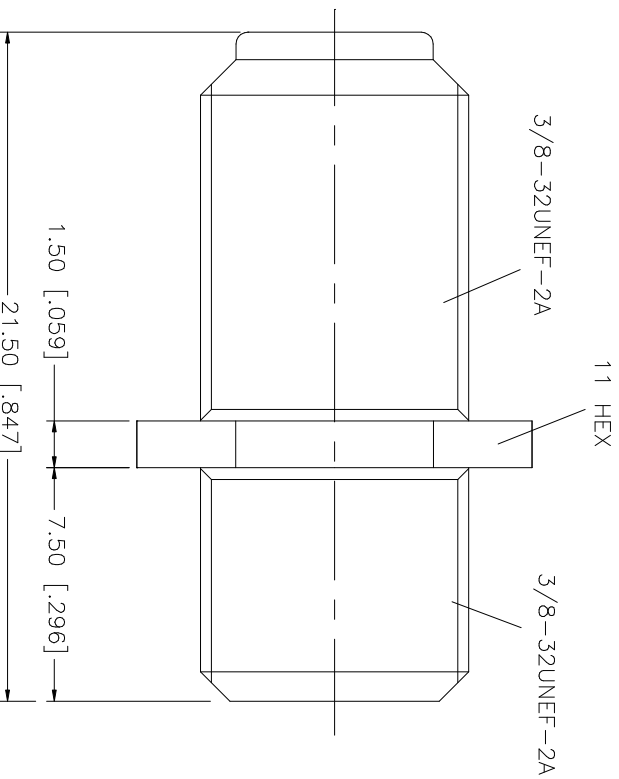
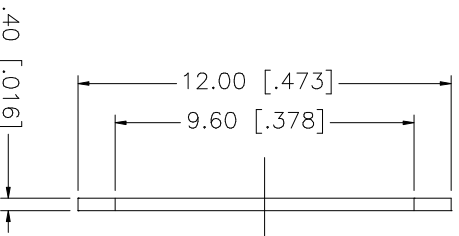
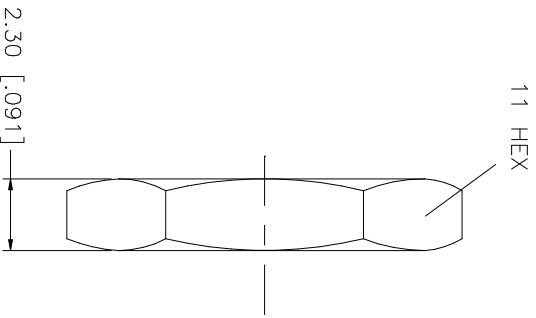

8						<small>UNLESS OTHERWISE SPECIFIED DIMENSIONS ARE IN MILLIMETERS. DIMENSIONS IN [] ARE IN INCHES AND FOR CUSTOMER REFERENCE ONLY.</small> <small>UNLESS OTHERWISE SPECIFIED TOLERANCES FOR MILLIMETERS ARE: 0.5 - 8mm ± 0.20mm 8 - 30mm ± 0.40mm 30 - 120mm ± 0.50mm</small> <small>UNLESS OTHERWISE SPECIFIED TOLERANCES FOR INCHES ARE: .020 - .315 = ± 0.007" .315 - 1.180 = ± 0.015" 1.180 - 4.724 = ± 0.020"</small>	<table border="1"> <thead> <tr> <th>APPROVALS</th> <th>DATE</th> </tr> </thead> <tbody> <tr> <td>DRAWN G.R.S.</td> <td>02/21/06</td> </tr> <tr> <td>CHECKED</td> <td></td> </tr> <tr> <td>ISSUED</td> <td></td> </tr> <tr> <td>SHEET 1 OF 1</td> <td></td> </tr> </tbody> </table>	APPROVALS	DATE	DRAWN G.R.S.	02/21/06	CHECKED		ISSUED		SHEET 1 OF 1		Amphenol Connex PART DESCRIPTION F CONNECTOR PART NO. 222121
APPROVALS	DATE																	
DRAWN G.R.S.	02/21/06																	
CHECKED																		
ISSUED																		
SHEET 1 OF 1																		
7																		
6																		
5	HEX NUT	BRASS	NICKEL	1														
4	WASHER	BRASS	NICKEL	1														
3	CONTACT PIN	BRASS	BRIGHT TIN	1														
2	INSULATOR	P.P.	NATURAL	1														
1	BODY	DIECAST	NICKEL	1														
DESCRIPTION		MATERIAL	FINISH	QTY	DO NOT SCALE DRAWING													
		CAD FILE C:/222/222121DWG	DWG. NO. 222121.DWG	REV. C	SIZE A	SCALE NA												

X-ON Electronics

Largest Supplier of Electrical and Electronic Components

Click to view similar products for [RF Adapters - In Series category:](#)

Click to view products by [Amphenol manufacturer:](#)

Other Similar products are found below :

[5916-1103-603](#) [5918-1103-000](#) [5919-1503-000](#) [651A505](#) [82-5552](#) [9030-9523-502](#) [A0407000](#) [R114703000W](#) [R125704000](#) [R125771001](#)
[R141710000W](#) [R141723161](#) [R141730000](#) [R143730700](#) [R143770000](#) [R161703000W](#) [R161730000](#) [R161753000W](#) [R161791530W](#)
[R201705000](#) [R222705200](#) [R222M40010W](#) [R223703180](#) [R316754000](#) [R405006000](#) [R443162000](#) [AD78TL](#) [HRM-513S](#) [1996352-2](#)
[2157155-1](#) [252169-75](#) [AD158](#) [2101130-1](#) [252186](#) [R114704000W](#) [R114720000W](#) [R125705001](#) [R125705701](#) [R125771000](#) [R125771001W](#)
[R125791501W](#) [R127704001](#) [R127.870.001](#) [R127872001](#) [R141717000](#) [R142710000](#) [R142723000](#) [R143703000](#) [R143704000](#) [R143705700](#)