

NOTES:

1. MATERIALS AND FINISHES:  
 SLOTTED BODY - BeCu, NICKEL PLATED (.0000025 m [.000100 in] MIN THICK)  
 BODIES - BRASS, NICKEL PLATED (.0000025 m [.000100 in] MIN THICK)  
 FLANGES - DELRIN
2. COMPATIBLE WITH BOTH STAMPED AND MACHINED VERSIONS OF THE AFI-50 AND AFI-75 BULLET
3. PACKAGING:  
 A. QUANTITY: SINGLE PACK  
 B. MARKING: BAG TO BE MARKED "AMPHENOL, 227-1491, AND DATE CODE"
4. TO EXTRACT BULLET FROM AFI PLUG ASSEMBLY:  
 A. DEPRESS THUMB KNOB UNTIL BOTTOMED COMPLETELY, RESULTING IN FULLY OPEN COLLET.  
 B. INSERT AFI BULLET INTO COLLET UNTIL BOTTOMED  
 C. RELIEVE PRESSURE FROM THUMB KNOB AND PULL ON CENTER KNOB
5. TO INSERT BULLET INTO AFI PLUG ASSEMBLY:  
 A. DEPRESS THUMB KNOB UNTIL BOTTOMED COMPLETELY, RESULTING IN FULLY OPEN COLLET.  
 B. INSERT AFI BULLET INTO SLOTTED COLLET UNTIL BOTTOMED  
 C. RELIEVE PRESSURE FROM THUMB KNOB AND INSERT BULLET INTO AFI PLUG ASSEMBLY.  
 D. DEPRESS THUMB KNOB UNTIL BOTTOMED COMPLETELY TO RELEASE AFI BULLET FROM TOOL
6. TO REPLACE COLLET SUB-ASSEMBLY:  
 A. ALIGN FLATS ON COLLET SUB-ASSEMBLY WITH FLATS ON SLEEVE BODY AT POINT 2  
 B. LOOSEN COLLET SUB-ASSEMBLY WITH 7/32" WRENCH AT POINT 1 AND 3/16" WRENCH AT POINT 2  
 C. TIGHTEN SLOTTED COLLET SUB-ASSEMBLY TO 7 TO 10 IN-LBS WITH 7/32" WRENCH AT POINT 1 AND 3/16" WRENCH AT POINT 2

THIRD ANGLE PROJ.

REVISIONS

REV	DESCRIPTION	DATE	ECO	APPR
A	RELEASE TO MFG.	4/22/08	47007	MAH

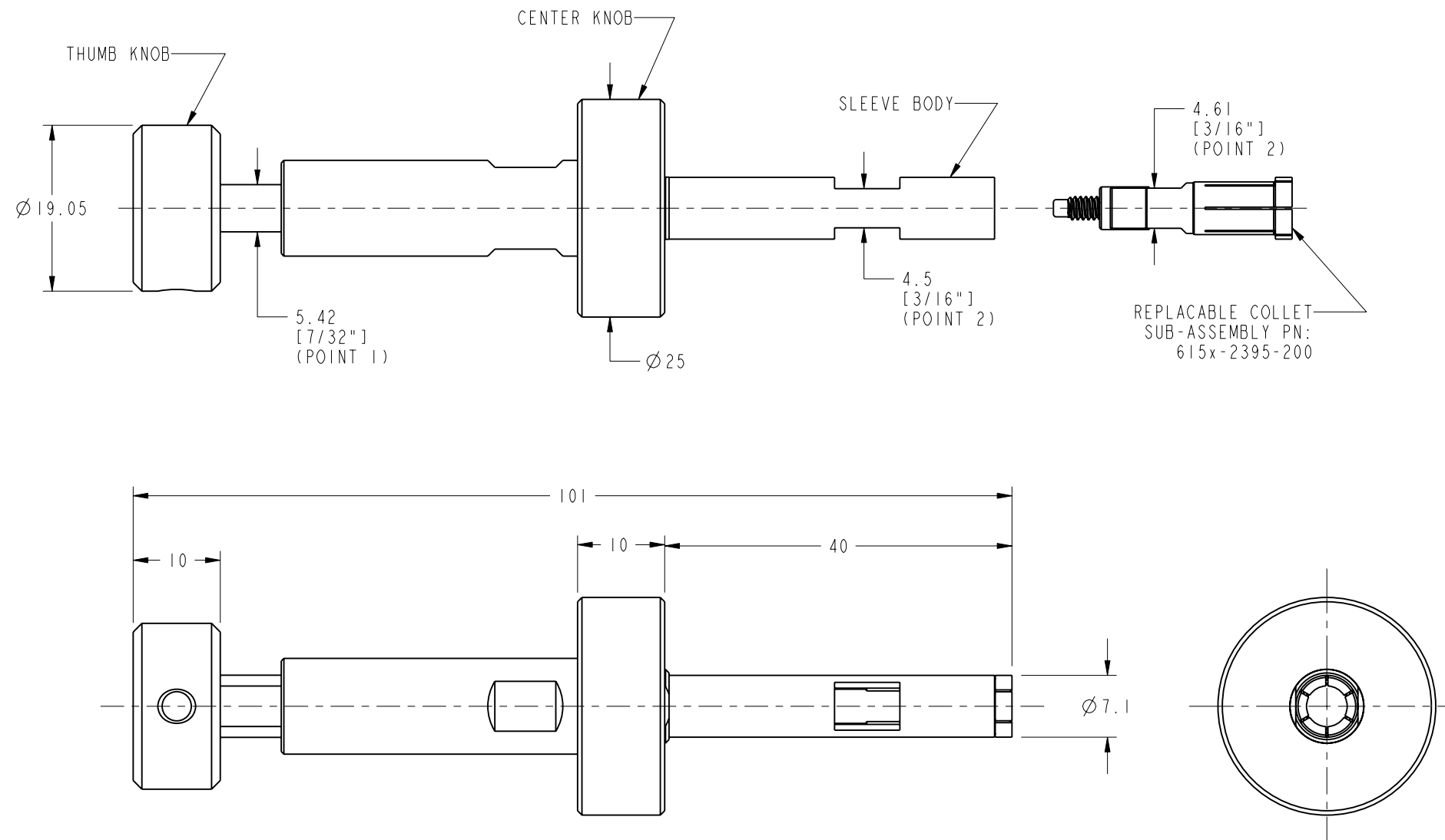
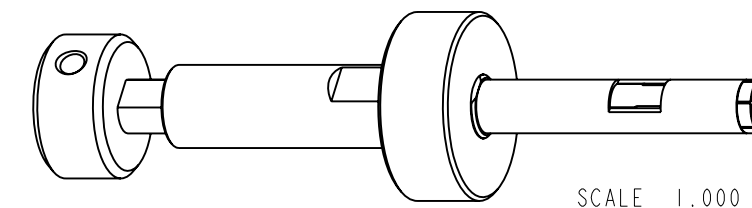

**CUSTOMER OUTLINE DRAWING**  
 ALL OTHER SHEETS ARE FOR INTERNAL USE ONLY

**METRIC DRAWING**

UNLESS OTHERWISE SPECIFIED, DIMENSIONS ARE METRIC AND TOLERANCES ARE: 1 PLACE DECIMAL ± 0.3MM (.012") 2 PLACE DECIMAL ± .10 MM (.004") ANGLES ± 1°	MATERIAL	DRAWN M. HOYACK	DATE 21-Jan-08	TITLE <b>AFI BULLET INSERTION AND EXTRACTION TOOL</b>		Amphenol RF Danbury CT USA, Tainan, Taiwan, Shenzhen, China www.amphenolrf.com	
	REFERENCE EAR #995.3 AND 615X-2395-100	ENGINEER M. HOYACK	DATE 21-Jan-08			DRAWING NO.	
NOTICE - These drawings, specifications, or other data (1) are, and remain the property of Amphenol corp. (2) must be returned upon request; and (3) are confidential and not to be disclosed to any person other than those to whom they are given by Amphenol Corp. the furnishing of these drawings, specifications, or other data by Amphenol Corp., or to any other person to anyone for any purpose is not to be regarded by implication or otherwise in any manner licensing, granting rights to permitting such holder or any other sperson to manufacture, use or sell any product, process or design, patented or otherwise, that may in any way be related to or disclosed by said drawings, specifications, or other data.	CONFIGURATION LEVEL: Prototype	APPROVED H. PARIKH	DATE 4/22/08	SCALE: 1.5:1.0	SHEET 2 OF 2	ITEM NO.	
	FINISH	Root Folder/AFI/227-1491	DWG SIZE B	CODE ID 74868	REV A	PART NO. 227-1491	

## X-ON Electronics

Largest Supplier of Electrical and Electronic Components

*Click to view similar products for [Extraction, Removal & Insertion Tools](#) category:*

*Click to view products by [Amphenol](#) manufacturer:*

Other Similar products are found below :

[M8196914-08](#) [768211-2](#) [809-131](#) [844751-2](#) [8-59558-2](#) [91018-1](#) [12014013](#) [12093647](#) [1-21048-0](#) [R282867020](#) [12093078](#) [12180559](#) [1-21048-6](#) [12121897](#) [DCF.91.405.5LT](#) [1322](#) [13549852](#) [15314260](#) [15313892](#) [15350698](#) [15350707](#) [15430130](#) [1643916-1](#) [1-679532-0](#) [1976593-3](#) [OUTEXT-0321](#) [2-1579008-3](#) [2-1579008-4](#) [229694-7](#) [231106-1](#) [241469](#) [91040-3](#) [91040-7](#) [965004-000](#) [965069-000](#) [1738219-1](#) [ET-JL05-16](#) [FG 0300 146 3000](#) [FIT-6](#) [210S048](#) [2-1579007-9](#) [231879-1](#) [CF-008025-000](#) [312138-3](#) [RJ11FODE](#) [356-162](#) [M8196914-10](#) [4-1579018-0](#) [483249-1](#) [5-1579007-2](#)