

| REV | DATE     | DESCRIPTION           |
|-----|----------|-----------------------|
| A   | 03/27/05 | UPDATE DRAWING FORMAT |

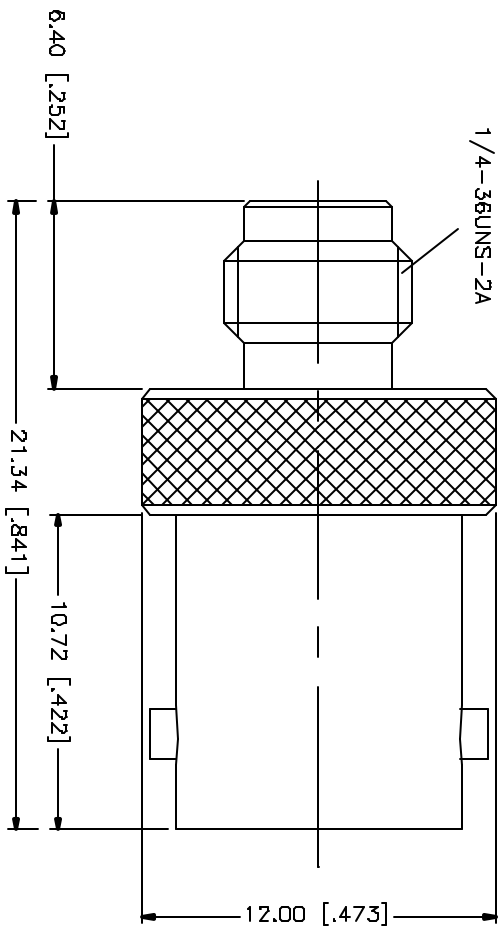

| NO.  | DESCRIPTION | MATERIAL     | FINISH  | QTY | DD NOT SCALE DRAWING           | APPROVALS | DATE | PART DESCRIPTION   | DWG. NO.   | REV. | SIZE | SQUL |
|--|-------------|--------------|---------|-----|--------------------------------|-----------|------|--|------------|------|------|------|
| 8  |             |              |         |     |                                |           |      | <b>Amphenol Connex</b><br>SMA FEMALE TO BNC FEMALE ADAPTER<br>242123 | 242123.DWG | A    | A    | NA   |
| 7  |             |              |         |     |                                |           |      |  |            |      |      |      |
| 6  |             |              |         |     |                                |           |      |  |            |      |      |      |
| 5  |             |              |         |     |                                |           |      |  |            |      |      |      |
| 4  |             |              |         |     |                                |           |      |  |            |      |      |      |
| 3  | CONTACT PIN | PHOS. BRONZE | GOLD    | 1   |                                |           |      |  |            |      |      |      |
| 2  | INSULATOR   | TEFLON       | NATURAL | 1   |                                |           |      |  |            |      |      |      |
| 1  | BODY        | BRASS        | NICKEL  | 1   |                                |           |      |  |            |      |      |      |
| UNLESS OTHERWISE SPECIFIED DIMENSIONS ARE IN MILLIMETERS. DIMENSIONS IN [ ] ARE IN INCHES AND FOR STARTER REFERENCE ONLY.<br>UNLESS OTHERWISE SPECIFIED TOLERANCES FOR MILLIMETERS ARE:<br>A - 0.5 - 8mm ± 0.20mm<br>B - 8mm - 14mm ± 0.40mm<br>C - 14mm - 30mm ± 0.50mm<br>UNLESS OTHERWISE SPECIFIED TOLERANCES FOR INCHES ARE:<br>.020 - .315 - ± 0.007"<br>.315 - 1.180 - ± 0.015"<br>1.180 - 4.724 - ± 0.025" |             |              |         |     | CADD FILE<br>C:/242/242123.DWG |           |      |  |            |      |      |      |

## X-ON Electronics

Largest Supplier of Electrical and Electronic Components

*Click to view similar products for [RF Adapters - Between Series category:](#)*

*Click to view products by [Amphenol manufacturer:](#)*

Other Similar products are found below :

[5945-9503-000](#) [MCX/F-SMA/M](#) [R192417010](#) [ADBJ20-E1-BJ379](#) [ADM2](#) [ADPL75-A1-PL75](#) [242191](#) [9317505](#) [AD130](#) [ADBJ20-E1-PL74](#)  
[ADBJ20-E2-BJ79](#) [ADBJ77-E1-UPL20](#) [ADRMF370](#) [242190](#) [242215](#) [242228](#) [R125680000W](#) [R192430000](#) [UAD95](#) [1057367-1](#) [8311505](#)  
[R114704000](#) [R451034500](#) [R451030500](#) [R451543000](#) [HDVDPN](#) [ADBJ20-K1-PL20](#) [R451570000](#) [R192419000](#) [R451034000](#) [J9](#) [J3WE-5](#)  
[R451032500](#) [242201RP](#) [17K132-K00S5](#) [03K719-S22S3](#) [AD-RSMAF-RTNC](#) [53K156-K00N5](#) [53K160-KIMN1](#) [29S132-K01N5](#) [53S156-](#)  
[K00N5](#) [02S119-S00E3](#) [28K132-K00N5](#) [02S109-K00S3](#) [27-8200TP](#) [242235](#) [ADBJ20-E1-BJ89](#) [ADP-SMAF-MMCXM](#) [000-2900](#) [321-102-](#)  
[003 \(SMA-50/2-H155/W1.03 AU\)](#)