

| REV. | DATE | DESCRIPTION |
|------|----------|-----------------|
| NC | 10/03/03 | INITIAL RELEASE |

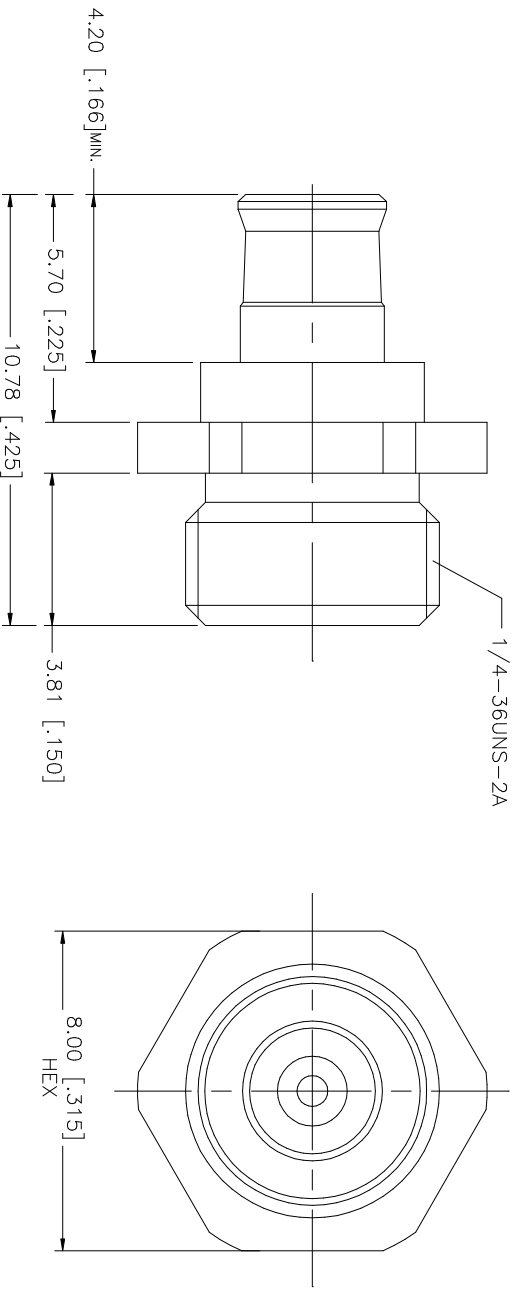

| NO. | DESCRIPTION | MATERIAL | FINISH | QTY | UNLESS OTHERWISE SPECIFIED, DIMENSIONS ARE IN MILLIMETERS. DIMENSIONS IN [] ARE IN INCHES AND FOR CUSTOMER REFERENCE ONLY. TOLERANCES FOR MILLIMETERS ARE: 0.3 - 8mm ± 0.20mm 8 - 30mm ± 0.40mm 30 - 120mm ± 0.50mm UNLESS OTHERWISE SPECIFIED, TOLERANCES FOR INCHES ARE: .020 - .315 = ± 0.007" .315 - 1.180 = ± 0.015" 1.180 - 4.724 = ± 0.020" | DO NOT SCALE DRAWING | CAD FILE | APPROVALS | DATE | DWG. NO. | REV. | SIZE | SCALE | | | | |
|---|----------------|--------------|--------------|-----|--|----------------------|----------|-----------|------|----------|------------|------|-------|------|---|-------|----|
| 8 | | | | | | | | | | | | | | | | | |
| 7 | | | | | | | | | | | | | | | | | |
| 6 | | | | | | | | | | | | | | | | | |
| 5 | | | | | | | | | | | | | | | | | |
| 4 | | | | | | | | | | | | | | | | | |
| 3 | CONTACT PIN | BER. COPPER | GOLD | 1 | | | | | | | | | | | | | |
| 2 | INSULATOR BODY | TEFLON BRASS | NATURAL GOLD | 1 | | | | | | | | | | | | | |
| 1 | | | | | | | | | | | | | | | | | |
| <p style="text-align: center;">Amphenol Connex</p> <p style="text-align: center;">PART DESCRIPTION MCX PLUG TO MCX JACK ADAPTER</p> <p style="text-align: center;">PART NO. 252186</p> | | | | | | | | | | DWG. NO. | 252186.DWG | REV. | NC | SIZE | A | SCALE | NA |

X-ON Electronics

Largest Supplier of Electrical and Electronic Components

Click to view similar products for [RF Adapters - In Series category:](#)

Click to view products by [Amphenol manufacturer:](#)

Other Similar products are found below :

[5916-1103-603](#) [5918-1103-000](#) [5919-1503-000](#) [651A505](#) [82-5552](#) [9030-9523-502](#) [A0407000](#) [R114703000W](#) [R125704000](#) [R125771001](#)
[R141710000W](#) [R141723161](#) [R141730000](#) [R143730700](#) [R143770000](#) [R161703000W](#) [R161730000](#) [R161753000W](#) [R161791530W](#)
[R201705000](#) [R222705200](#) [R222M40010W](#) [R223703180](#) [R316754000](#) [R405006000](#) [R443162000](#) [AD78TL](#) [HRM-513S](#) [1996352-2](#)
[2157155-1](#) [252169-75](#) [AD158](#) [2101130-1](#) [252186](#) [R114704000W](#) [R114720000W](#) [R125705001](#) [R125705701](#) [R125771000](#) [R125771001W](#)
[R125791501W](#) [R127704001](#) [R127.870.001](#) [R127872001](#) [R141717000](#) [R142710000](#) [R142723000](#) [R143703000](#) [R143704000](#) [R143705700](#)