

NOTES:

1. MATERIALS AND FINISHES:
 MCX STR CRIMP PLUG - BeCu, GOLD PLATING
 CABLE - RG 316
2. ELECTRICAL:
 A. IMPEDANCE: 50 OHM
3. PACKAGING:
 A. QUANTITY: SINGLE PACK
 B. MARKING: BAG TO BE MARKED
 "AMPHENOL RF, 255101-01-XX.XX AND DATE CODE".

THIRD ANGLE PROJ.

REVISIONS

REV	DESCRIPTION	DATE	ECO	APPR
A	RELEASE TO MFG.	--	--	--
B	FORMAT UPDATED, 18.00", 48.00" & METRIC LENGTHS ADDED	26-Jul-16	1401	NR
C	METRIC PART NUMBER UPDATED	30-Sep-16	02021	AG

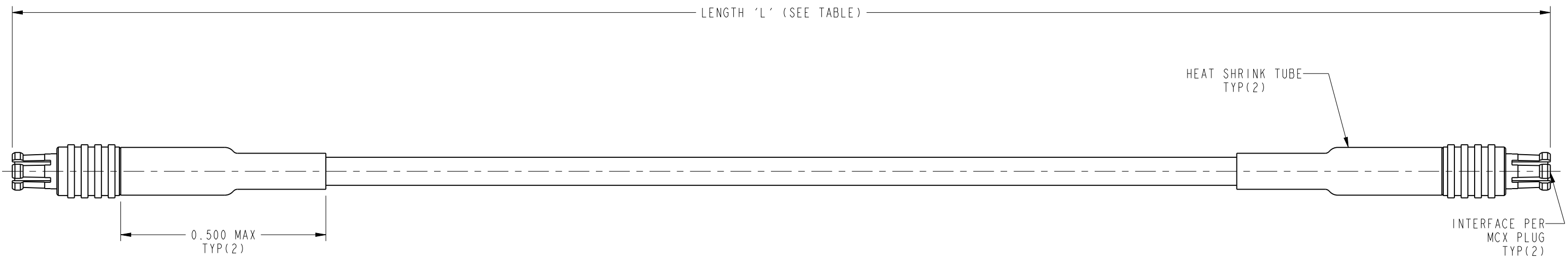
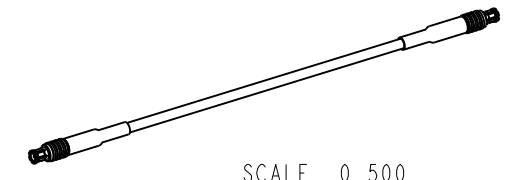

LENGTH TABLE		
PART NUMBER (IMPERIAL)	PART NUMBER (METRIC)	LENGTH 'L' IN INCHES [METERS]
255101-01-06.00	-	6.00 [0.152]
-	255101-01-M0.25	9.84 [0.250]
255101-01-12.00	-	12.00 [0.305]
255101-01-18.00	-	18.00 [0.457]
-	255101-01-M0.50	19.69 [0.500]
255101-01-24.00	-	24.00 [0.610]
-	255101-01-M0.75	29.53 [0.750]
255101-01-36.00	-	36.00 [0.914]
-	255101-01-M1.00	39.37 [1.000]
255101-01-48.00	-	48.00 [1.219]
-	255101-01-M2.00	78.74 [2.000]
-	255101-01-M4.00	157.48 [4.000]

TOLERANCE TABLE	
LENGTH IN INCHES/FT [METERS]	TOLERANCE
0" - 23.90" [0 - 0.607]	±0.25" [0.006]
24.00" - 59.00" [0.610 - 1.499]	±0.50" [0.013]
5.0' - 24.9' [1.524 - 7.617]	±2.5%
25.0' & UP [7.620 & UP]	±5.0%

DESIGN REQUIREMENTS:

- FREQUENCY : ____ TO ____ GHz CONTINUITY
 VSWR ____ : 1 MAX HI-POT : 750 VRMS
 INS. LOSS : ____ dB MAX OTHER

CUSTOMER OUTLINE DRAWING
 ALL OTHER SHEETS ARE FOR INTERNAL USE ONLY

UNLESS OTHERWISE SPECIFIED, DIMENSIONS ARE IN INCHES AND TOLERANCES ARE: 2 PLACE DECIMAL 3 PLACE DECIMAL ANGLES ±.015 (0.381 mm) ±.005 (0.127 mm) ± 1°	MATERIAL	DRAWN	DATE	TITLE MCX STR CRIMP PLUG TO MCX STR CRIMP PLUG USING RG 316 CABLE, VARIOUS LENGTH SCALE: 2.7:1.0 SHEET 2 OF 2	Amphenol RF www.amphenolrf.com
	SEE NOTES	RAJAGOPAL N	18-May-16		
NOTICE - These drawings, specifications, or other data (1) are, and remain the property of Amphenol corp. (2) must be returned upon request; and (3) are confidential and not to be disclosed to any person other than those to whom they are given by Amphenol Corp. the furnishing of these drawings, specifications, or other data by Amphenol Corp., or to any other person to anyone for any purpose is not to be regarded by implication or otherwise in any manner licensing, granting rights to permitting such holder or any other person to manufacture, use or sell any product, process or design, patented or otherwise, that may in any way be related to or disclosed by said drawings, specifications, or other data.	REFERENCE	ENGINEER	DATE	DRAWING NO. 255101-01-XX-XX ITEM NO. 255101-01-XX-XX	
	EAR # 7251	CLEMENT	19-May-10		
	CONFIGURATION LEVEL: In Work	APPROVED	DATE	DWG SIZE B	REV C
FINISH	K.CAPOZZI	30-Sep-16	PART NO. 255101-01-XX-XX		

X-ON Electronics

Largest Supplier of Electrical and Electronic Components

Click to view similar products for [RF Cable Assemblies](#) category:

Click to view products by [Amphenol](#) manufacturer:

Other Similar products are found below :

[73-6352-10](#) [73-6353-3](#) [73-6364-6](#) [R285001001](#) [R288940004](#) [R288940005](#) [145111-05-12.00](#) [1661-C-24](#) [1801171170914KE](#) [24P104C24J1-012](#) [24P104C24P1-006](#) [24P104C24P1-018](#) [24P204C24J1-003](#) [172-2150-EX](#) [1800920920914PJ](#) [FCB-3030-ALT](#) [21117-046](#) [21117-050](#) [PCX-24-50](#) [24P103C24P2-003](#) [25P203C25P2-003](#) [PTWY-24-78](#) [R284008001](#) [R285001021](#) [R285426000](#) [R288940003](#) [R288940008](#) [RF179-74BJ3-77RP1-0305](#) [4814-BB-24](#) [5260-72](#) [JT2N1-CL1-1F](#) [DLP-COAX1](#) [4814-K-48](#) [115101-09-06.00](#) [CCNTN2-MM-LL335-26](#) [73-6351-25](#) [73-6352-3](#) [73-6353-25](#) [1800920920610PJ](#) [GD0BQ0BQ024.0](#) [1-3636-600-5210](#) [TL8A-11SMA-11SMA-01500-51](#) [R284C0351060](#) [R288940009](#) [R284C0351028](#) [R288940002](#) [9702-1SL-1](#) [PT82NSMA](#) [73-6353-10](#) [R285020301W](#)