

ZONE	REV	SCR NUMBER	DESCRIPTION	BY	DATE	APPROVED
ALL	A	DMAN-8W JP4Y.VER01	NEW RELEASE	D.MALOON	07/31/12	D.McNAMARA
	B	CSAS-962LNK.VER01	UPDATED NOTE 4	HCL-WS	03/22/13	D.McNAMARA

DRW NO.	SH	REV
C-380-3316-500	1	B

TABLE 1	
PART NUMBER ^①	DESCRIPTION
380-3316-X00	RECEPTACLE ASSY. 4 PAIR, 24.5 MM HIGH, 15 WAFERS, 100 OHMS W/LOSSY
380-3416-X00	RECEPTACLE ASSY. 4 PAIR, 24.5 MM HIGH, 15 WAFERS, 85 OHMS W/LOSSY
380-3516-X00	RECEPTACLE ASSY. 4 PAIR, 24.5 MM HIGH, 15 WAFERS, 100 OHMS NO LOSSY
380-3616-X00	RECEPTACLE ASSY. 4 PAIR, 24.5 MM HIGH, 15 WAFERS, 85 OHMS NO LOSSY

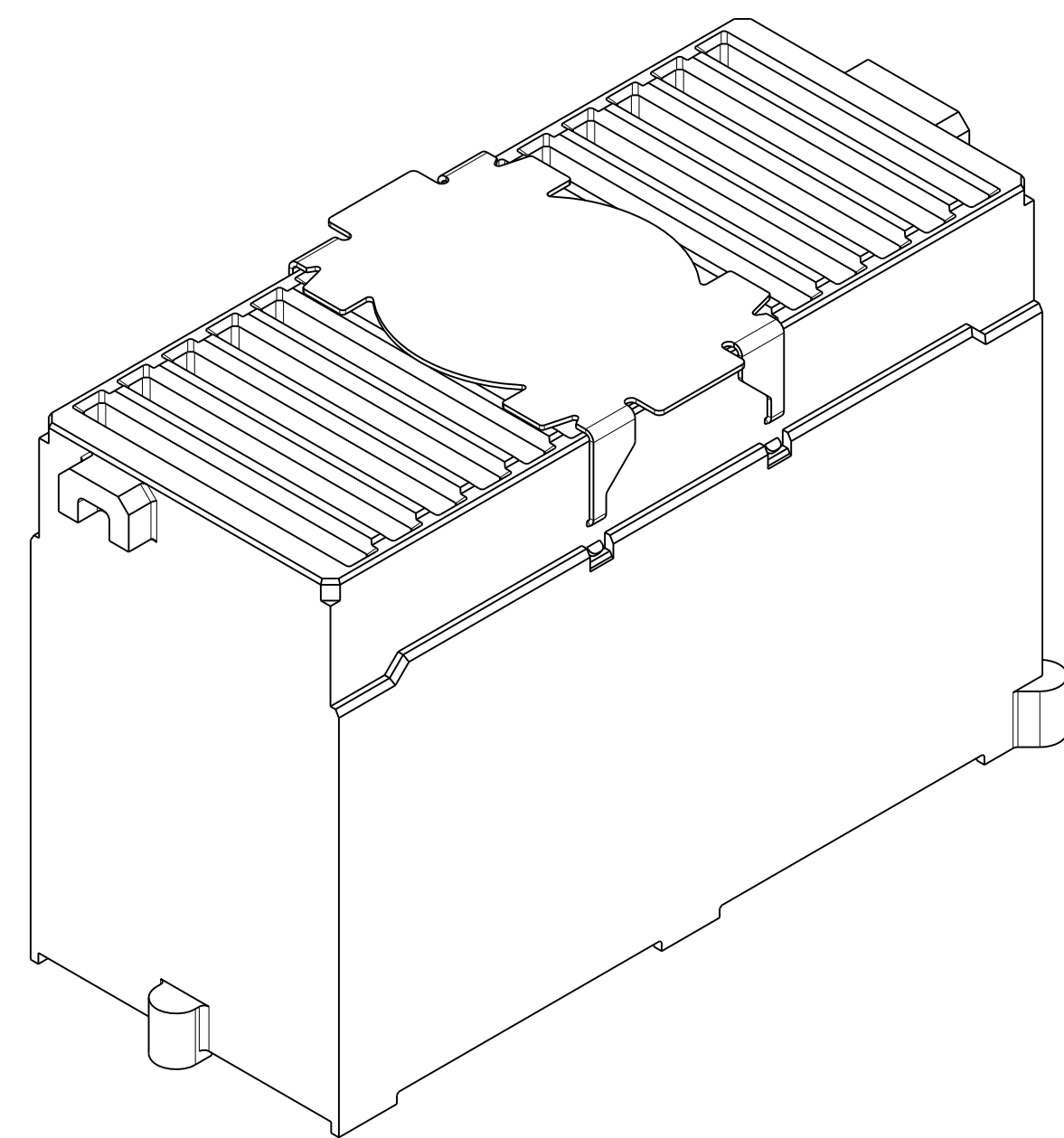

ISOMETRIC VIEW
SCALE 4/1

NOTES:

- ASSEMBLY PART NUMBER VARIES WITH PLATING OPTION AS FOLLOWS:
FOR NI SULFAMATE UNDERPLATE, 8TH DIGIT OF P/N IS 2.
FOR NANO NI UNDERPLATE, 8TH DIGIT OF P/N IS 4.
- MAT'L:
HOUSING/WAFERS - LCP
VACUUM CAP - SST
CONTACTS - HIGH PERFORMANCE COPPER ALLOY, PER MTS-506.
- 0.71 DIA SOLDER SPHERES WILL NOT BE PERFECTLY SPHERICAL AFTER REFLOW ATTACHMENT.
- OPTIONAL HOLES FOR VISUAL INSPECTION OF CONNECTOR ALIGNMENT. THESE ARE NOT REQUIRED
- SOLDER BALL PROTRUSION BELOW HOUSING.
- SEE TECHNICAL BULLETIN TB-2241 FOR DETAILED SMT PROCESSING AND PCB FOOT PRINT RECOMMENDATIONS.
- MAXIMUM CO-PLANARITY OF THE BALL FIELD.
- MAXIMUM RADIAL TRUE POSITION OF ANY SOLDER BALL IN RELATION TO AN IDEAL BEST FIT GRID.
- TOLERANCES DO NOT APPLY TO REFERENCE DIMENSIONS SHOWN IN "Ø" OR BASIC DIMENSIONS SHOWN IN "□".
- REFER TO FILE 380-3X16-XX0.STP FOR SIMPLIFIED 3D MODEL OF ASSEMBLY.

TOLERANCES	DESIGN 09/10/10 D.MALOON
0.0 ±0.25	DRAWN 06/24/11 D.MALOON
0.00 ±0.13	CHK 07/31/12 D.McNAMARA
0.000 ± -	APVD 07/31/12 D.McNAMARA
ANGLES ± 3°	

Amphenol TCS A Division of Amphenol Corporation 200 Innovative Way, Nashua, NH 03082 603.879.3000	
TITLE	RECEPTACLE ASSEMBLY, 15 WAFERS InfinX 4 PAIR, 24.5 MM HIGH
PART NO.	SEE TABLE 1
REV	N/A

UNLESS OTHERWISE SPECIFIED DIMENSIONS ARE IN MM. DECIMAL MARKER IS A PERIOD.
INTERPRET PER ASME Y14.5M
CODE IDENT 31413

CUSTOMER USE DRAWING	
DRAWING NO.	C-380-3316-500
PART	Q1155-RCP-ASSY-4X24_5X15-VC DRAWING C-380-3316-500
SIZE	D
SCALE	4/1
SHEET	1 OF 4

DRW NO. C-380-3316-500 SH 1 REV B

8

7

6

5

4

3

DRW NO. C-380-3316-500 SH 2 REV B

ZONE	REV	SCR NUMBER	DESCRIPTION	BY	DATE	APPROVED
			SEE SHEET 1			

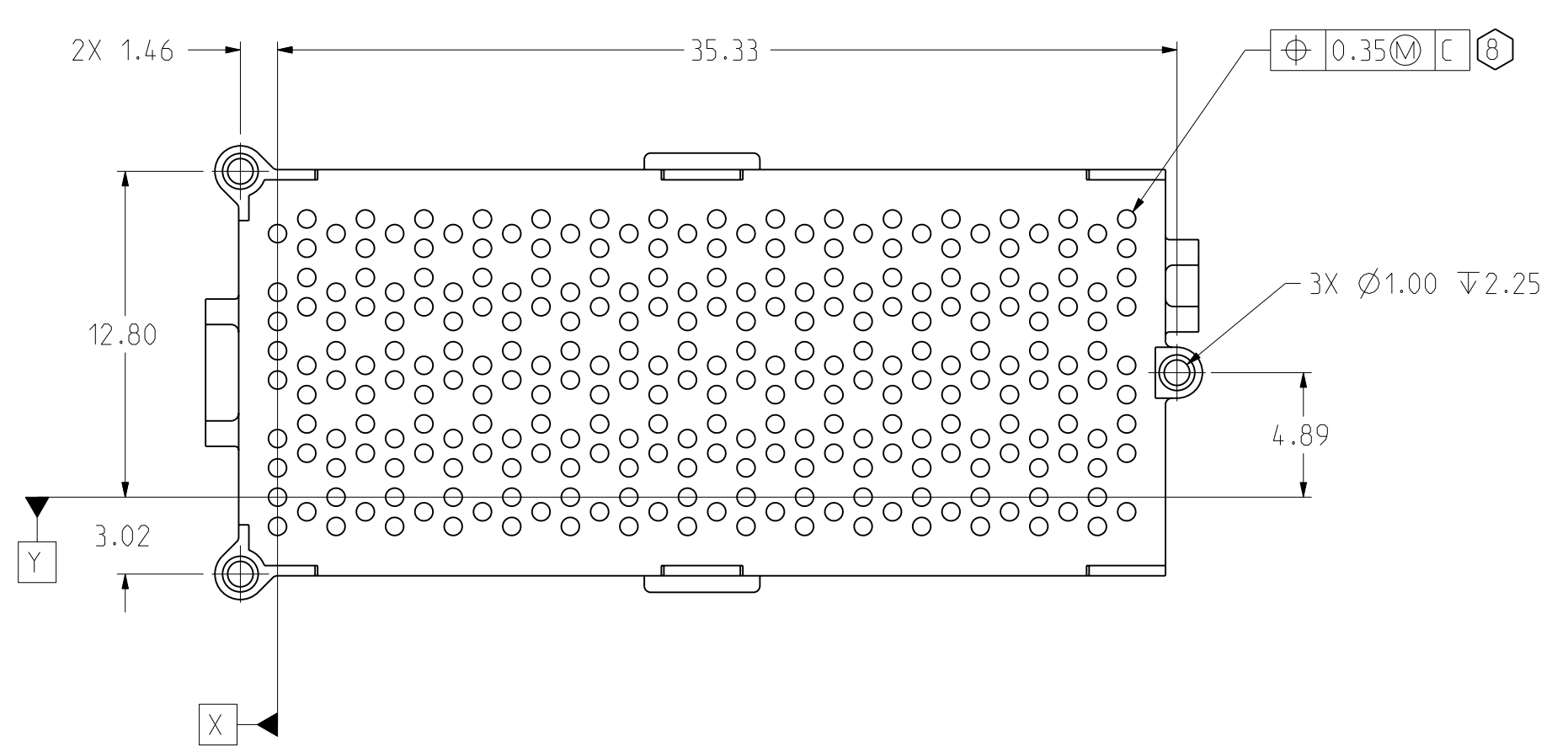
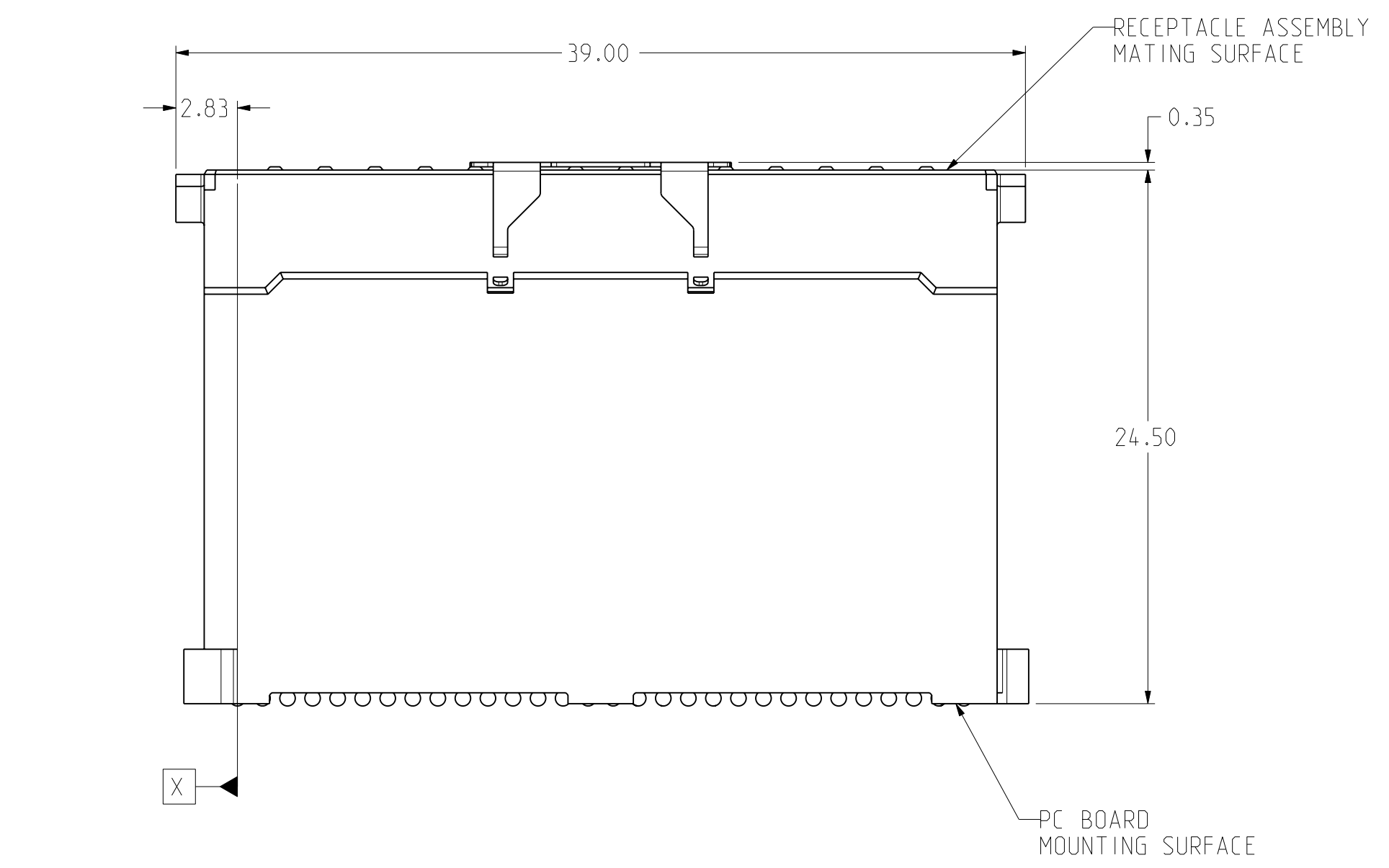
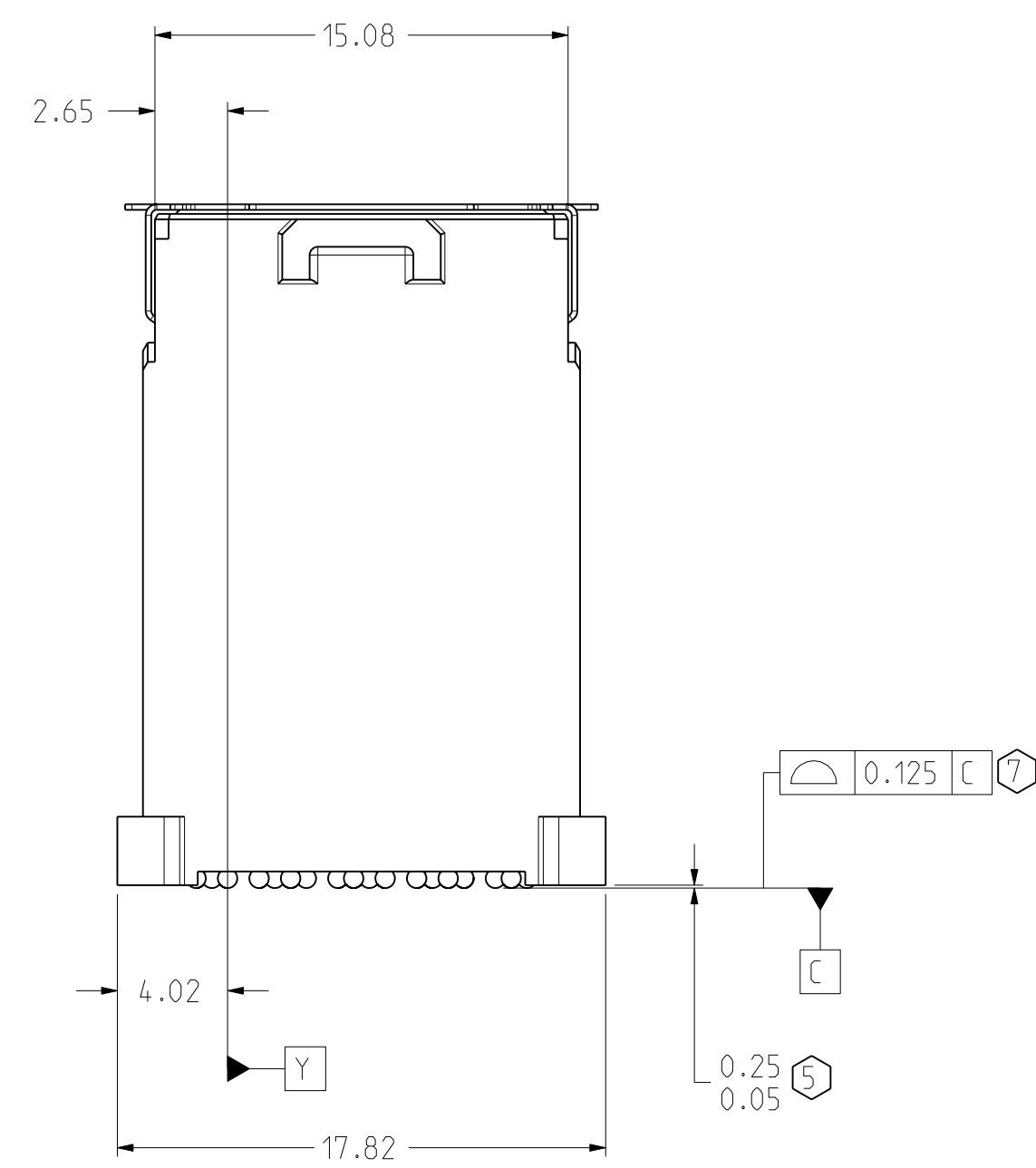
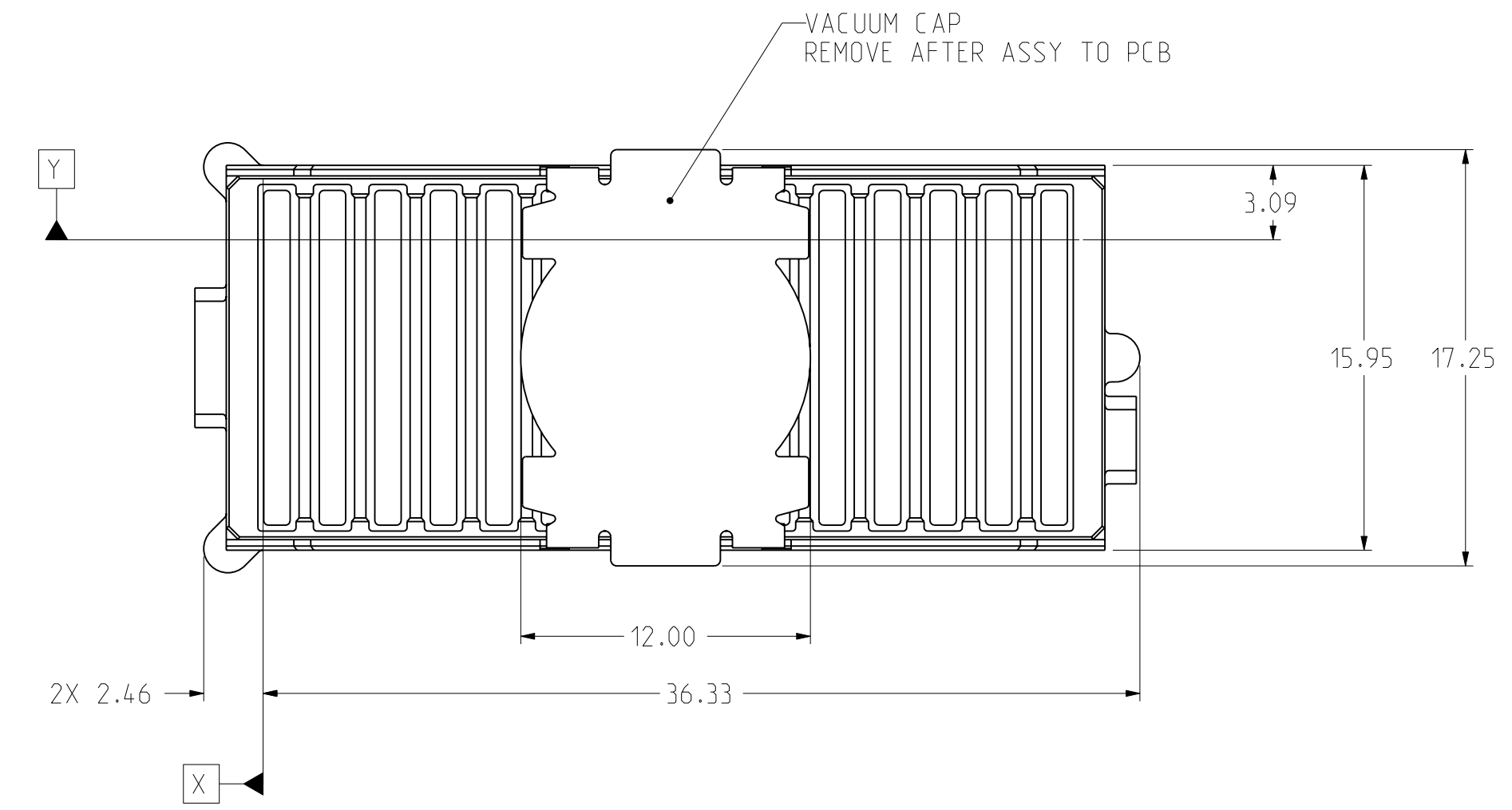

TOLERANCES		DESIGN 09/10/10 D.MALOON	Amphenol TCS A Division of Amphenol Corporation 200 Innovative Way, Nashua, NH 03082 603.879.3000 TITLE RECEPTACLE ASSEMBLY, 15 WAFERS InfinX 4 PAIR, 24.5 MM HIGH PART NO. SEE TABLE 1 DRAWING NO. C-380-3316-500 PART Q1155-RCP-ASSY-4X24_5X15-VC DRAWING C-380-3316-500 SIZE D SCALE 4/1 SHEET 2 OF 4
0.0	±0.25	DRAWN 06/24/11 D.MALOON	
0.00	±0.13	CHK 07/31/12 D.McNAMARA	
0.000	± -	APVD 07/31/12 D.McNAMARA	
ANGLES ± 3°		UNLESS OTHERWISE SPECIFIED DIMENSIONS ARE IN MM. DECIMAL MARKER IS A PERIOD.	

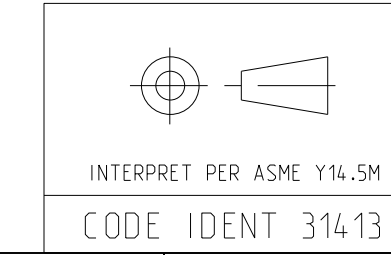

DRW NO. C-380-3316-500

SH 2 REV B

8

7

6

5

4

3

2

1

8

7

6

5

4

3

DRW NO. C-380-3316-500

SH 3 REV B

ZONE	REV	SCR NUMBER	DESCRIPTION	BY	DATE	APPROVED
			SEE SHEET 1			

D

C

B

A

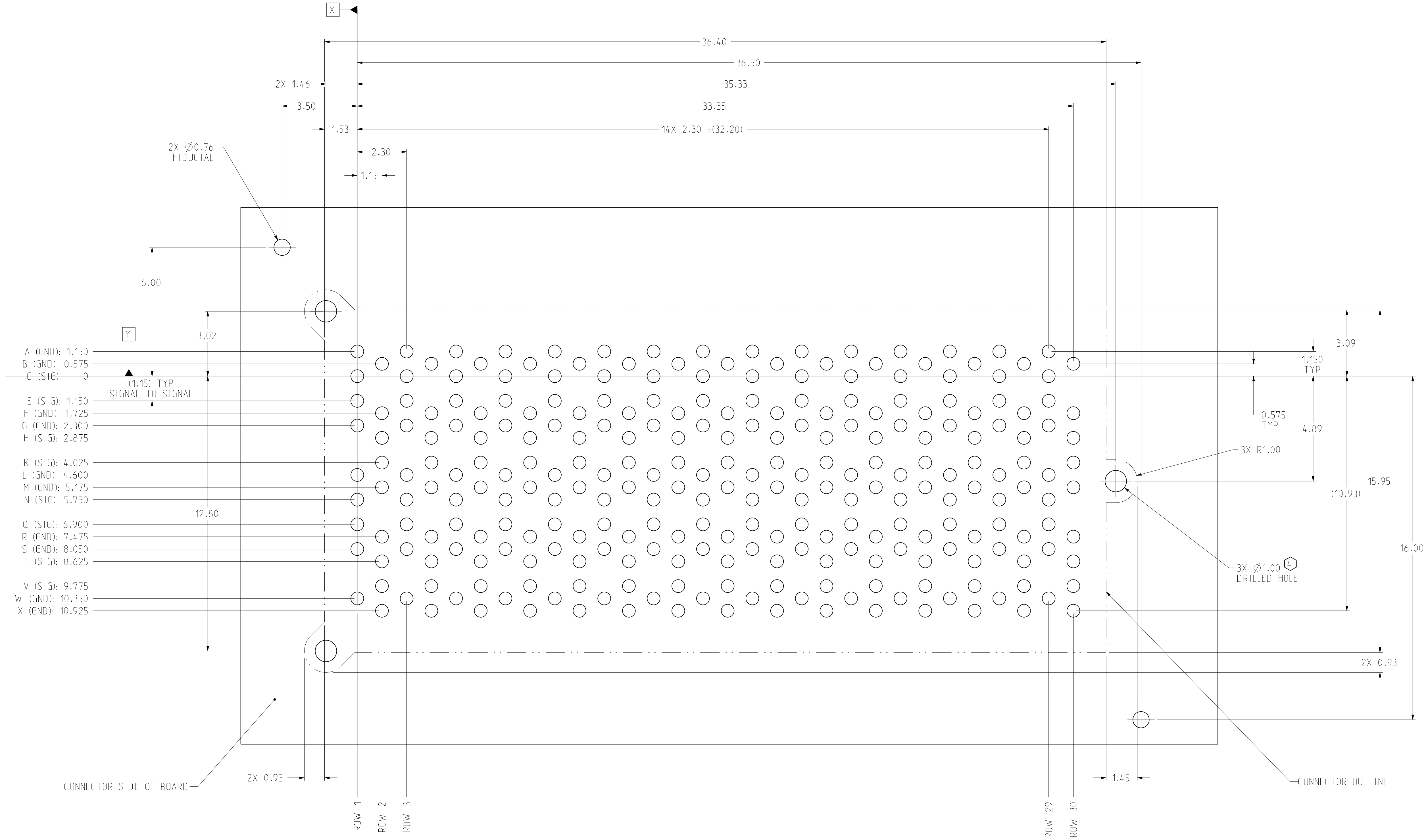

- A (GND): 1.150
- B (GND): 0.575
- C (SIG): 0
- E (SIG): 1.150
- F (GND): 1.725
- G (GND): 2.300
- H (SIG): 2.875
- K (SIG): 4.025
- L (GND): 4.600
- M (GND): 5.175
- N (SIG): 5.750
- Q (SIG): 6.900
- R (GND): 7.475
- S (GND): 8.050
- T (SIG): 8.625
- V (SIG): 9.775
- W (GND): 10.350
- X (GND): 10.925

6 PAD LAYOUT
SCALE 10/1

TOLERANCES	DESIGN	09/10/10
0.0	±0.25	D.MALOON
0.00	±0.13	D.MALOON
0.000	±	D.McNAMARA
ANGLES	± 3°	D.McNAMARA

Amphenol TCS
A Division of Amphenol Corporation
200 Innovative Way, Nashua, NH 03082 603.879.3000

TITLE
RECEPTACLE ASSEMBLY, 15 WAFERS
InfinX 4 PAIR, 24.5 MM HIGH

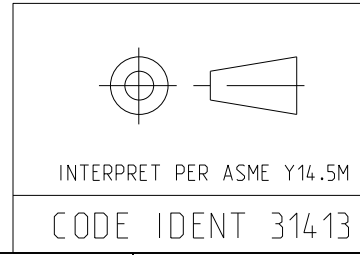

UNLESS OTHERWISE SPECIFIED DIMENSIONS ARE IN MM. DECIMAL MARKER IS A PERIOD		PART NO.	SEE TABLE 1	REV	N/A
DRAWING NO.		C-380-3316-500		REV	B
PART		Q1155-RCP-ASSY-4X24_5X15-VC		DATE	1.13
DRAWING		C-380-3316-500		SCALE	3/1
SIZE		D		SHEET	3 OF 4

CUSTOMER USE
DRAWING

DRW NO. C-380-3316-500

SH 3

REV B

8

7

6

5

4

3

2

1

DRW NO.	C-380-3316-500	SH	4	REV	B	
ZONE	REV	SCR NUMBER	DESCRIPTION	BY	DATE	APPROVED
			SEE SHEET 1			

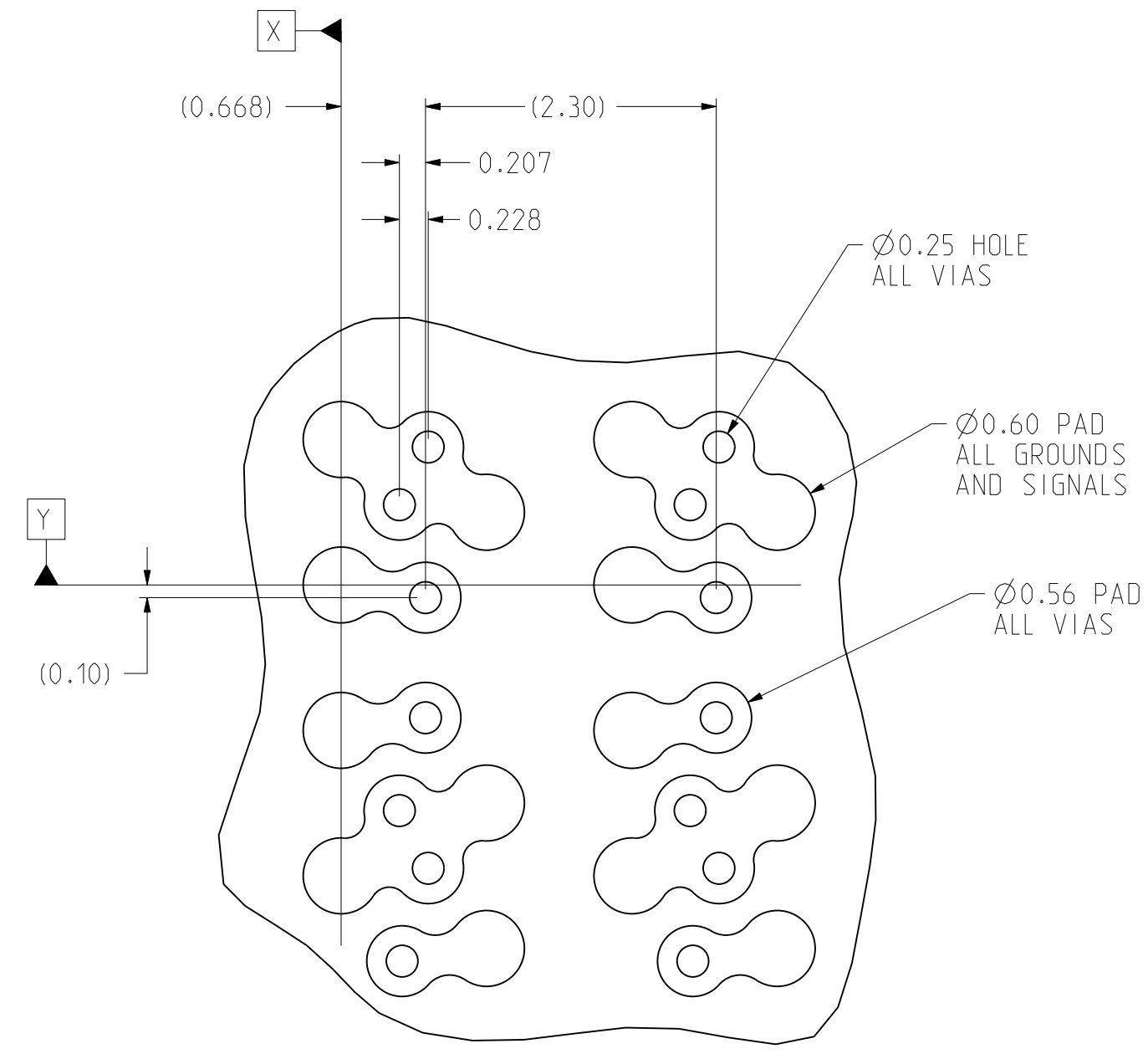

DETAIL A
SCALE 20/1

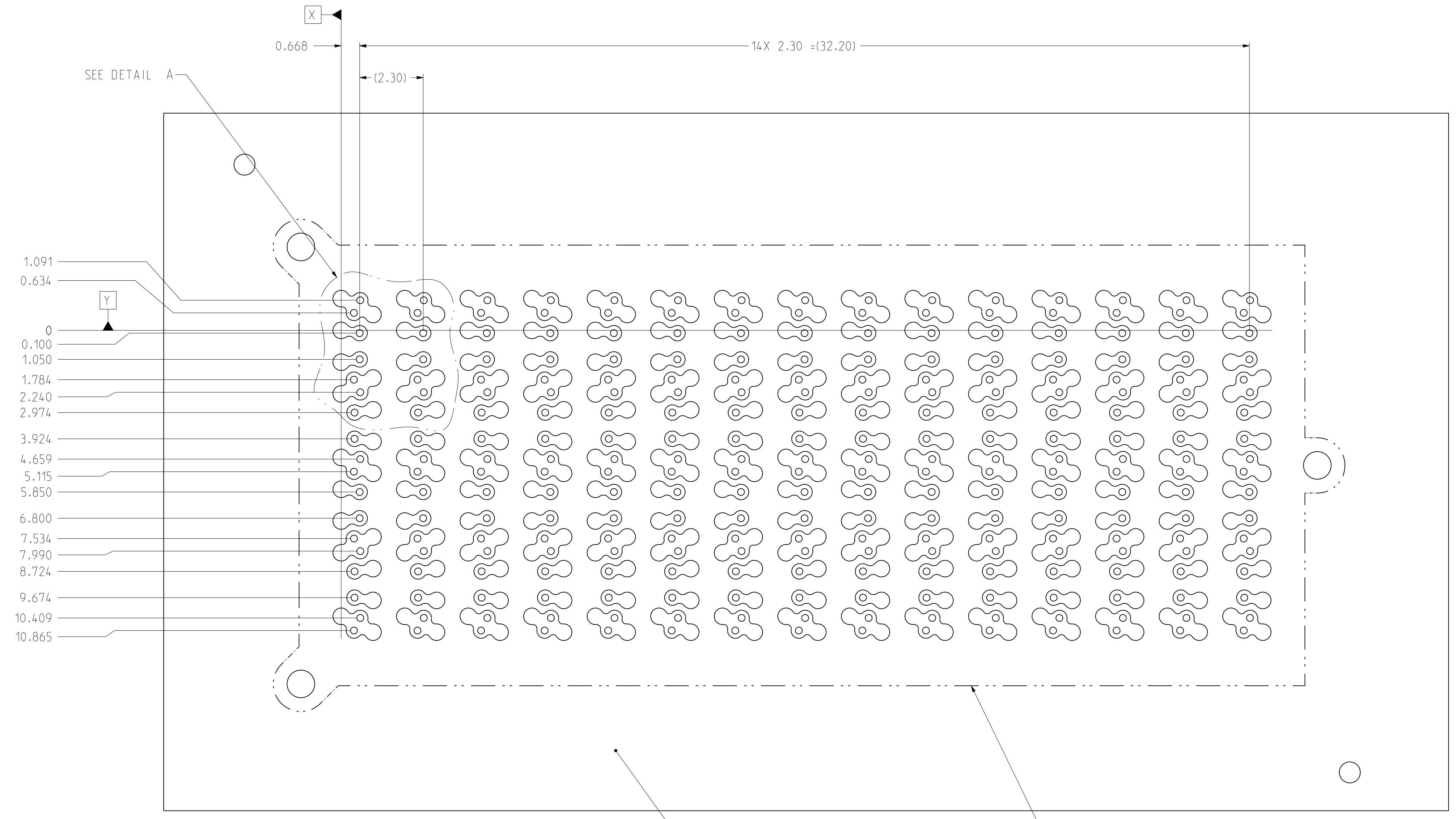

VIA LAYOUT
SCALE 10/1

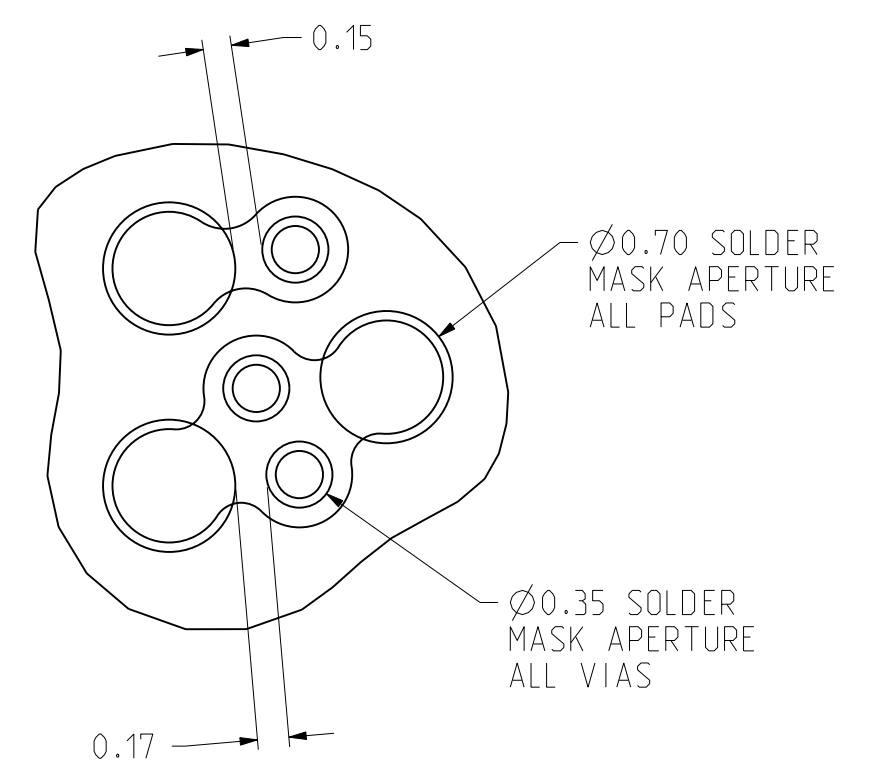

SOLDER MASK DETAIL
SCALE 25/1

TOLERANCES		DESIGN 09/10/10 D.MALOON	Amphenol TCS A Division of Amphenol Corporation 200 Innovative Way, Nashua, NH 03082 603.879.3000		
0.0	±0.25	DRAWN 06/24/11 D.MALOON			
0.00	±0.13	CHK 07/25/12 D.McNAMARA			
0.000	± -	APVD 07/25/12 D.McNAMARA			
ANGLES	± 3°		TITLE RECEPTACLE ASSEMBLY, 15 WAFERS InfinX 4 PAIR, 24.5 MM HIGH PART NO. SEE TABLE 1 REV N/A		
UNLESS OTHERWISE SPECIFIED DIMENSIONS ARE IN MM. DECIMAL MARKER IS A PERIOD			DRAWING NO. C-380-3316-500 REV B PART Q1155-RCP-ASSY-4X24_5X15-VC DRAWING C-380-3316-500 1.13 B.0		
INTERPRET PER ASME Y14.5M CODE IDENT 31413		CUSTOMER USE DRAWING			
SIZE	D	SCALE	3/1	SHEET	4 OF 4

C-380-3316-500

SH 4 REV B

X-ON Electronics

Largest Supplier of Electrical and Electronic Components

Click to view similar products for [Board to Board & Mezzanine Connectors](#) category:

Click to view products by [Amphenol](#) manufacturer:

Other Similar products are found below :

[589158040000018](#) [MDF7C-18P-2.54DSA\(55\)](#) [FCN-230C068-11](#) [FCN-268F012-G/BD](#) [FCN-268F036-G/BD](#) [FCN-268M012-G/0D](#) [FCN-268M024-G/1D](#) [FCN-723J004/1](#) [MIS-048-01-F-D-DP-K](#) [832-10-034-10-001000](#) [FX4C-80S-1.27DSA](#) [FCN-214Q030-G/0](#) [FCN-234P048-G/0](#) [FCN-235D050-G/C](#) [210-93-314-41-105000](#) [2-22603-0](#) [MDF7-40DP-2.54DSA\(55\)](#) [AXG720047](#) [MIT-114-03-F-D-K](#) [55323-1519](#) [DF33-2P-3.3DSA\(24\)](#) [YFT-20-05-H-03-SB-K](#) [503308-3040](#) [026-6203-PDB](#) [027-6203-PDB](#) [069159702701000](#) [10123981-102LF](#) [101A10019X](#) [55650-0588-C](#) [68682-310LF](#) [68684-306](#) [75140-7012](#) [87471-650](#) [YTW-30-07-H-Q-410-140](#) [FCN-268F024-G0D](#) [10124054-515LF](#) [68685-603](#) [8-1616154-3](#) [MIS-019-01-F-D](#) [FCN-268M024-G/3D](#) [FCN-268M036-G/BD](#) [20021832-06016C1LF](#) [KX15-20KLDL-E1000E](#) [AXE810124](#) [FCN-214J100-G/0](#) [FCN-230C068-E/S](#) [AXE812124](#) [AXE816124](#) [AXE720127](#) [354184](#)