

PRODUCT NUMBER  
57102-XXX-XXXXXLF

- ROHS COMPATIBLE SEE NOTE 7
- POLARIZATION, SEE NOTE 6
- PACKAGING, SEE NOTE 5
- NB OF POSITIONS PER ROW: 02 TO 25 POS
- S = 0.38µm GOLD/GXT ON CONTACT AREA  
2µm MIN MATTE TIN ON TAIL
- G = 0.76µm GOLD/GXT ON CONTACT AREA  
2µm MIN MATTE TIN ON TAIL
- F = GOLD FLASH ON CONTACT AREA  
2µm MIN MATTE TIN ON TAIL

1.27µm MIN NICKEL UNDERPLATING

PIN	POST	TAIL	OAL
02	2.00	2.50	6.00
04	2.00	3.00	6.50
06	4.00	2.50	8.00
08	4.00	3.00	8.50
10	6.00	3.00	10.50
12	5.71	4.37	11.58

NOTES:

1. MATERIAL HOUSING: HIGH TEMP. THERMOPLASTIC  
UL 94V-0, COLOR BLACK
2. MATERIAL TERMINAL: COPPER ALLOY

3. TO DETERMINE DIMENSIONS:  
N = NUMBER OF POSITIONS PER ROW

4. 7N MIN. PIN RETENTION IN EITHER DIRECTION.

5. PACKAGING:

= STANDARD PACKAGING IN POLYBAGS

- = PACKAGING POLYBAGS WHEN POLARIZATION FEATURE APPLICABLE

U = TUBE AVAILABLE FROM 03 TO 25 POS PER ROW

6. FOR POLARIZATION, SPECIFIED PIN  
EXAMPLE: 03 = OMIT PIN POSITION 3, SEE TOP VIEW  
OMIT FROM PRODUCT NUMBER IF THIS FEATURE IS NOT APPLICABLE

7. ROHS COMPATIBLE PRODUCT SPECIFICATIONS

a - PLATING:

- "LF" MEANS THE PRODUCT IS LEAD-FREE,  
2µm MINIMUM MATTE TIN OVER 1.27µm

MINIMUM NICKEL UNDERPLATE.

b - MANUFACTURING PROCESS COMPATIBILITY

- THE HOUSING WILL WITHSTAND EXPOSURE TO  
260°C ±5°C SOLDER BATH TEMPERATURE FOR  
5 SECONDS IN A WAVE SOLDER APPLICATION  
WITH A 1.6mm MIN THICK CIRCUIT BOARD.

- COMPATIBLE TO REFLOW PROCESS 260°C MAX

FOR 30 SECONDS

c - LABELLING:

- MEETS PACKAGING SPECS AS PER GS-14-920

d - LEGAL STATEMENT: SEE GS-47-0004

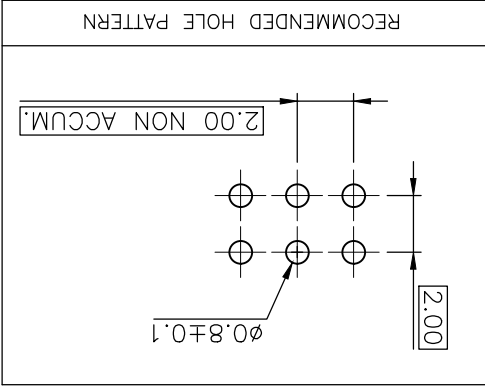

TOP VIEW

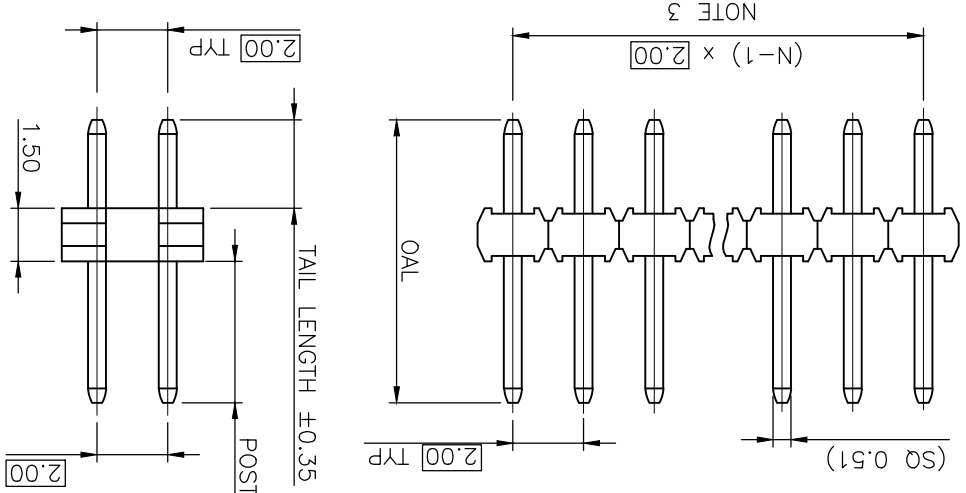
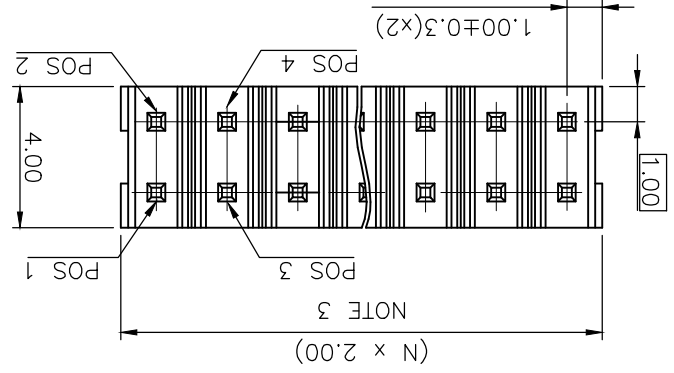

mat'l. code	surface	tolerance	projection	product family
	ISO 1302	ISO 406 ISO 101	101	MINITEK

trf	ecn no	dr	date	tolerances unless otherwise specified
L	F12-0062	LMU	12.05.25	.X ±0.3
M	B-19190	LMU	14.10.24	linear .XX ±0.13
N	B-19797	AMA	14.12.16	.XXX ±0.05
P	B-19988	LMU	15.01.13	L.MULIN 04.05.06
J	F08-0145	ELA	17.04.08	chr
K	F11-0026	JCO	11.05.12	appp J.M.C 04.11.25

sheet	revision	index	sheet

type	title	scale	product family
CUSTOMER Drawing	UNSH HEADER	1:1	MINITEK

dwg no	size	product family
57102	1 of 1	MINITEK

## X-ON Electronics

Largest Supplier of Electrical and Electronic Components

*Click to view similar products for [Headers & Wire Housings](#) category:*

*Click to view products by [Amphenol](#) manufacturer:*

Other Similar products are found below :

[95000-104TRLF](#) [10135584-644402LF](#) [DF62W-EP2022PCA](#) [95000-106TRLF](#) [DF62W-2022SCA](#) [DF62W-EP2022PC](#) [2203348](#) [DF62W-2022SC](#) [1084018](#) [1029039](#) [1084017](#) [802-10-012-10-002000](#) [1112640](#) [1112639](#) [891-007-9SS-BST1T](#) [000-34000](#) [0008550134](#) [0009482033](#) [0009507031](#) [57102-F02-18ULF](#) [57102-S06-03LF](#) [57202-S52-04LF](#) [PCN6-15S-2.5E](#) [0039019024](#) [58102-G61-06LF](#) [582553-1](#) [0009485154](#) [0009508121](#) [009176003701906](#) [0022285053](#) [0050291907](#) [018731A](#) [LY20-4P-DT1-P1E-BR](#) [02.125.8002.8](#) [60101931](#) [60598-1 \(Cut Strip\)](#) [M1625-3R/100](#) [61062-3](#) [61082-181009](#) [CSU011177004](#) [636-1427](#) [638009-1](#) [641938-9](#) [641991-4](#) [644168-1](#) [644827-2](#) [647662-1](#) [65039-019ELF](#) [65692-001LF](#) [65781-018](#)