

PRODUCT NUMBER
65166-001(LF)

WHEN NEEDED, SUFFIX LETTER "LF"
INDICATES THE PRODUCT IS RoHS
COMPLIANT, SEE NOTE 2

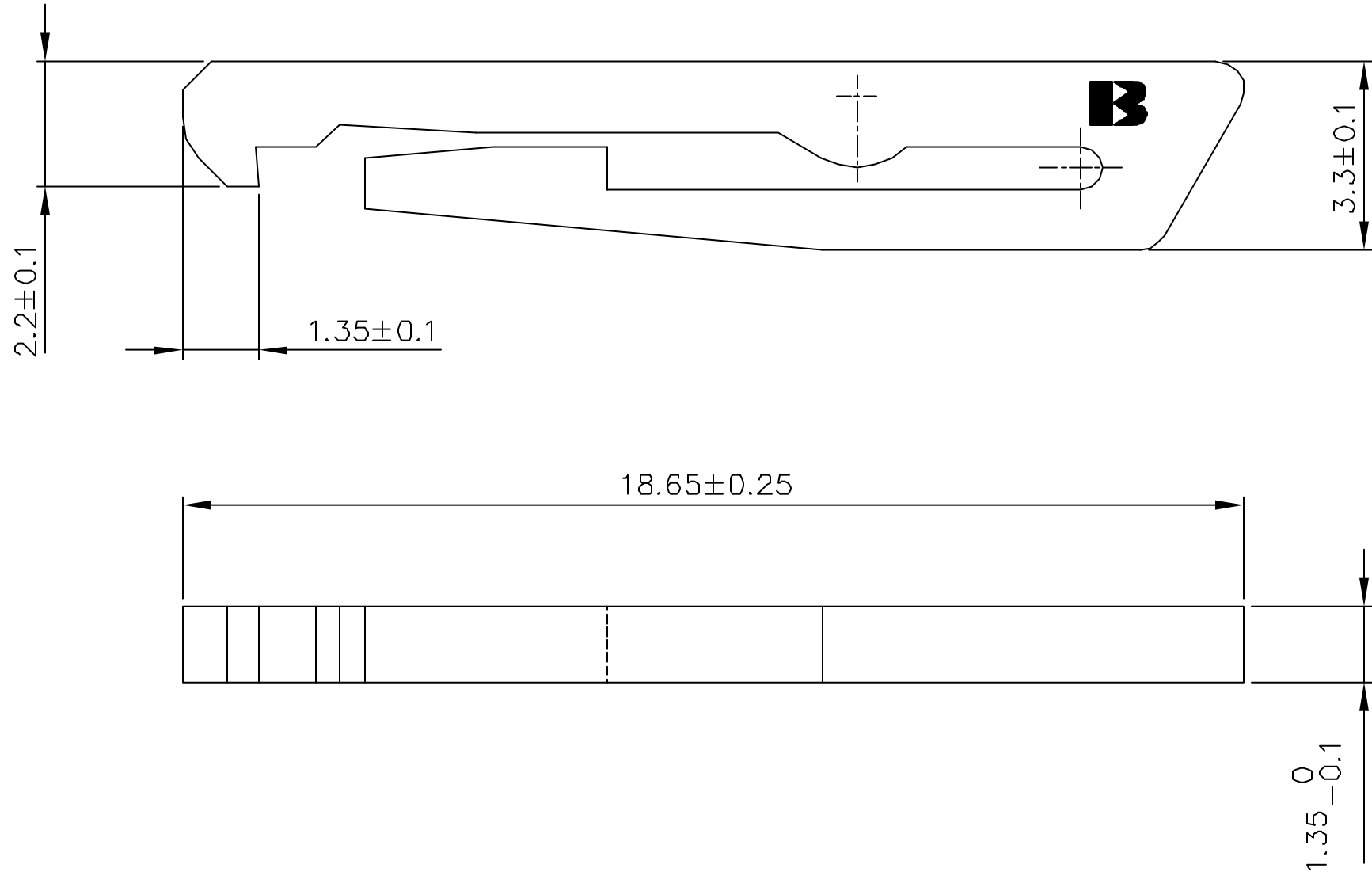
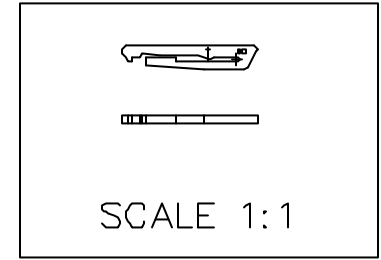

- NOTES:
1. MAT'L: THERMOPLASTIC POLYESTER 30% GLASSFILLED
UL-94-V0, COLOUR; BLEU.
 2. - RoHS COMPATIBLE PRODUCT SPECIFICATIONS
 - a - LABELING:
 - MEETS PACKAGING SPECS AS PER GS-14-920
 - b - LEGAL STATEMENT: SEE GS-22-008

THE PRODUCT IS NOT INTENDED TO BE EXPOSED TO A
MANUFACTURING SOLDER PROCESS.

| | | | | | | | | | |
|-------------|--|----------------|--|-----------------|--|---------------------------------------|--|-------------------------------------|--|
| mat'l. code | | surface | | tolerance | | projection | | product family | |
| -- | | ISO 1302 | | ISO 406 ISO 101 | | 101 | | BERGCON | |
| ltr | | ecn no | | date | | tolerances unless otherwise specified | | title | |
| A | | 7851 | | LNA 880801 | | angles | | KEY STRAIGHT FOR POL. AND LATCH. | |
| B | | V51229 | | DDB 950927 | | Linear | | mm | |
| C | | HB0467 | | LGI 980723 | | | | scale 10:1 | |
| D | | F00406 | | LLA 000522 | | dr | | D. de Bil 950927 | |
| E | | F05-0235 | | DLE 05.08.24 | | enrg | | M. Loman 950927 | |
| F | | F05-0286 | | DLE 05.11.07 | | chr | | M. Loman 950927 | |
| G | | F06-0218 | | DLE 06.07.11 | | appd | | M. Loman 950927 | |
| sheet index | | revision sheet | | | | | | FCJ | |
| | | | | | | | | dwg no 65166 sheet 1 of 1 size A3 | |
| | | | | | | | | type Product Customer Drawing | |



Copyright FCJ

X-ON Electronics

Largest Supplier of Electrical and Electronic Components

Click to view similar products for [Headers & Wire Housings](#) category:

Click to view products by [Amphenol](#) manufacturer:

Other Similar products are found below :

[892-18-020-10-001101](#) [58102-G61-06LF](#) [582553-1](#) [0009485154](#) [009176003701906](#) [0050291907](#) [LY20-4P-DT1-P1E-BR](#) [02.125.8002.8](#)
[609-3404](#) [61062-3](#) [622-0430](#) [622-3653LF](#) [63453-116](#) [636-1030](#) [636-1427](#) [636-3427](#) [636-4007](#) [641938-9](#) [641991-4](#) [644827-2](#) [65817-010LF](#)
[65817-015LF](#) [65863-015LF](#) [66207-023LF](#) [67095-007LF](#) [67601157](#) [68648-049](#) [70.362.1628.0](#) [70-4210](#) [70-4226B](#) [70-4853B](#) [707-5020](#) [707-5028](#) [71.350.2428.0](#) [71918-208LF](#) [71961-016LF](#) [733-134](#) [733-162](#) [754199-000](#) [760-3052](#) [787-8014-00](#) [79531-3000](#) [FCN-360C032-B](#) [FCN-367T-T012/H](#) [FCN-723D010/2](#) [80.063.4001.1](#) [800-90-001-10-001000](#) [800-90-010-10-002000](#) [801-43-002-10-013000](#) [801-43-006-10-002000](#)